

JAKARTA LARGE SIDEBOARD ASSEMBLY INSTRUCTIONS

Thank you for purchasing the Jakarta Large Sideboard.

Please read the instructions carefully to ensure safe operation of this product.

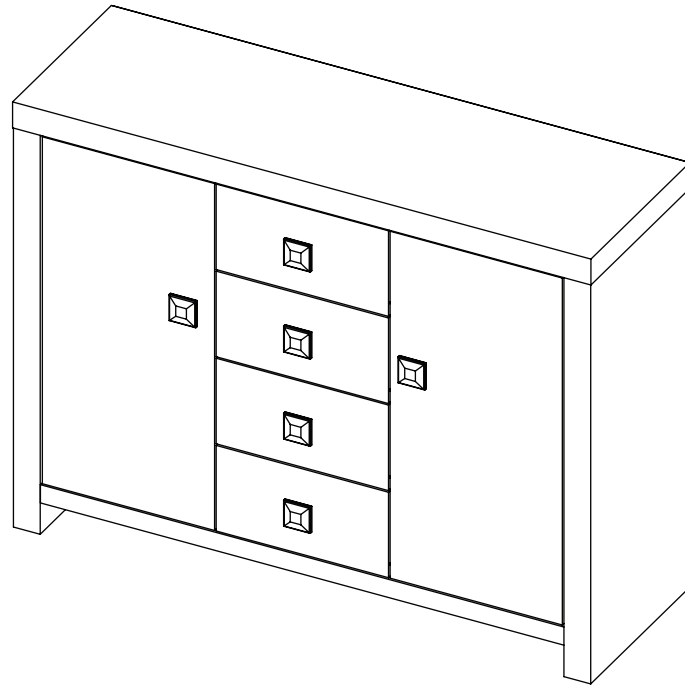

Size: 108 x 35 x 82 cm (WDH)

Colour: Mango

PLEASE READ this sheet prior to assembly to familiarise yourself with the various stages of construction.

Carefully open the pack supplied and check the contents against the parts and fittings check list. Do not destroy any of the packaging until you are certain that you have all the necessary parts for the assembly.

CAUTION: There are small components used in the construction of this unit. These loose items should be kept away from young children whilst assembling your unit to avoid the danger of choking.

Tools Required

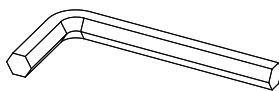
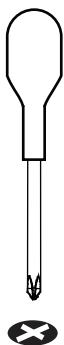
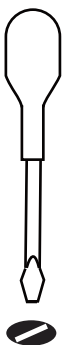

1.5 Hour
Set Up

Version 1 - 240604

PO No: _____

Page 1 of 17

JAKARTA LARGE SIDEBOARD ASSEMBLY INSTRUCTIONS

IMPORTANT - READ CAREFULLY - RETAIN THESE INSTRUCTIONS FOR FUTURE REFERENCE.

INFORMATION

- This product is designed to hold 25Kg in total. Do not exceed this weight.
- We recommend that this unit is assembled in the room intended for use.
- When you are ready to start, make sure that you have the right tools, plenty of space and a clean, dry area for assembly.
- Unwrap all packaging materials and place the components on top of the carton box or on a clean floor to prevent it from scratching.
- Check the pack and make sure you have all the parts listed.
- Ensure that this product is fully assembled as illustrated before use.
- Check all screws or bolts are tightened and inspect regularly
- Tools not included unless specified in parts list.

WARNINGS

- This product should only be used on a firm and level floor.
- Keep small parts out of reach of children.
- Make sure the legs/base remain in contact with the floor.
- DO NOT use power tools to construct this product.
- DO NOT tighten screws until parts are assembled or as advised in this guide.
- DO NOT over tighten screws or bolts.
- DO NOT use this product if parts are missing, damaged or worn.
- DO NOT sit or stand on the product.

CARE INFORMATION

- To clean, wipe with a damp clean cloth.
- Never use scourers, abrasives or chemical cleaners.
- Do not use solvent based cleaners or detergents as they can bleach or damage the product.

Parts and Fittings Checklist

Please check the pack contents before assembling the product. If any components are missing, please contact your retailer. The fittings pack contains small items that should be kept away from children.

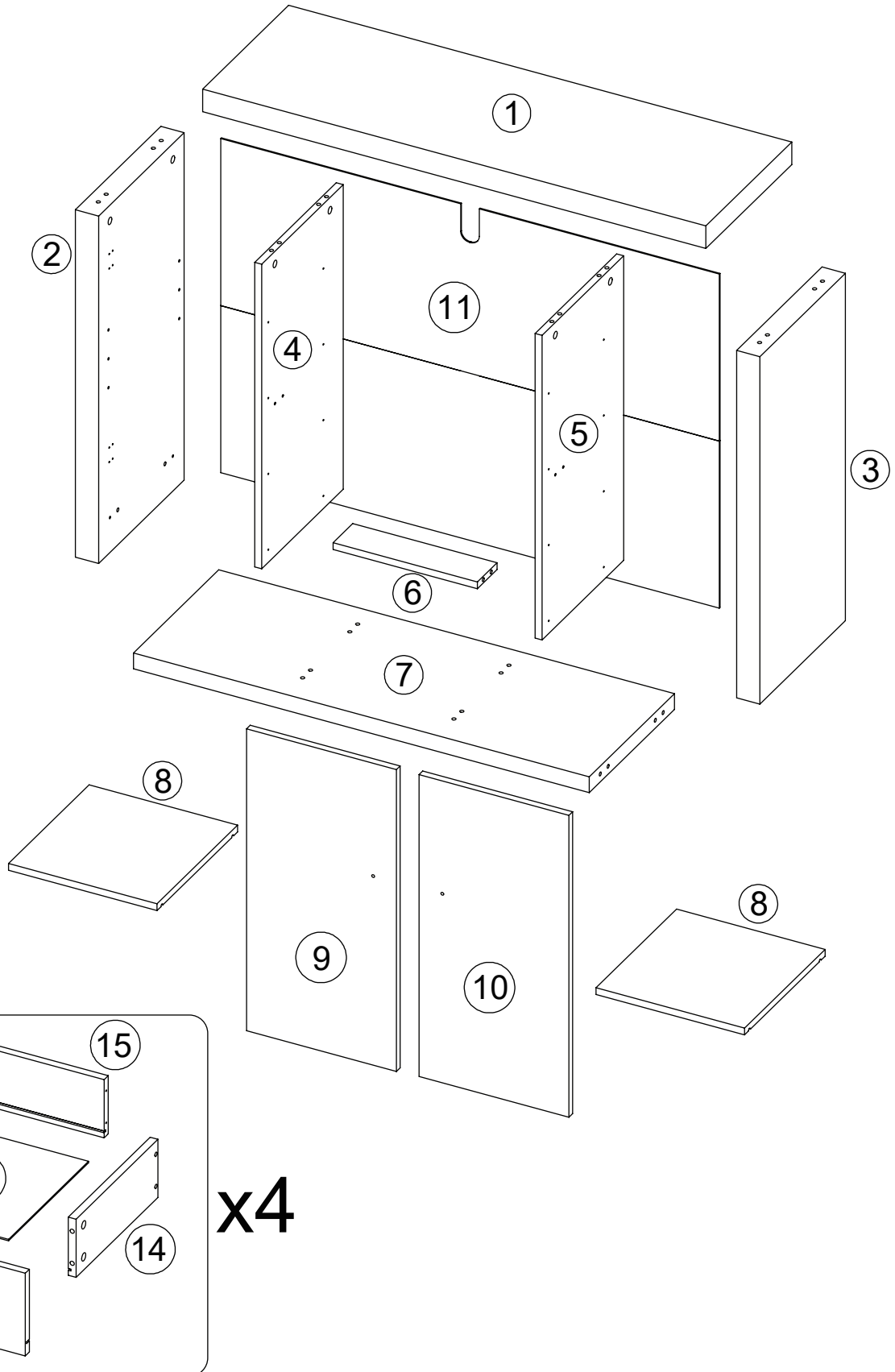

JAKARTA LARGE SIDEBOARD ASSEMBLY INSTRUCTIONS

Parts are packed in one carton

1	2	3
Description: Top Panel Qty: 1 Size: 1080 x 350 x 50 mm Carton No: 1/1	Description: LH Side Panel Qty: 1 Size: 770 x 348 x 50 mm Carton No: 1/1	Description: RH Side Panel Qty: 1 Size: 770 x 348 x 50 mm Carton No: 1/1
4	5	6
Description: LH Upright Qty: 1 Size: 675 x 332 x 15 mm Carton No: 1/1	Description: RH Upright Qty: 1 Size: 675 x 332 x 15 mm Carton No: 1/1	Description: Front Rail Qty: 1 Size: 310 x 80 x 15 mm Carton No: 1/1
7	8	9
Description: Base Panel Qty: 1 Size: 979 x 347 x 35 mm Carton No: 1/1	Description: Adjustable Shelf Qty: 2 Size: 328 x 319 x 15 mm Carton No: 1/1	Description: LH Door Qty: 1 Size: 669 x 322 x 15 mm Carton No: 1/1
10	11	12
Description: RH Door Qty: 1 Size: 669 x 322 x 15 mm Carton No: 1/1	Description: Back Panel Qty: 1 Size: 1071 x 740 x 3 mm Carton No: 1/1	Description: Drawer Front Qty: 4 Size: 322 x 165 x 15 mm Carton No: 1/1
13	14	15
Description: LH Drawer Side Qty: 4 Size: 350 x 116 x 15 mm Carton No: 1/1	Description: RH Drawer Side Qty: 4 Size: 350 x 116 x 15 mm Carton No: 1/1	Description: Drawer End Qty: 4 Size: 255 x 116 x 15 mm Carton No: 1/1
16		
Description: Drawer Base Qty: 4 Size: 293 x 263 x 3 mm Carton No: 1/1		

JAKARTA LARGE SIDEBOARD ASSEMBLY INSTRUCTIONS

Fittings (to scale)

Code	Item	Quantity
A	Cam Bolt (38mm overall)	32
B	Cam Lock	32
C	Dowel (8x30mm)	16
D	Nail for Fitting Back Panel (2x12mm)	32
E	Screw for Fitting Runner Anti-tilt Strap and Back Panel (3x12mm)	49
F	Screw for Fitting Handle (3.5x35mm)	6
G	Screw for Drawer Parts (3.5x40mm)	16
H	Carcass Screw for Fitting Divider Panels to the Base (7 x 60mm)	4
S	Shelf Support	8

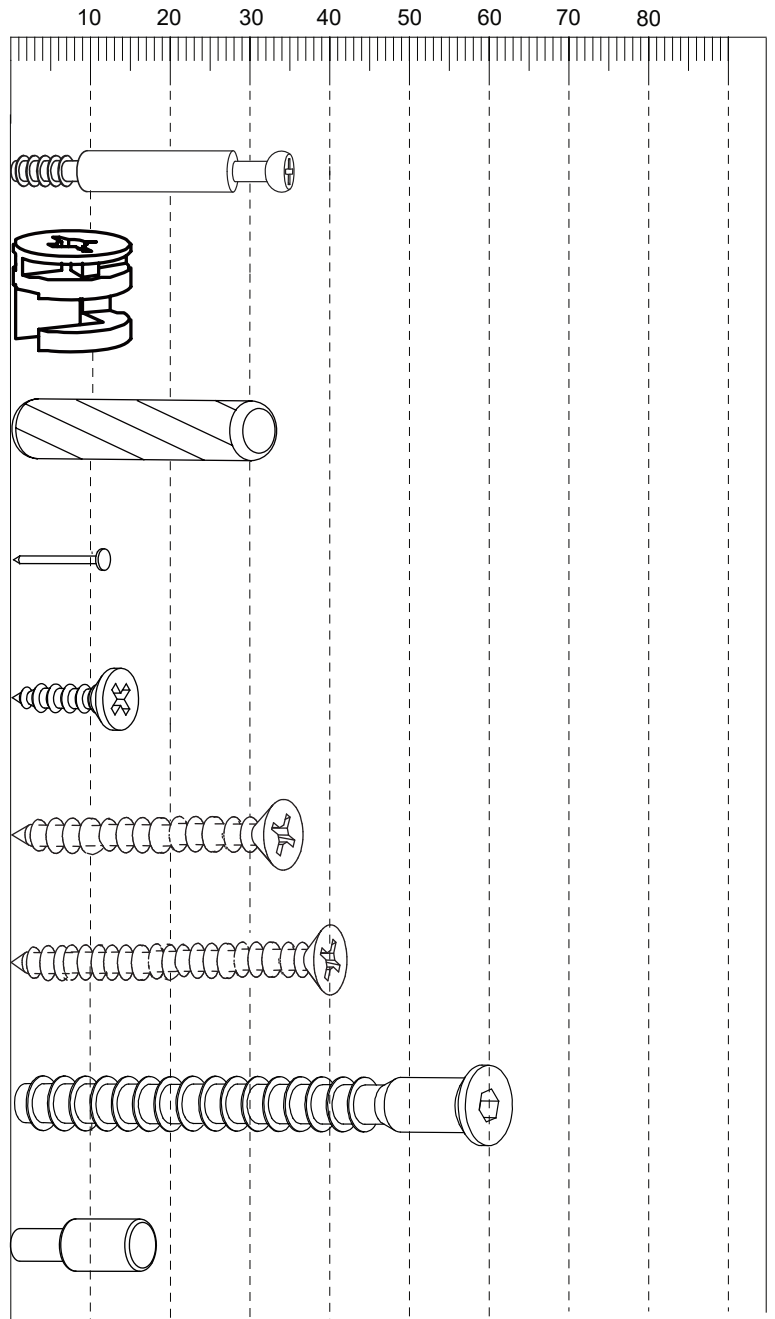

Fittings (not to scale)

Code	Item	Quantity
J	Anti-tilt Strap	1
K	Cam Lock Cover	28
L	Knob	6
M	Allen Key (4mm)	1

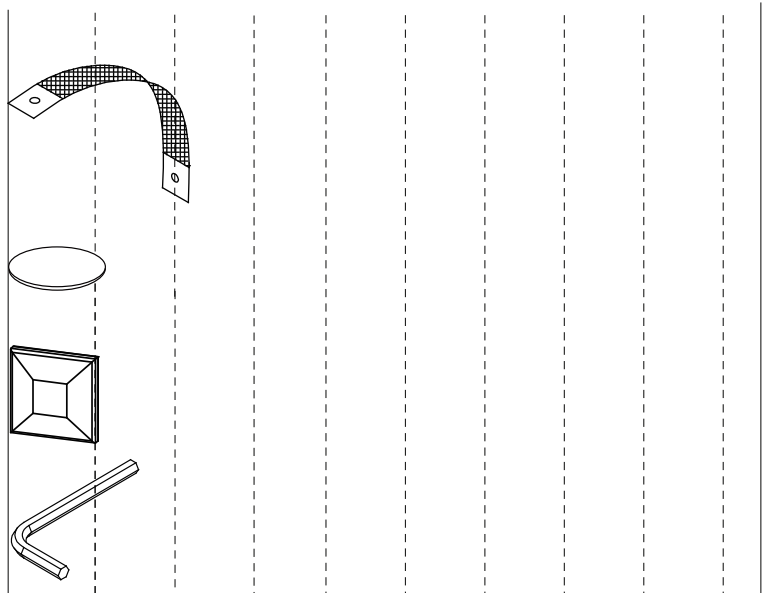

JAKARTA LARGE SIDEBOARD ASSEMBLY INSTRUCTIONS

Fittings (not to scale)

Code	Item	Quantity
N	Outer Drawer Runner - Right	4
P	Outer Drawer Runner - Left	4
Q	Inner Drawer Runner - Right	4
R	Inner Drawer Runner - Left	4

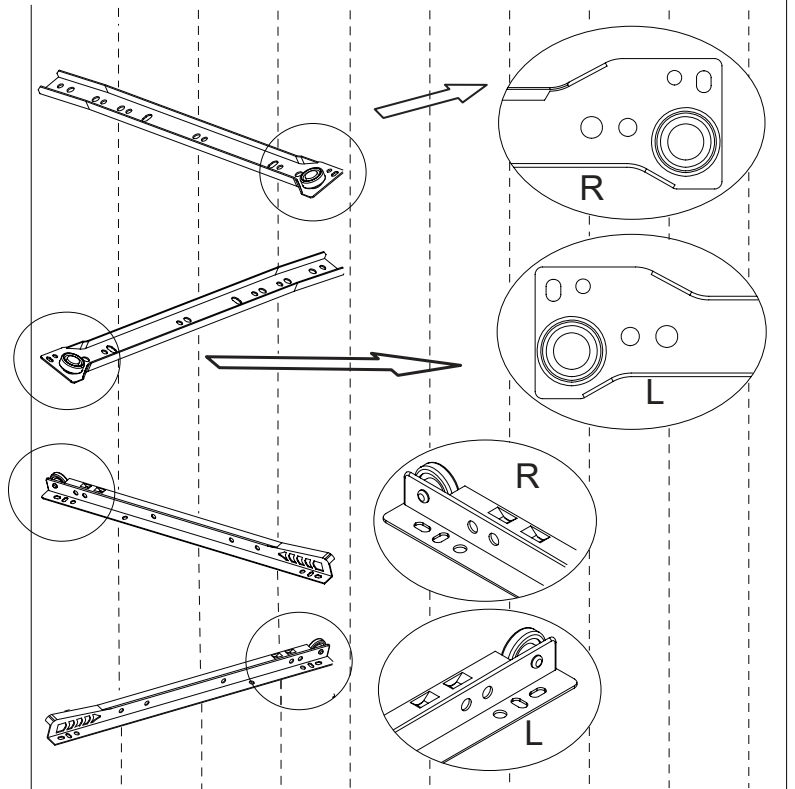

Fittings (hinge and screw is packed together)

Code	Item	Quantity
T	Screw for Fitting Hinge (4x14mm)	24
U	Hinge Set	4

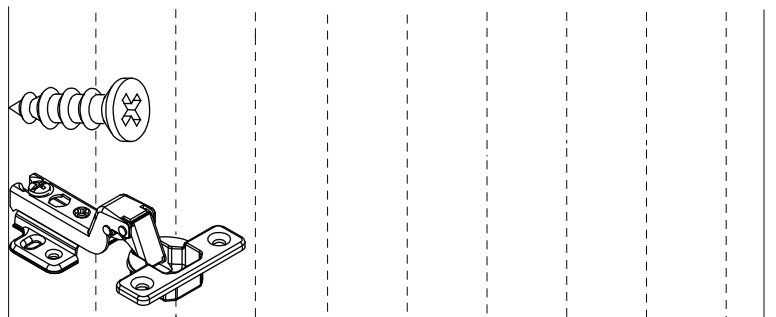

General Hints & Tips

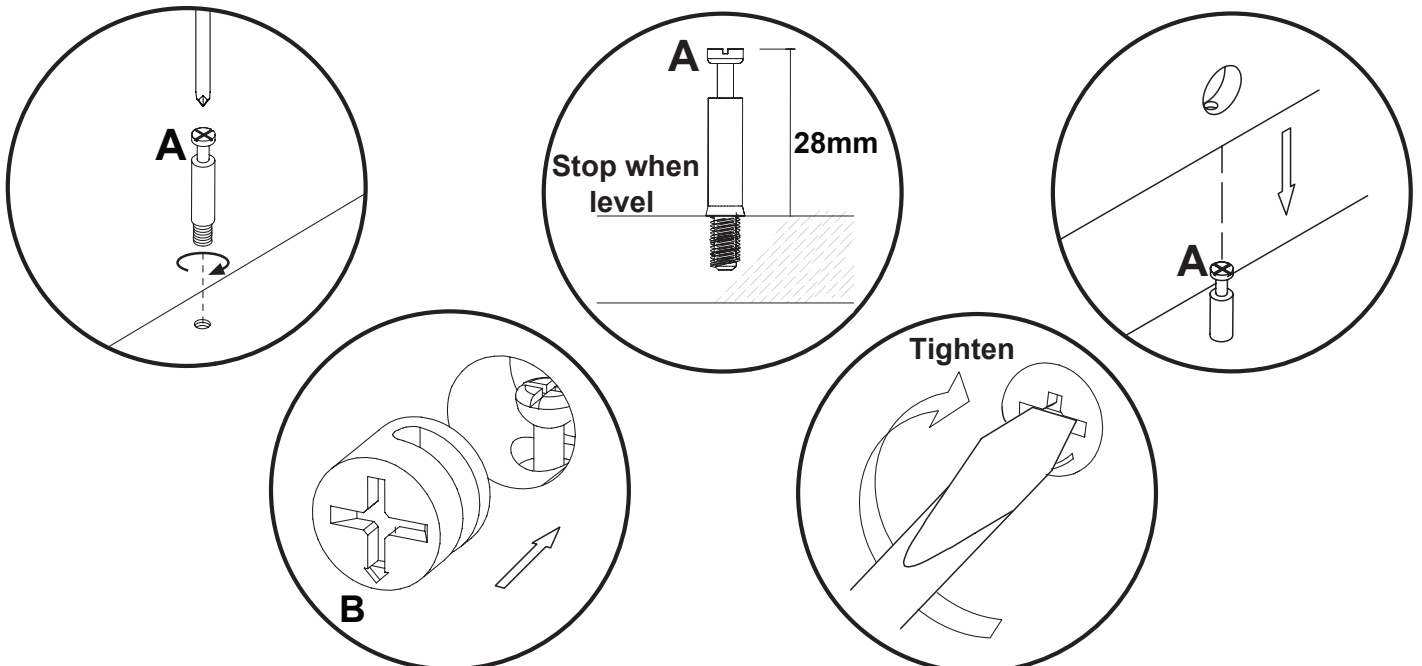

JAKARTA LARGE SIDEBOARD ASSEMBLY INSTRUCTIONS

STEP 1

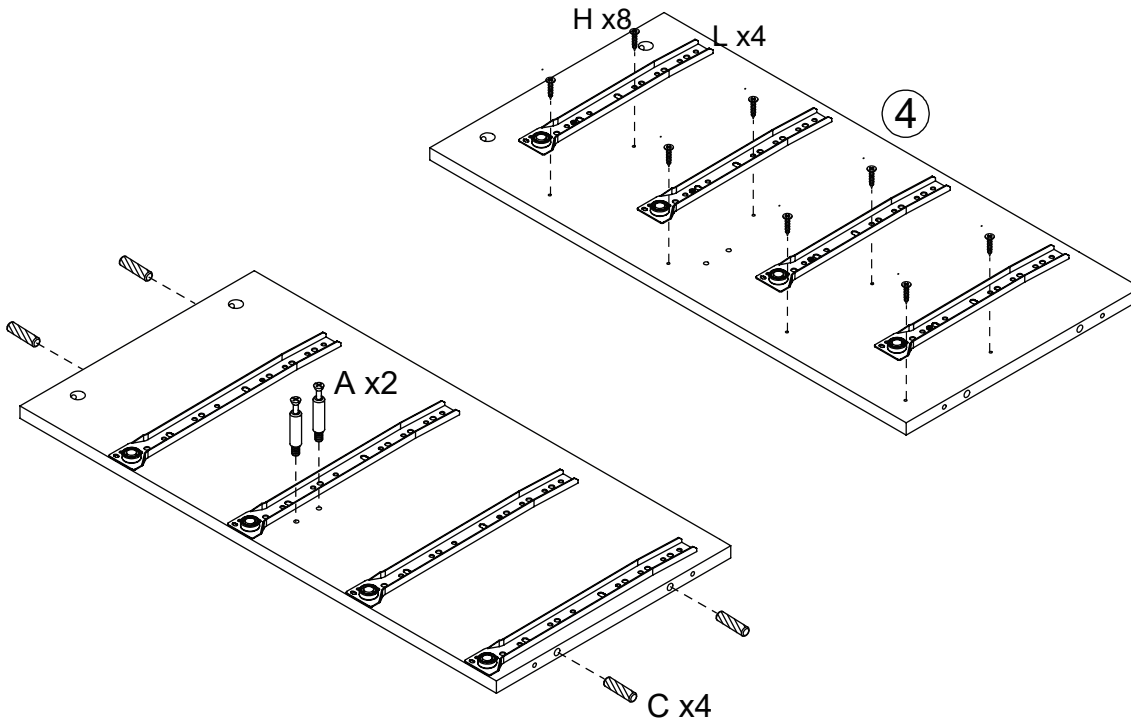

For this step:

Tools required



Fittings required

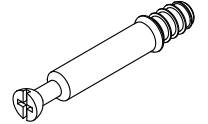

A x2

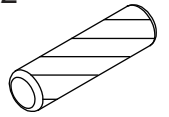

C x4

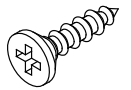

E x8

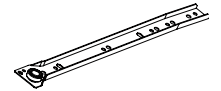

L x4

STEP 2

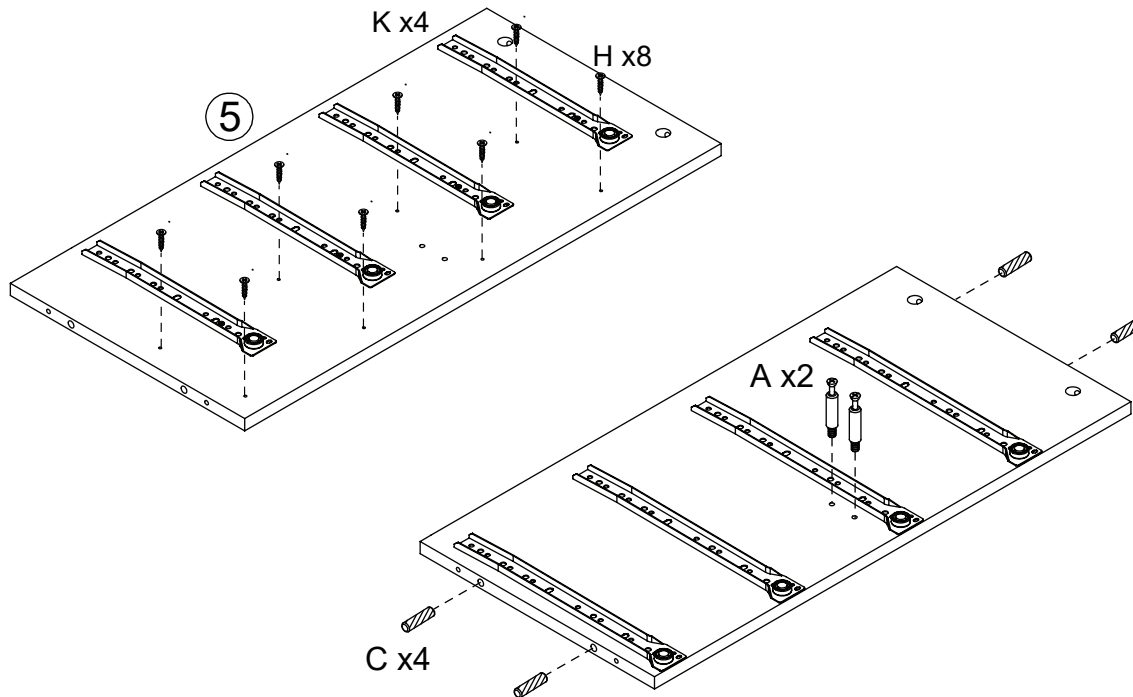

For this step:

Tools required

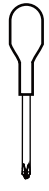

Fittings required

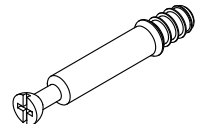

A x2

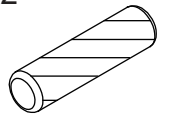

C x4

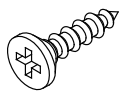

E x8



K x4

JAKARTA LARGE SIDEBORD ASSEMBLY INSTRUCTIONS

STEP 3

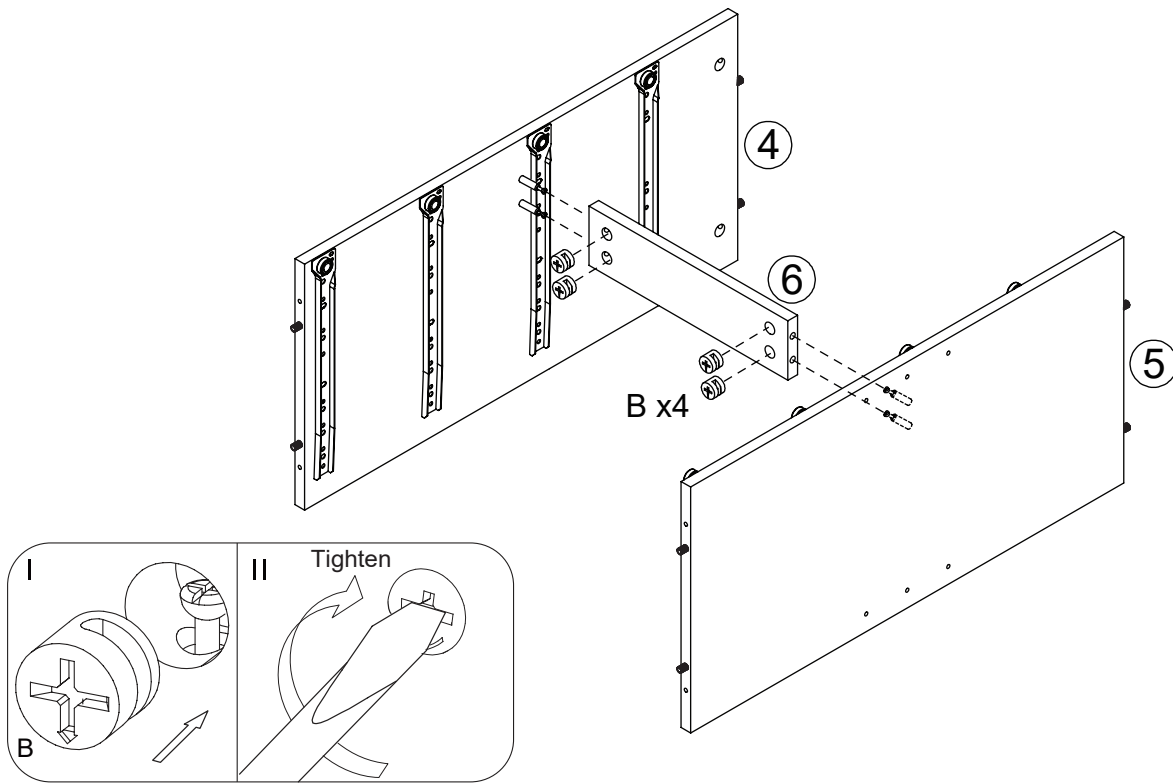

For this step:

Tools required

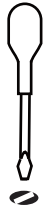

Fittings required



B x4

STEP 4

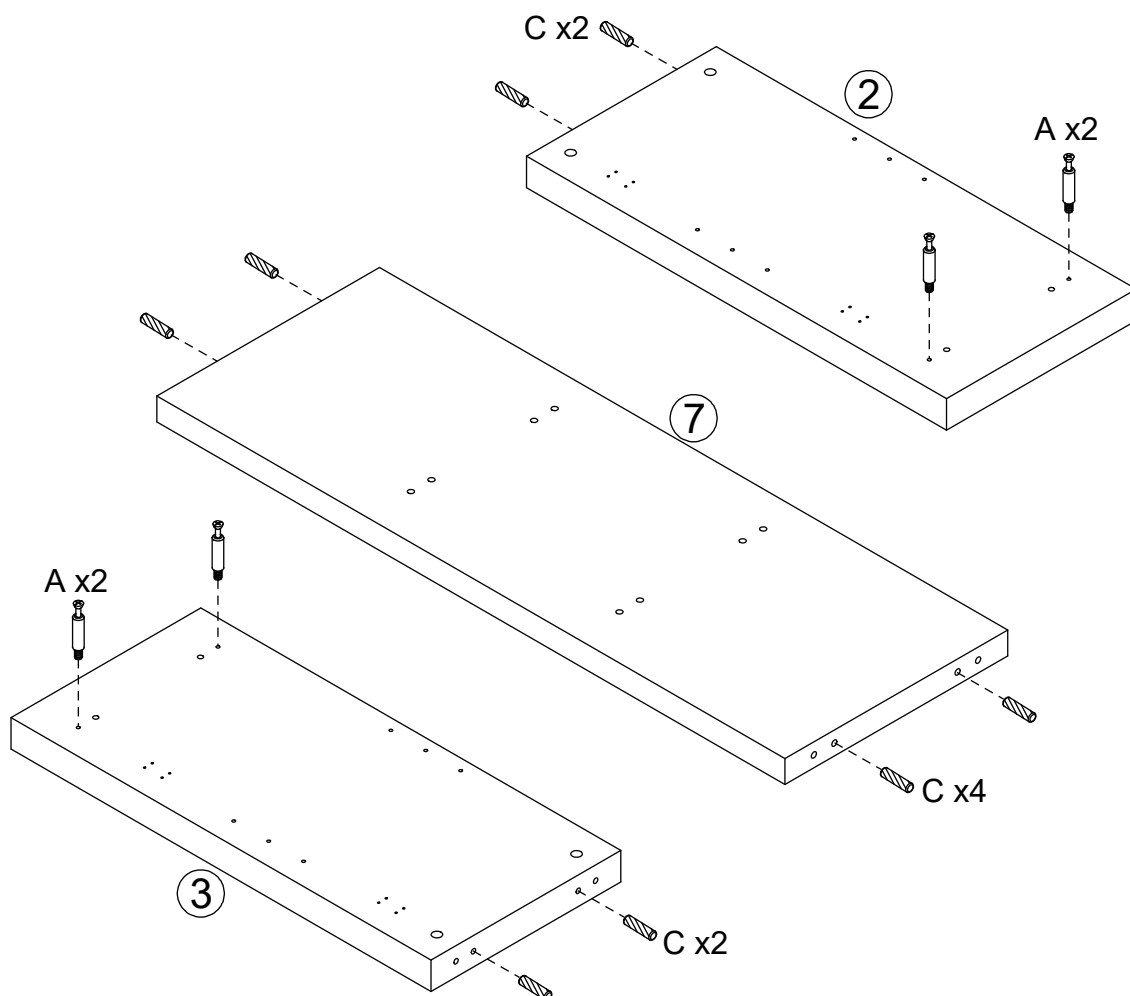

For this step:

Tools required

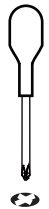

Fittings required

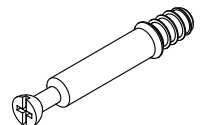

A x4

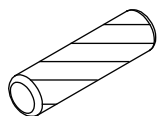

C x8

JAKARTA LARGE SIDEBOARD ASSEMBLY INSTRUCTIONS

STEP 5

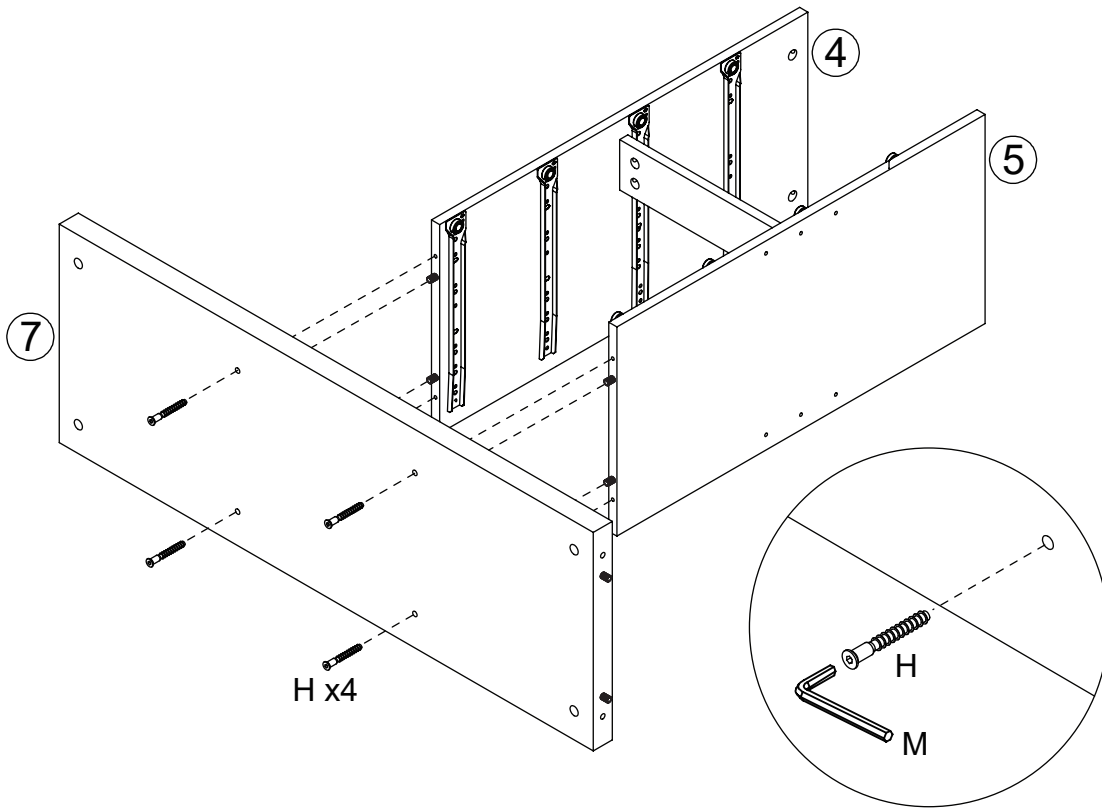

For this step:
Tools required

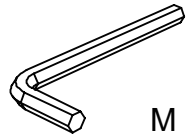

Fittings required

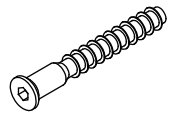

H x4

STEP 6

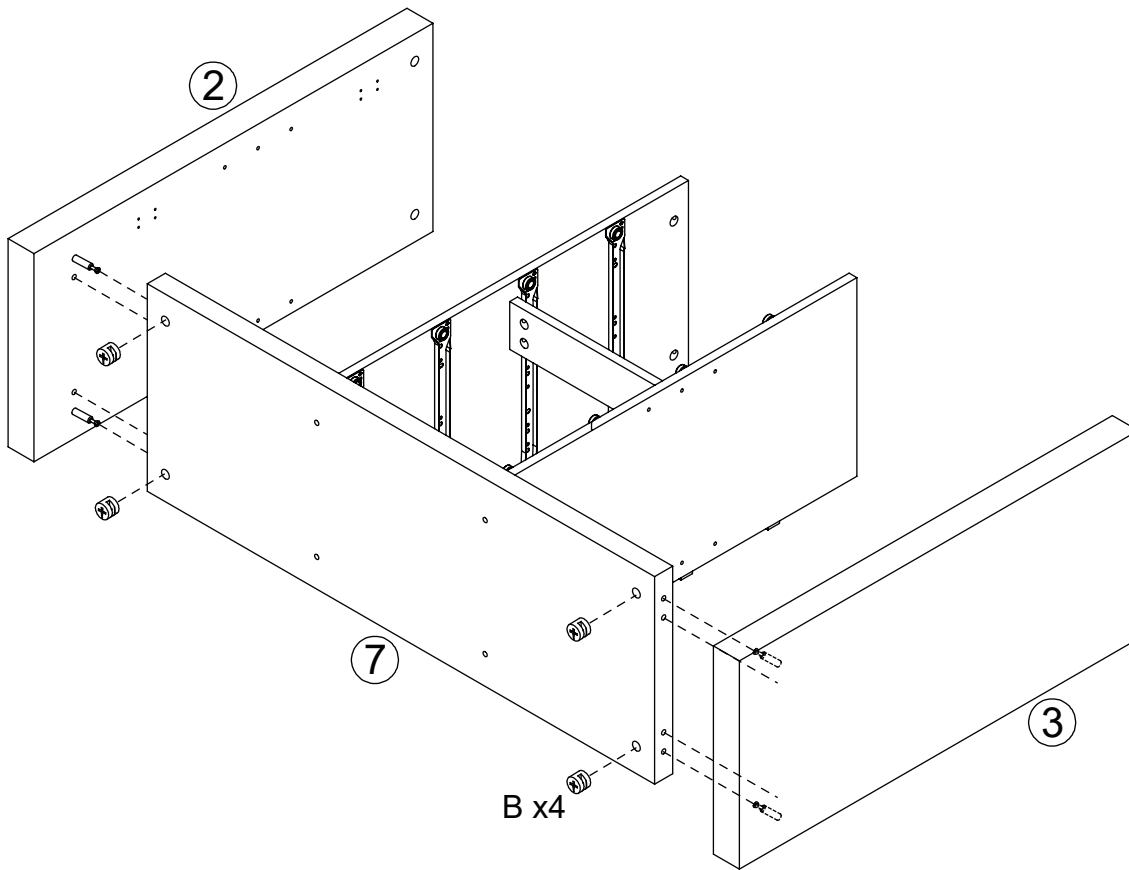

For this step:
Tools required



Fittings required



B x4

STEP 7

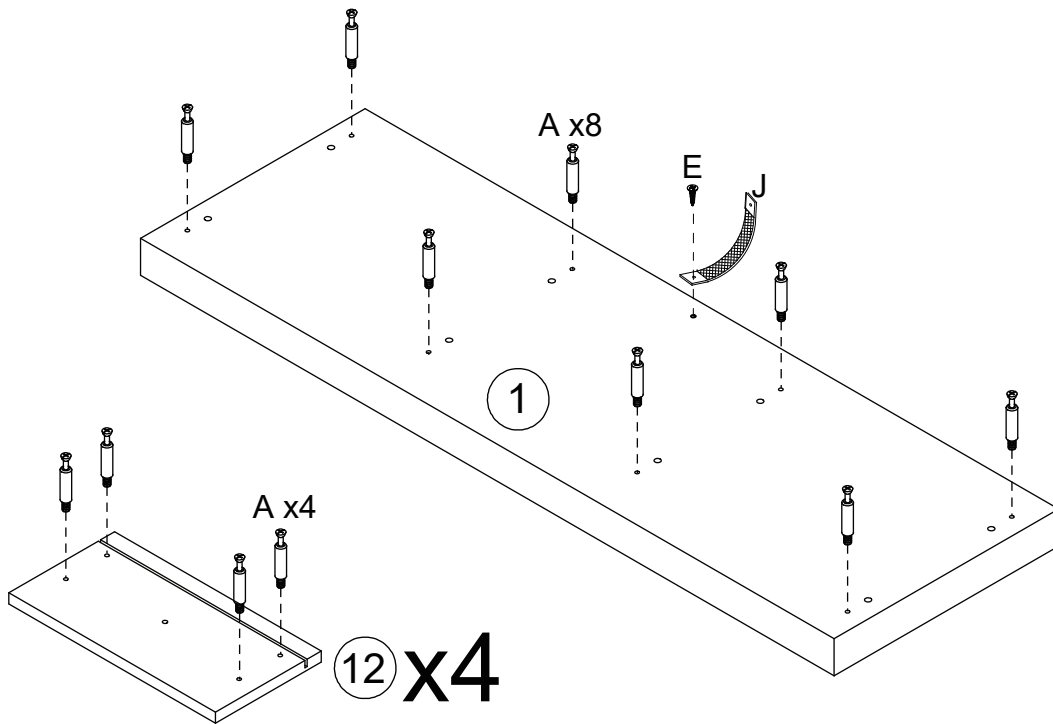

For this step:

Tools required

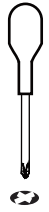

Fittings required

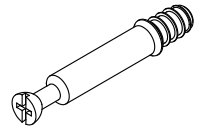

A x24

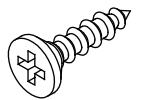

E x1

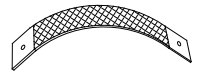

J x1

STEP 8

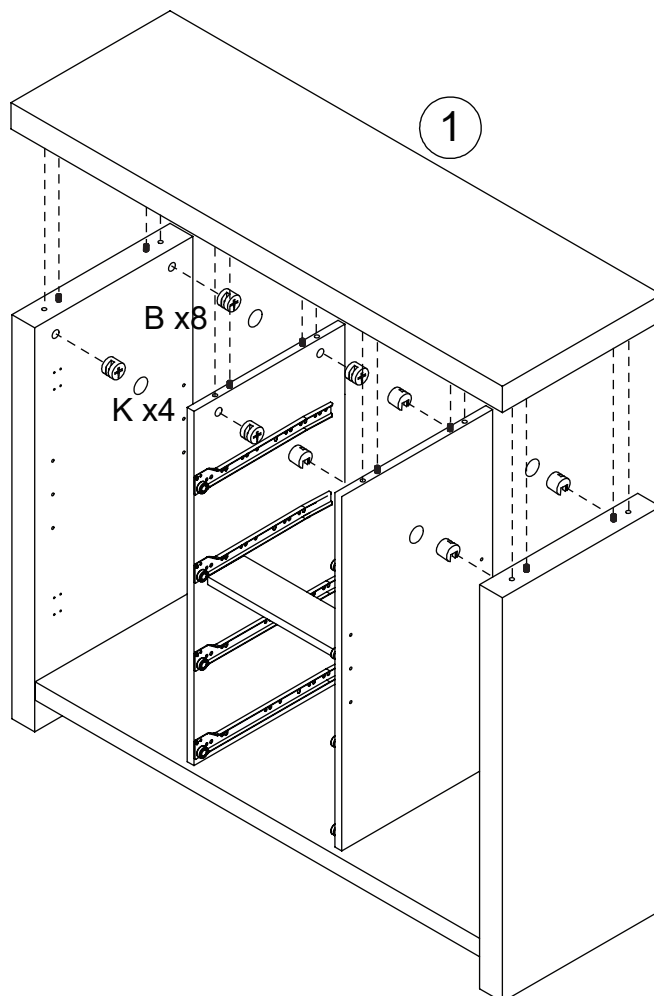

For this step:

Tools required

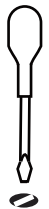

Fittings required



B x8



K x4

JAKARTA LARGE SIDEBORD ASSEMBLY INSTRUCTIONS

STEP 9

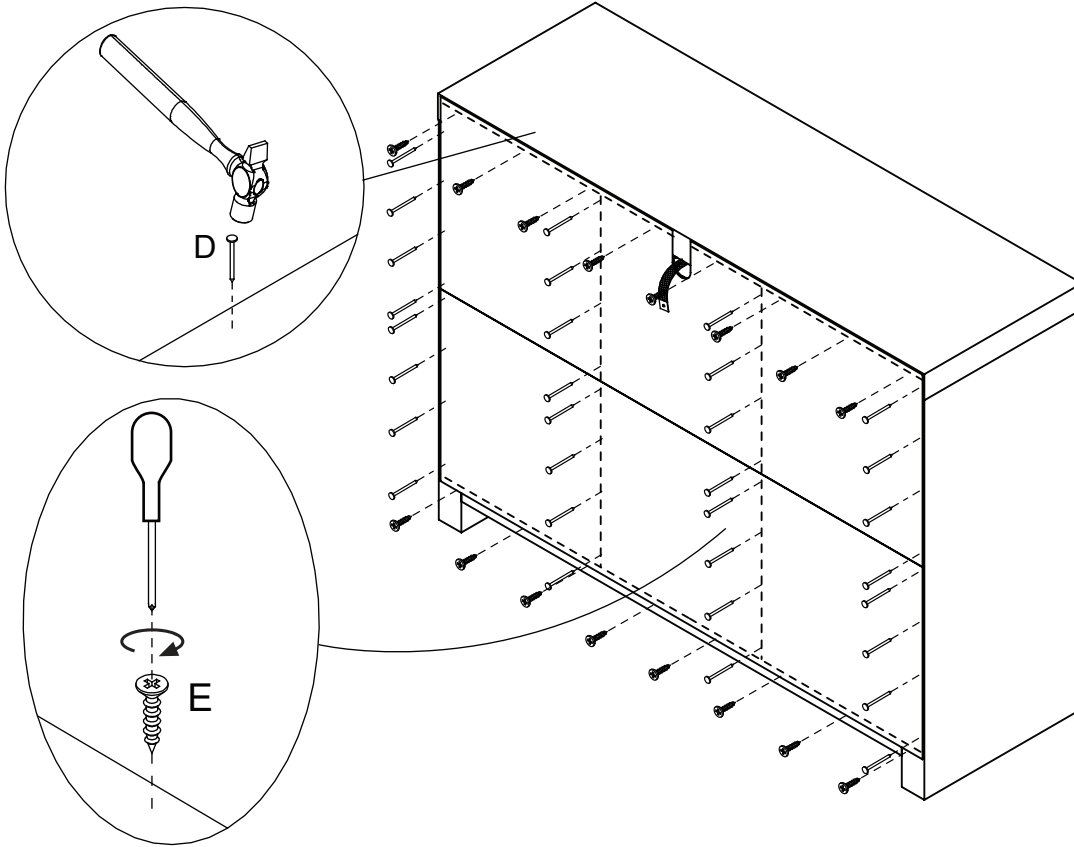

For this step:
Tools required

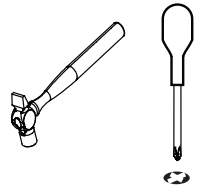

Fittings required

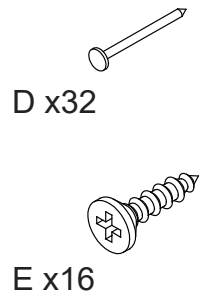

STEP 10

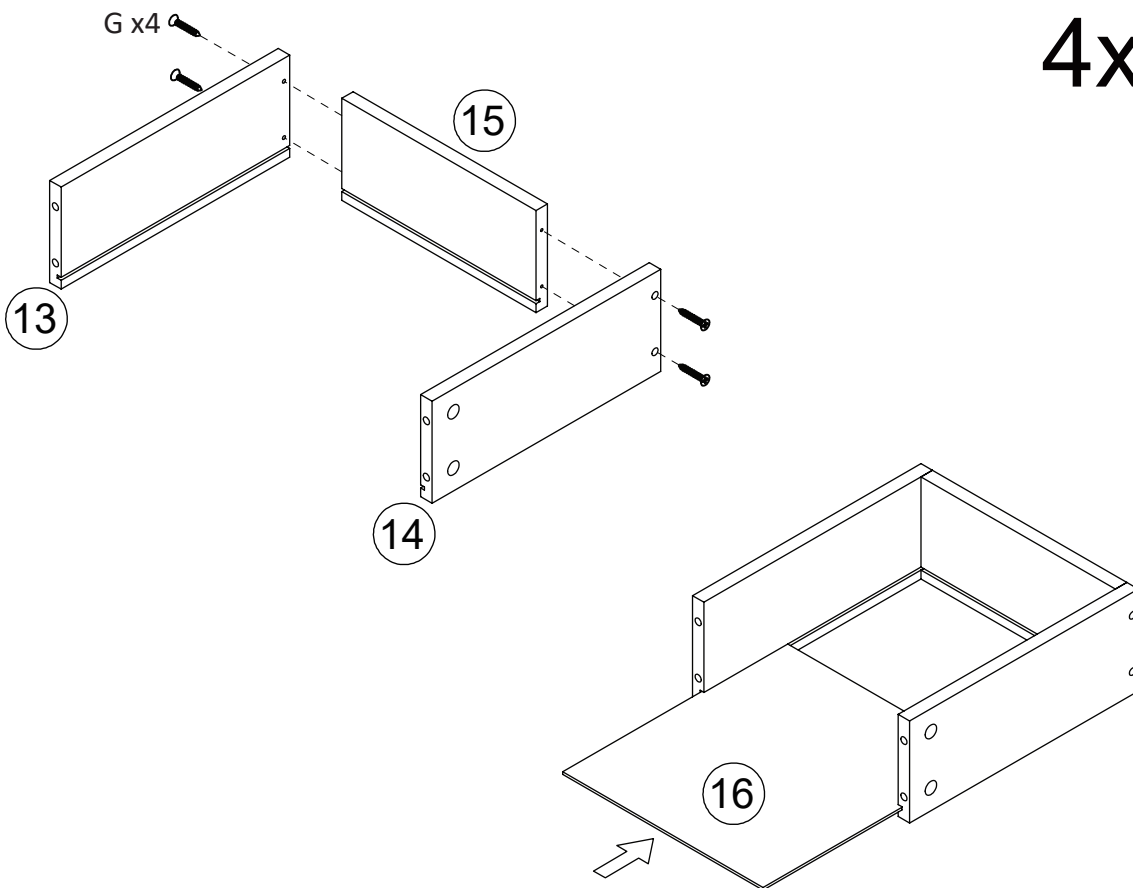

For this step:
Tools required

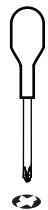

Fittings required

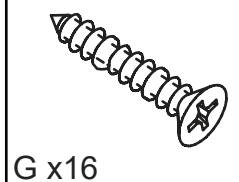

STEP 11

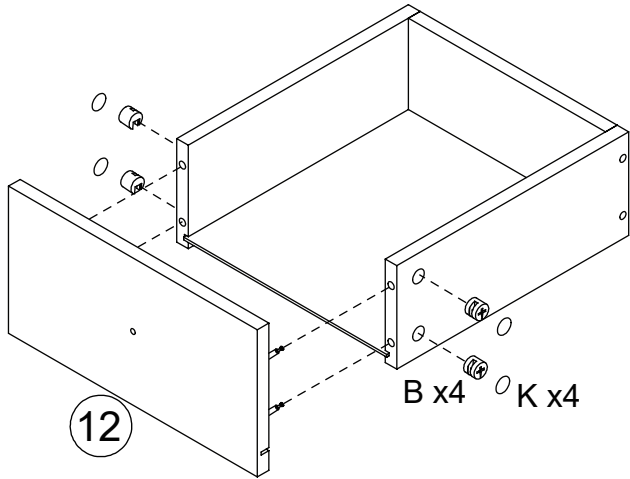

4x

For this step:

Tools required

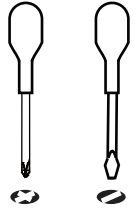

Fittings required



B x 16



K x 16

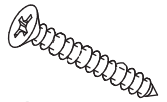

F x 4

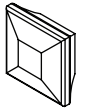

L x 4

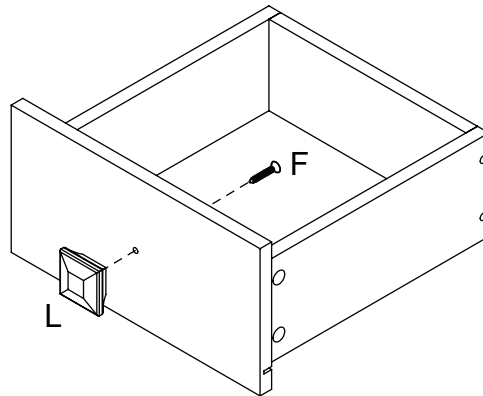

STEP 12

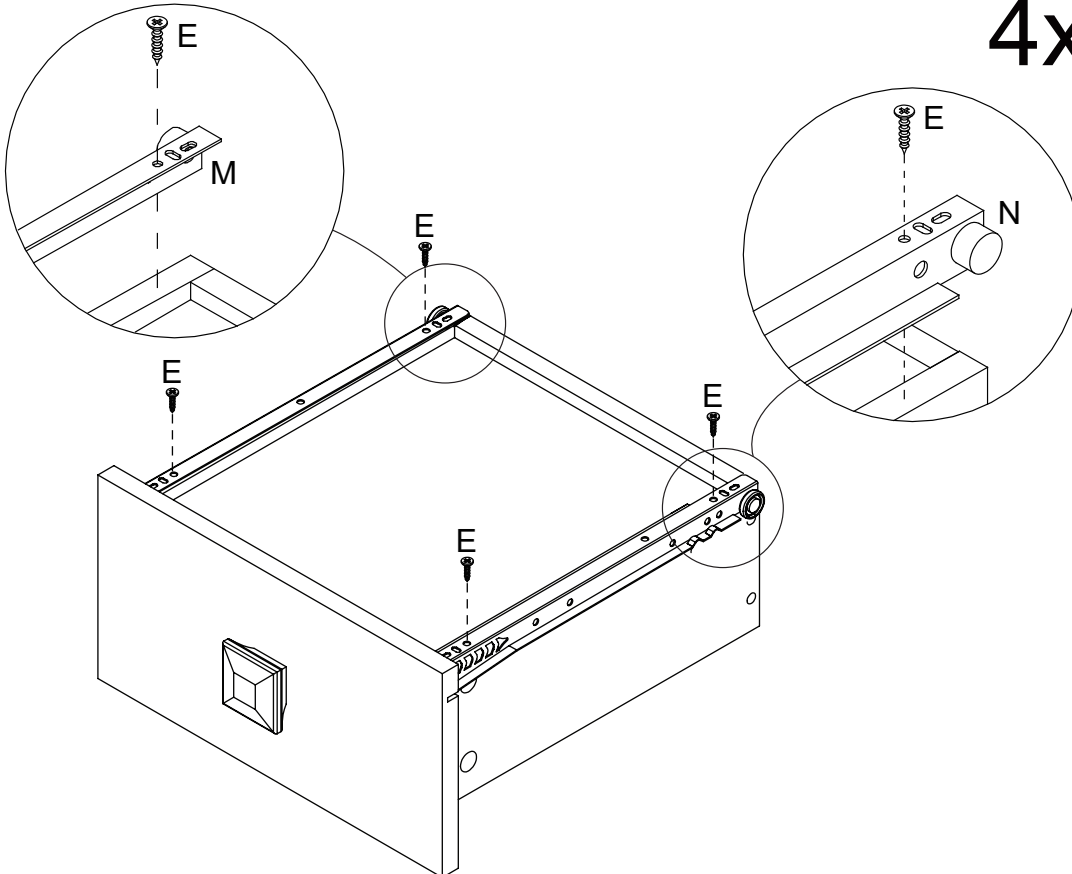

4x

For this step:

Tools required

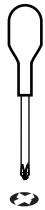

Fittings required

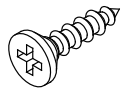

E x 16

M x 4

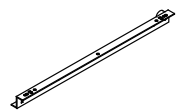

N x 4

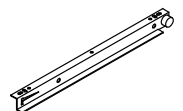

JAKARTA LARGE SIDEBORD ASSEMBLY INSTRUCTIONS

STEP 13

For this step:
Tools required

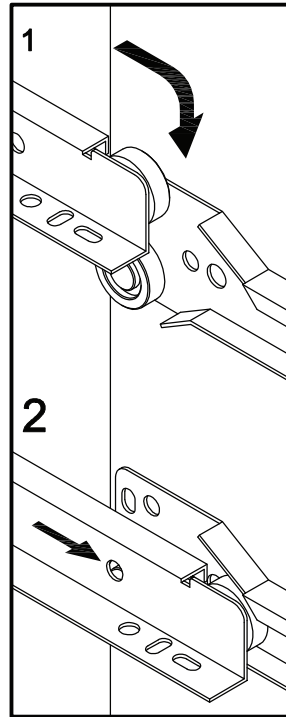
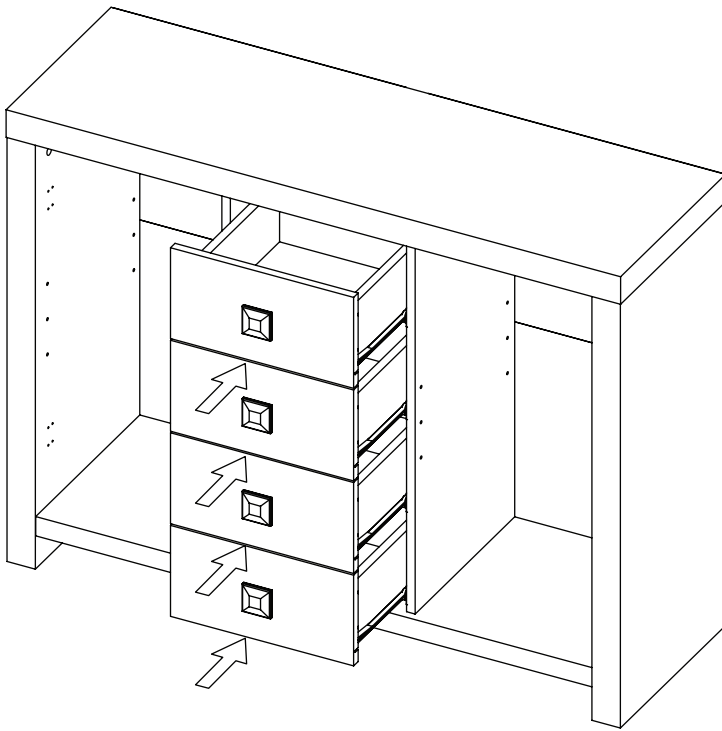

Fittings required

STEP 14

For this step:
Tools required

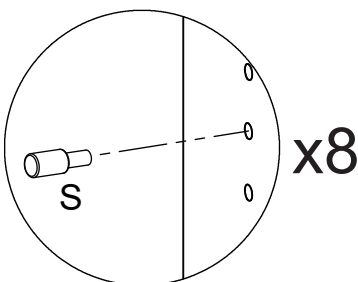
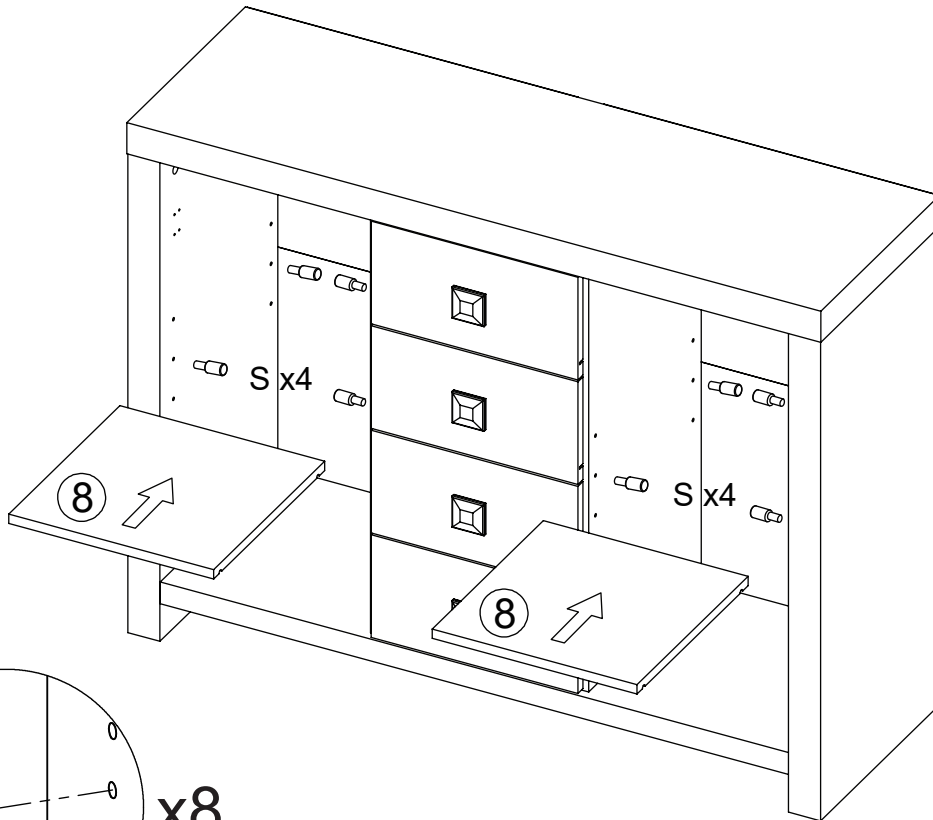

Fittings required

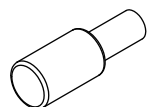

S x 8

JAKARTA LARGE SIDEBORD ASSEMBLY INSTRUCTIONS

STEP 15

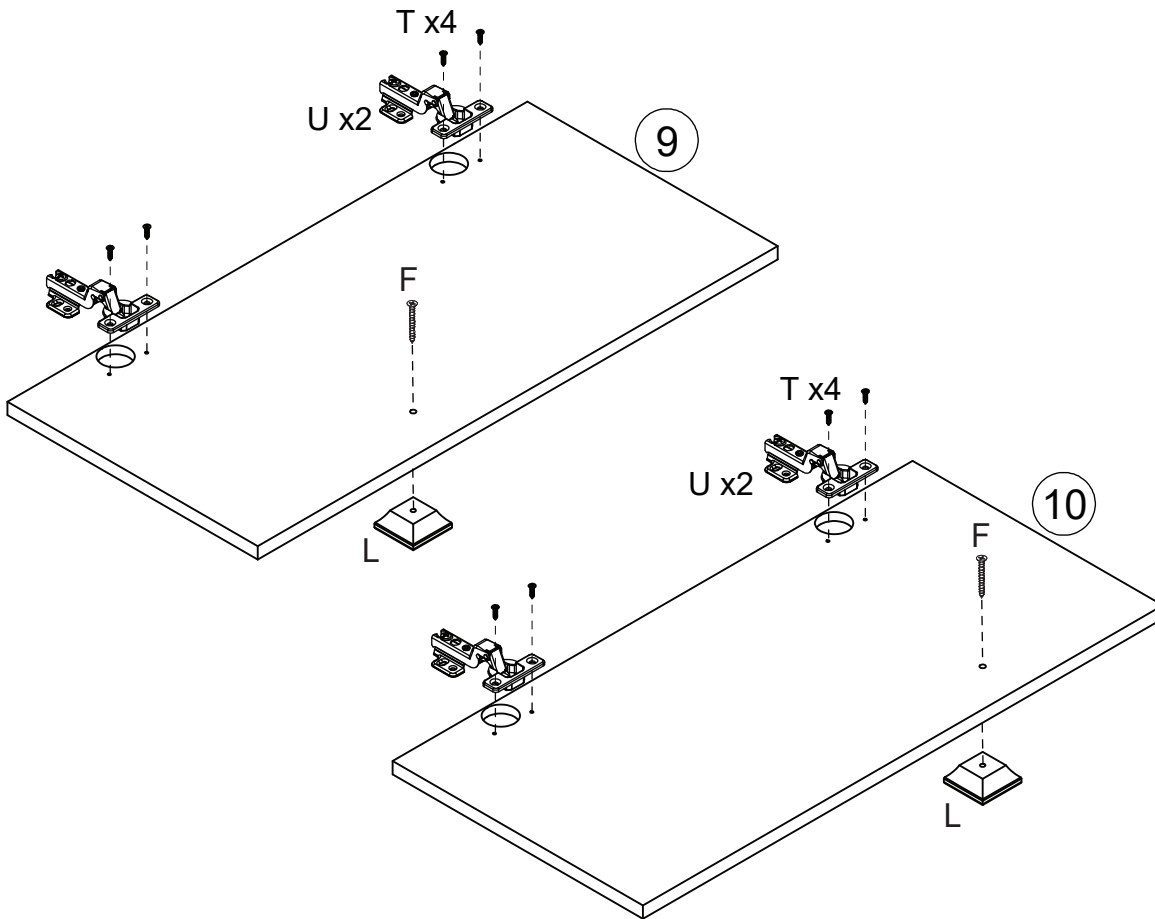

For this step:

Tools required

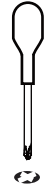

Fittings required

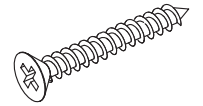

F x 2

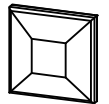

L x 2

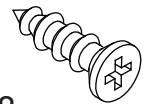

T x 8

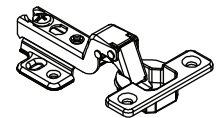

U x 4

STEP 16

Initially in each door fix 4 screws (T) through the centre of the elongated holes in each hinge plate, screwing into the side panel.

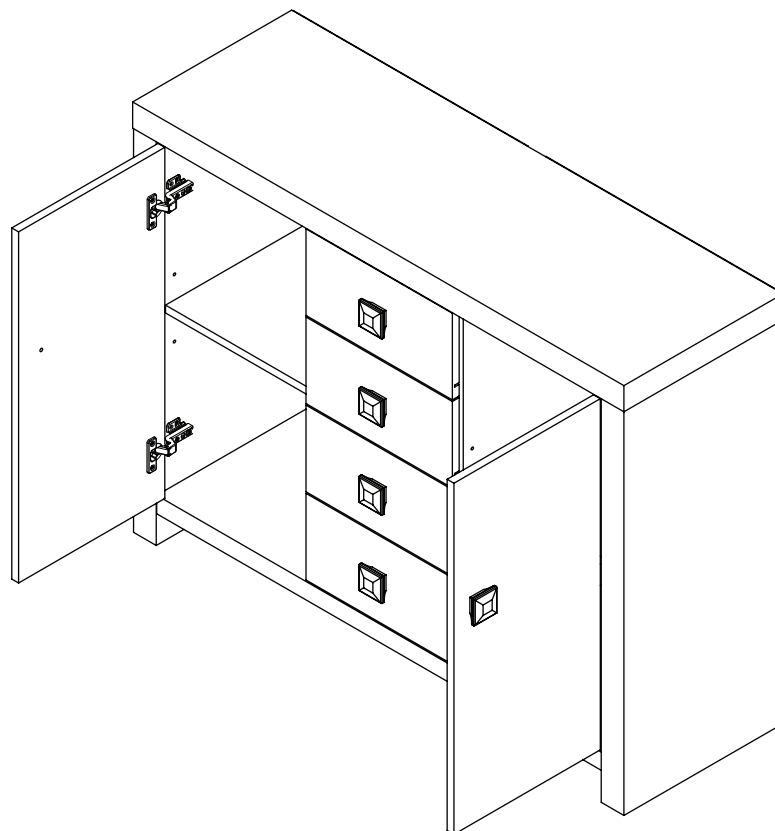
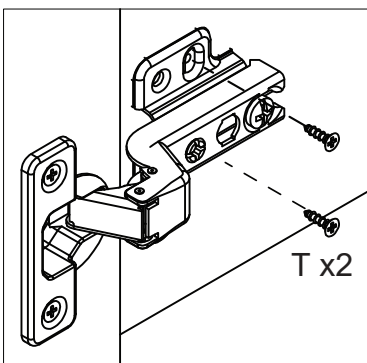

For this step:

Tools required



Fittings required

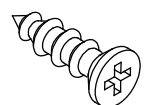

T x 8

STEP 17

For this step:
Tools required

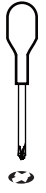

If it is necessary to re-align the door vertically, loosen the screws (X) and adjust the hinge plates up or down (Y) until gaps at top and bottom of the door are even, then re-tighten the screws.

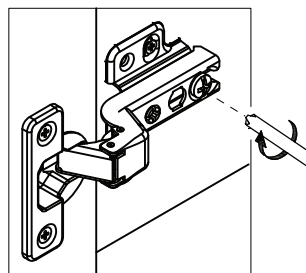
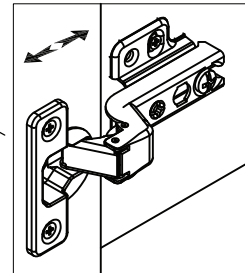
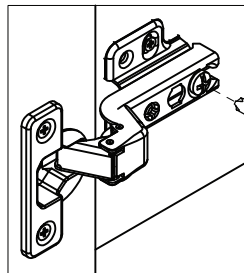
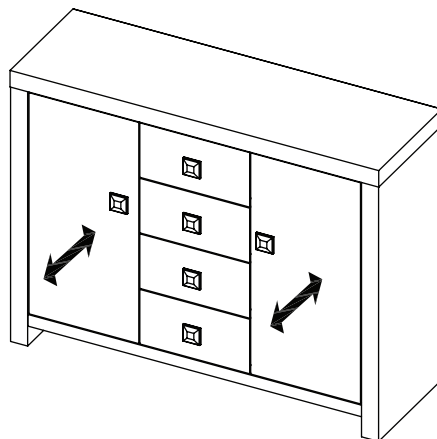
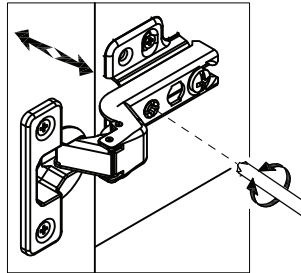
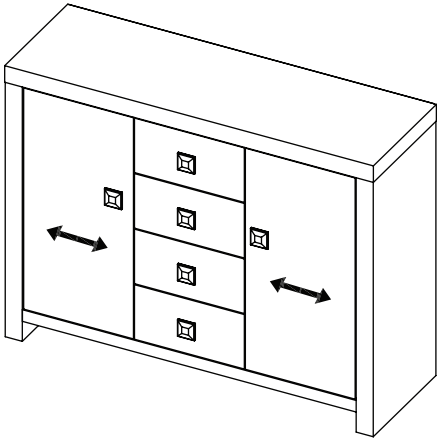
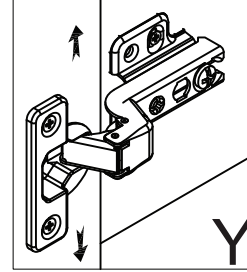
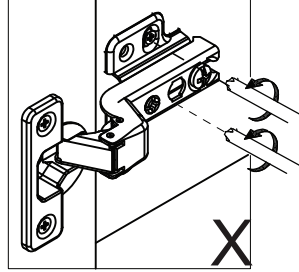
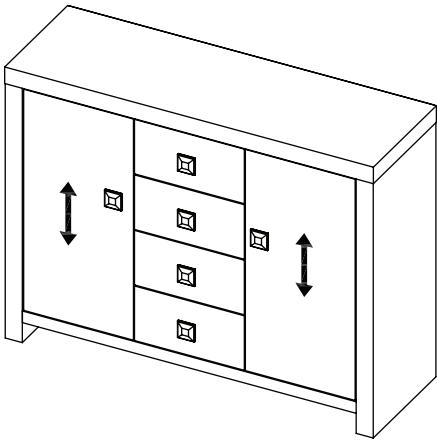

Fittings required

JAKARTA LARGE SIDEBORD ASSEMBLY INSTRUCTIONS

STEP 18

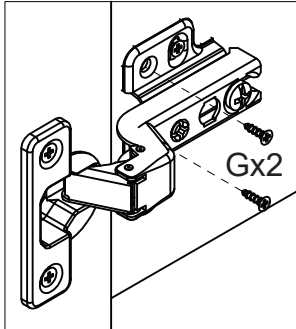

Once all the adjustments are complete and both doors are aligned, fix remaining x8 screws (G) into the other hinge plate holes then check all the other hinge screws are tight.
Please do not over-tighten.

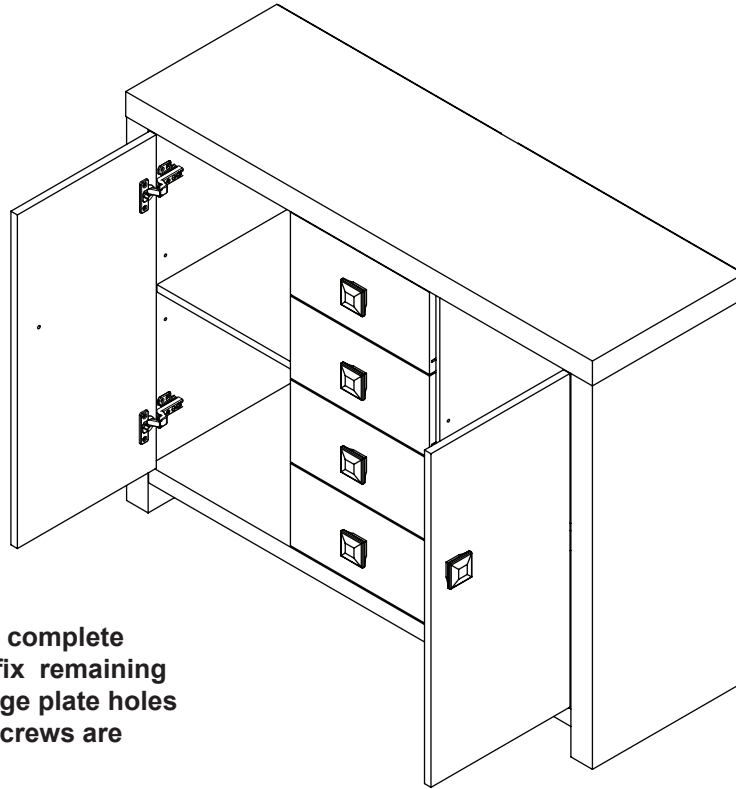

For this step:

Tools required



Fittings required

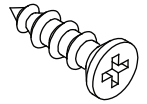

T x8

STEP 19

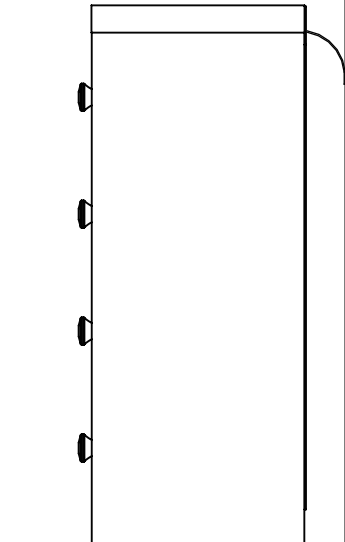
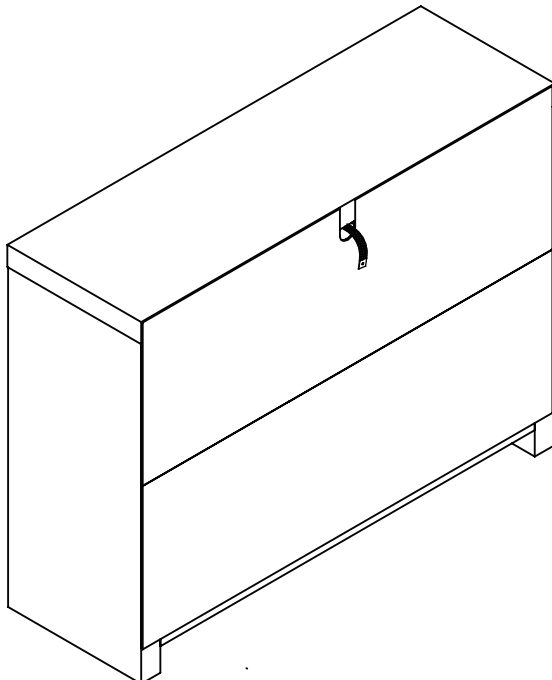

Note: We recommend the use of the wall strap provided (J) to avoid accidents and possible fatal injuries if the item falls over or tips over during use.

Warning: Always ensure the wall area to be drilled is free of electrical wires, water and gas pipes. We don't supply wall fixings as these must suit the wall type of your own home. If in doubt please consult a qualified trades person.

For this step:

Tools required

Fittings required

Assembly Completed

Your Jakarta Large Sideboard is now completely assembled.

Periodically check to ensure that the components are in their proper position, free from damage. Also, make sure the connectors are tight and secure.

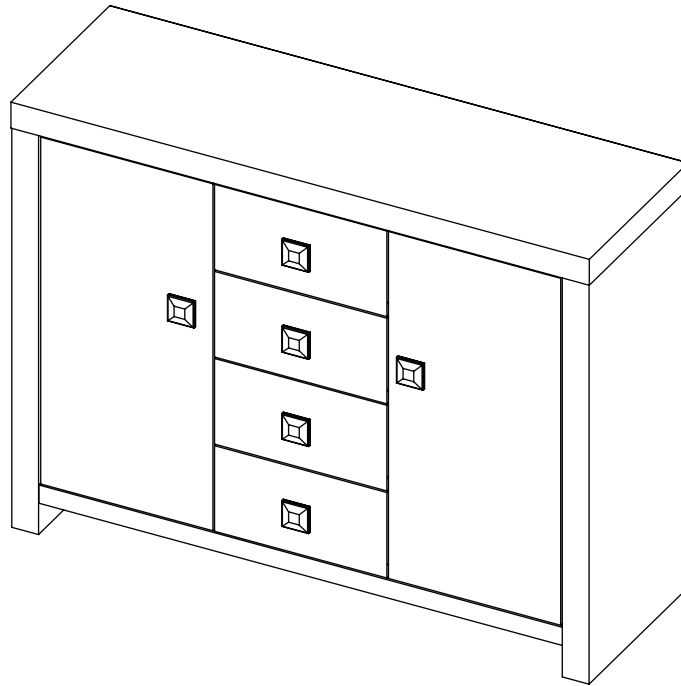

Keep instructions for future reference

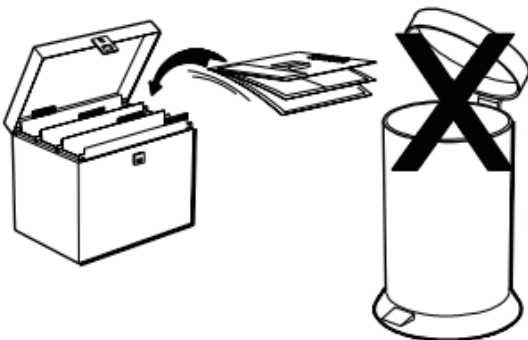

Supplied by : GFW THE FURNITURE WAREHOUSE
Waterside Distribution Centre
Waterside Business Park
Johnson Road
Lancashire
BB3 3RT