

# IDIS DRESSING TABLE

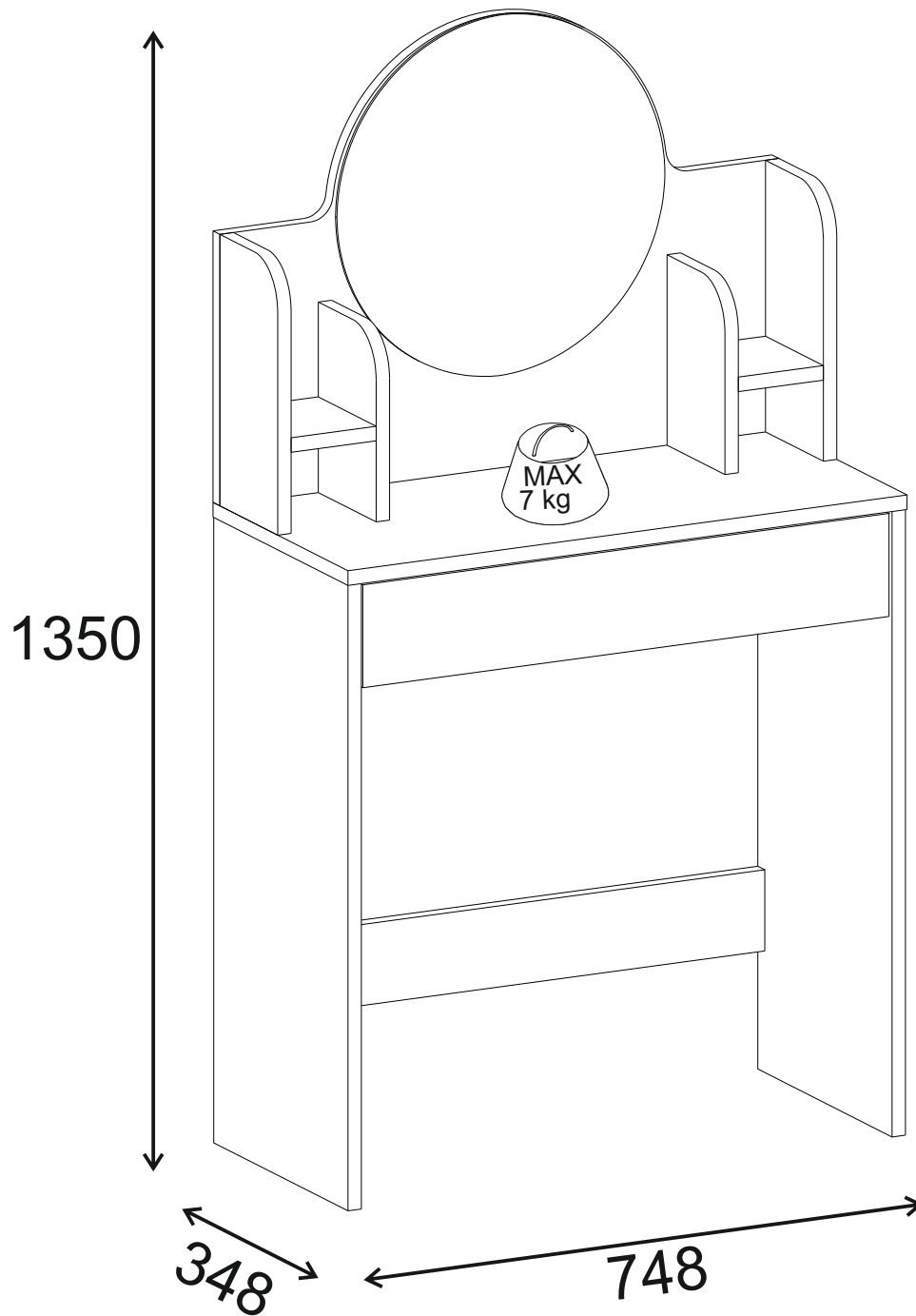



Dear Customer,

Thank you for purchasing this product.  
We design and produce our products for people to love and have fun with them as we do.  
The product you bought was subjected to all sorts of tests and quality controls before sending it to you

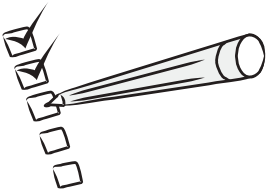

- When you are ready to start, make sure that you have the right tools, and plenty of space and a clean, dry area for assembly.
- Unwrap all packaging materials and place the components on top of the carton box or on a clean floor to prevent it from scratching.
- Check the pack and make sure you have all the parts listed.
- Ensure that this product is fully assembled as illustrated before use.
- Check all screws or bolts are tightened and inspect regularly
- Tools not included.
- Due to the size of this product we recommend that it is assembled in the room intended for use.



## CARE INFORMATION

Never use scourers, abrasives or chemical cleaners.  
To clean wipe with a sponge and warm soapy water. Do not use solvent based cleaners or detergents as they can bleach or damage the product.  
Do not place hot or warm objects on the surface as these may damage the product.  
Always use a suitable heat resistant mat.

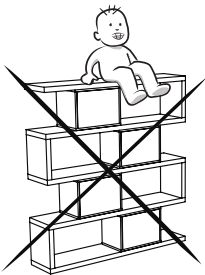

## WARNINGS

Keep small parts out of reach of children.  
Make sure the legs remain in contact with the floor.  
This product should only be used on a firm and level floor.  
Do not sit or stand on this product.



DO NOT use power tools to construct this product.  
DO NOT over-tighten screws or bolts.  
DO NOT use this product if parts are missing, damaged or worn.

We recommend the use of the fixings provided for safety reasons.  
N.B If in doubt please consult a qualified trades person. Warning.  
Always ensure the area to be drilled is free from hidden electrical wires, water and gas pipes

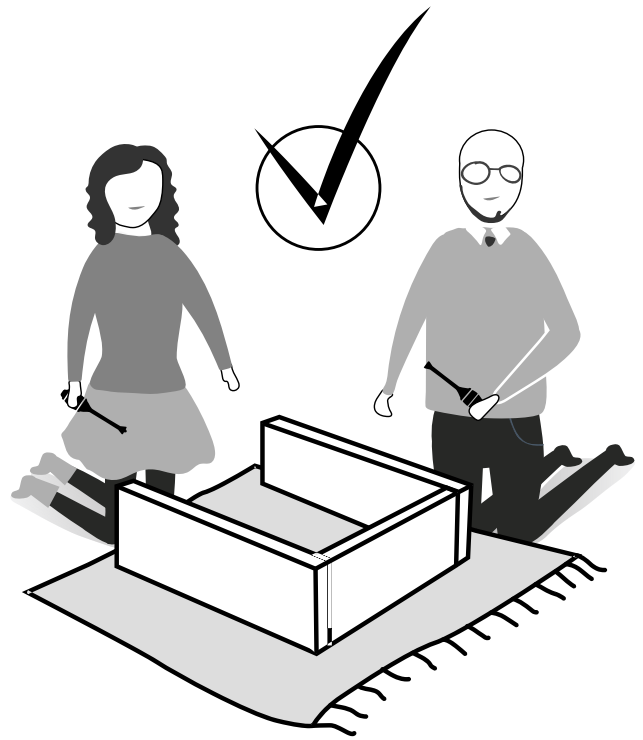
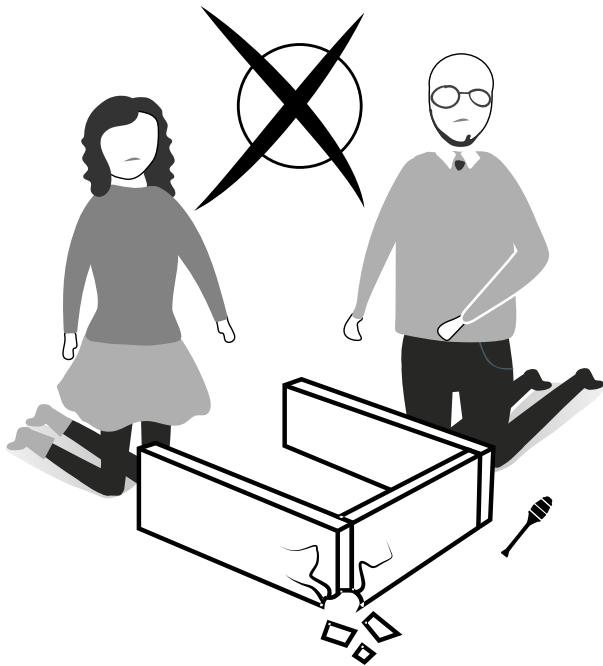
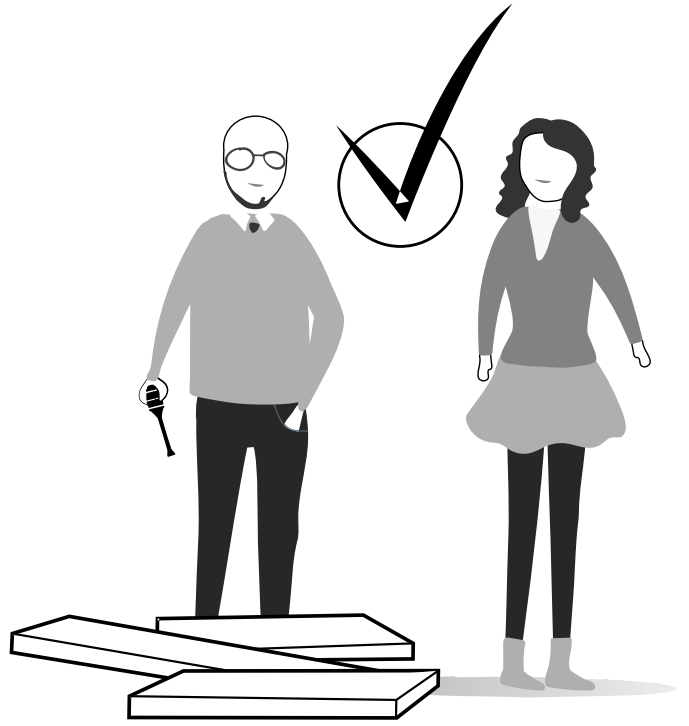
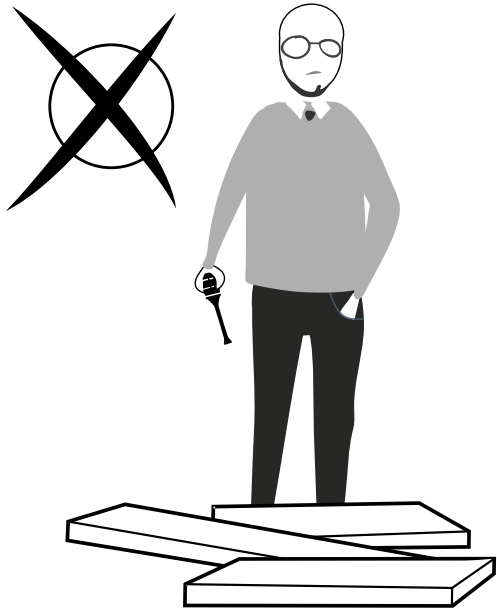

# ATTENTION !!

Minifix is the main connection material used in our products.  
Before starting assembly, please check the drawings below.

A04

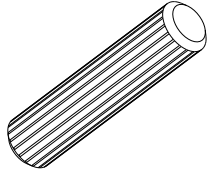

A23

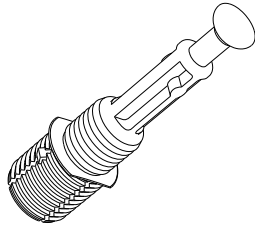

A22

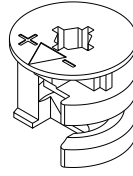

A12

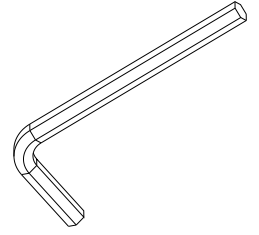

1

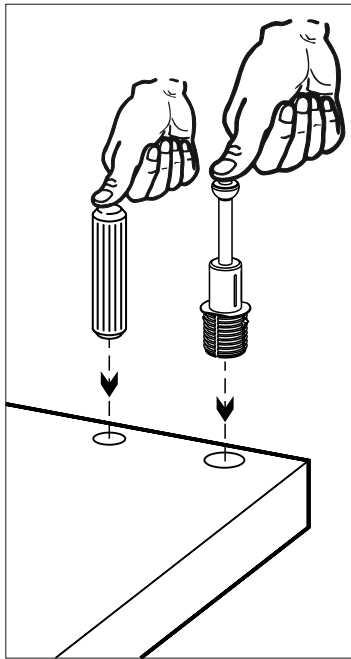

2

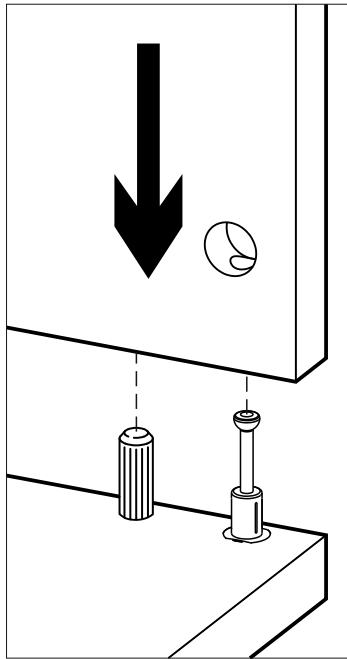

3

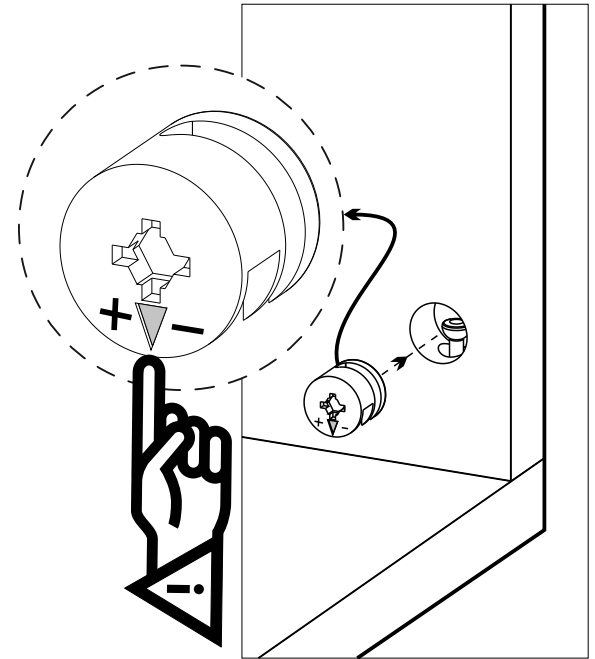

4

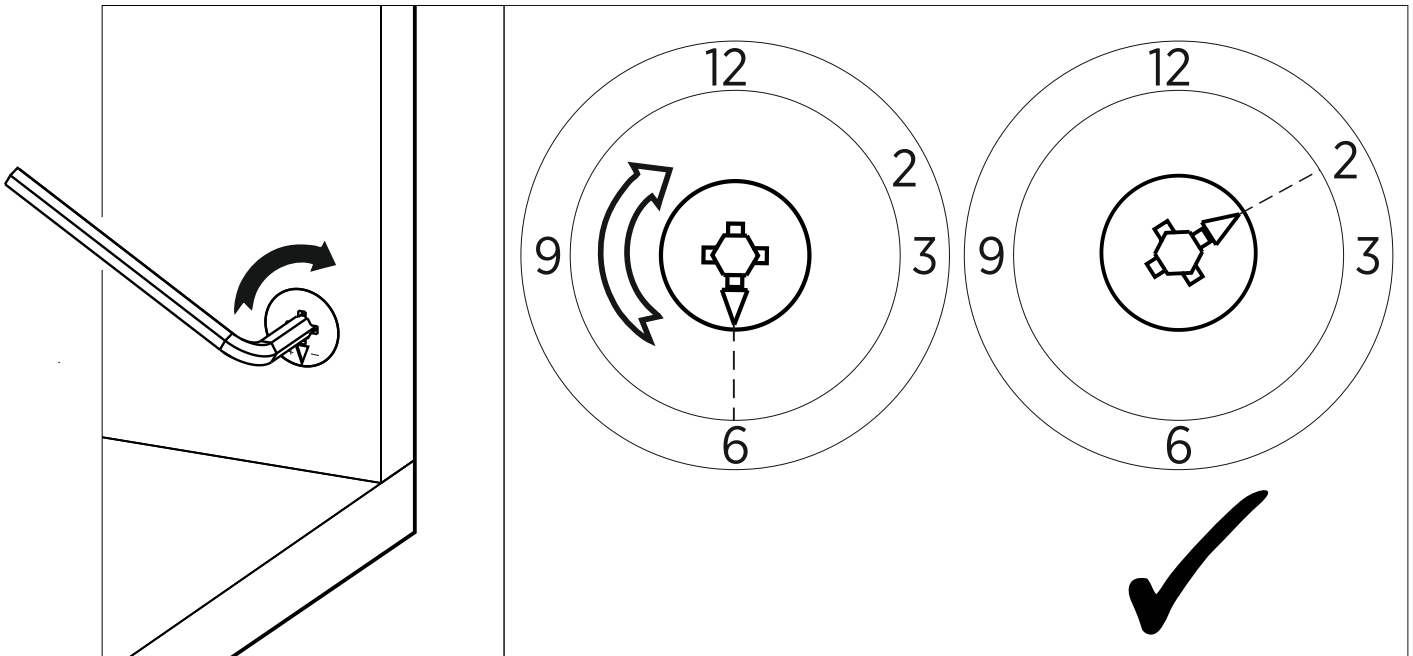

# ATTENTION !!

Our products use a screw system. Before you proceed with installation try to understand the following.



**A13**



**1**

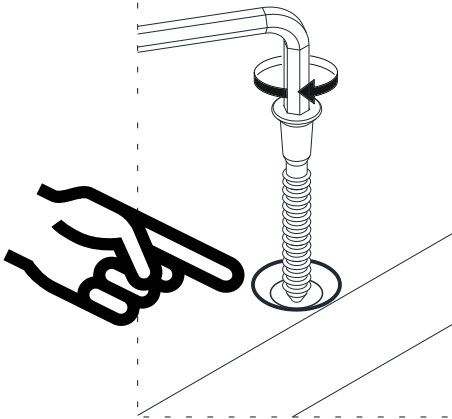

**1**

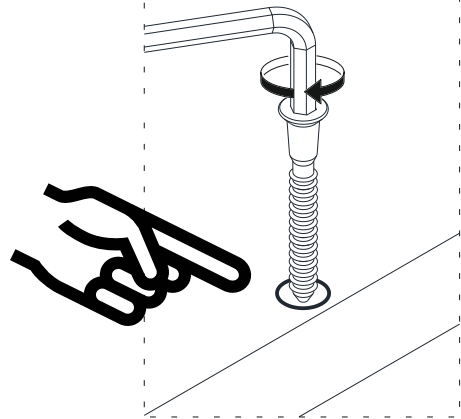

**2**

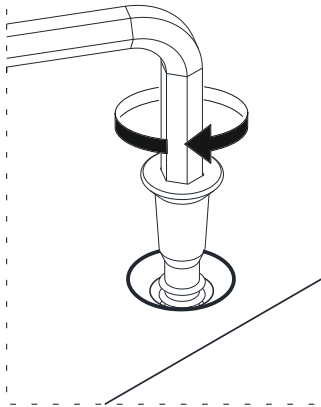

**2**

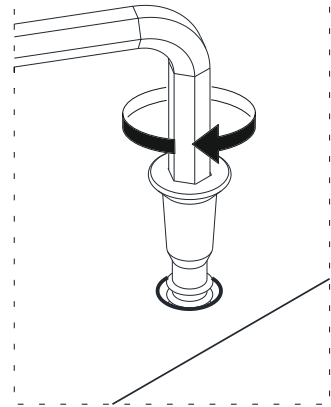

**3**

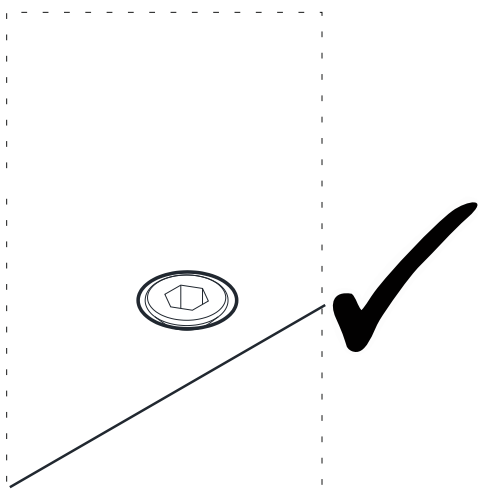

**3**

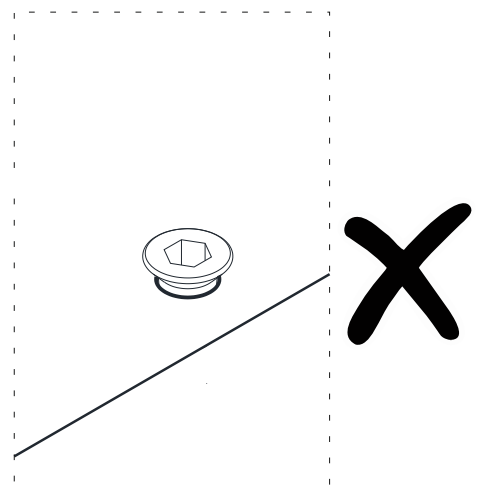

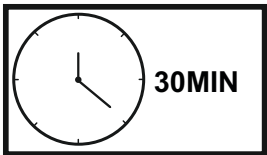

Follow the installation steps in the order as shown.  
Position the parts as shown in the installation guide steps.

# HARDWARE LIST

<b>A04</b> Ø8x30 18x	<b>A22</b> Minifix k18 28x	<b>A23</b> Minifix M10 28x	<b>A06</b> 18mm C1-36x	<b>A16</b> DbØ8 1x
<b>A12</b> Allen 1x	<b>A13</b> 50mm 8x	<b>A18</b> 3,5x18 14x	<b>A17</b> 4X50 1x	<b>A25</b> ARK.PL 4x
<b>A87</b> 15x90x30 1x	<b>A41</b> Ø8x55 2x	<b>PB01</b> Kece 4x	<b>Z32</b> Krt300 1x	

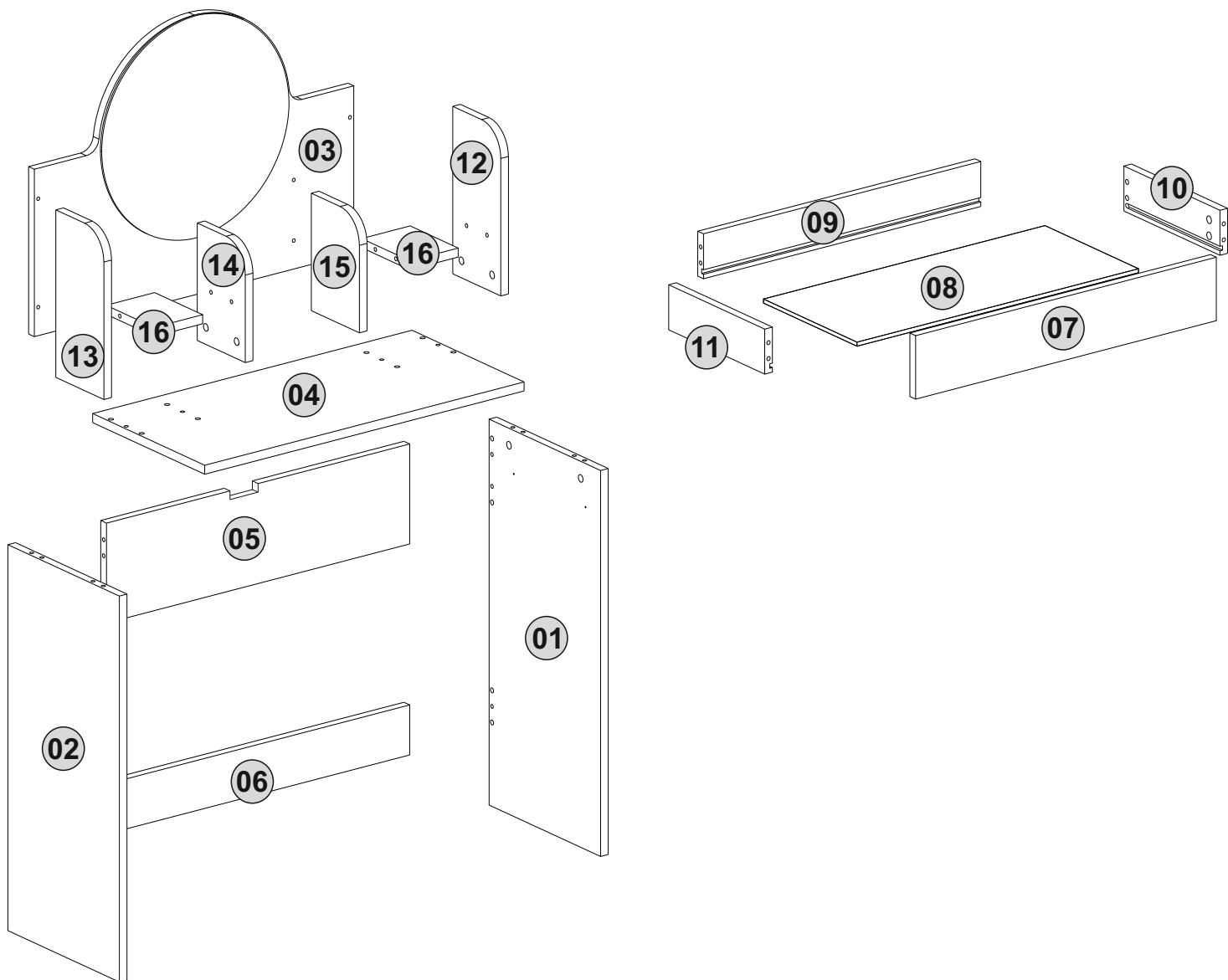

1

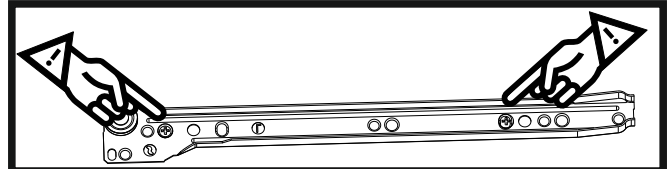
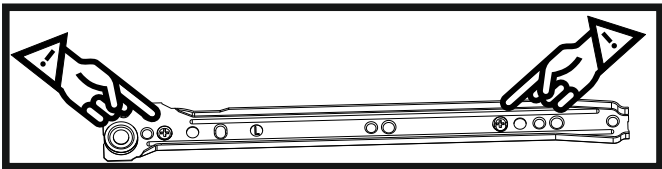
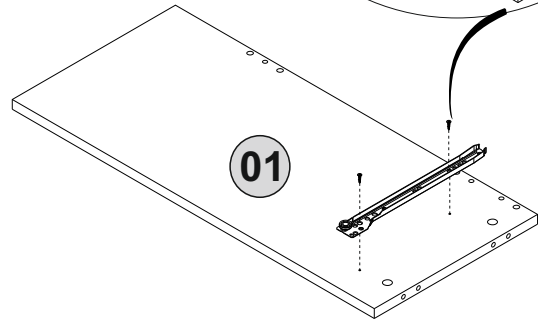
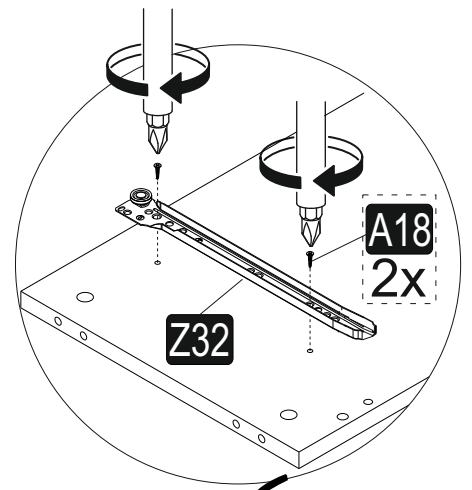
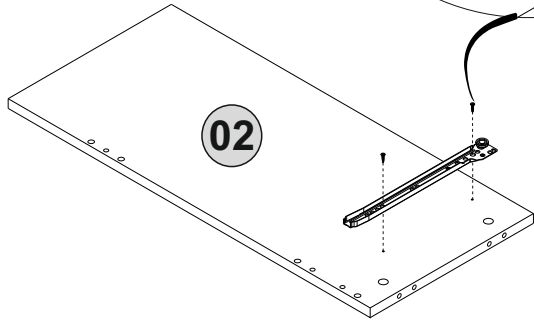
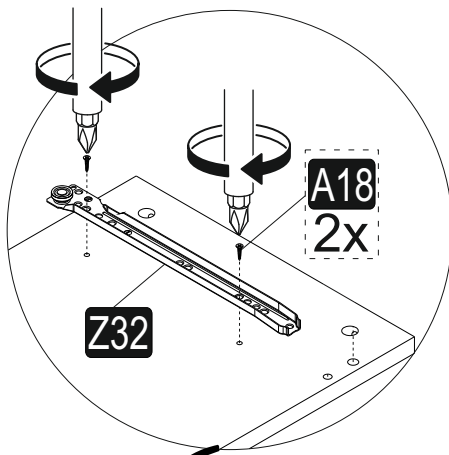

2

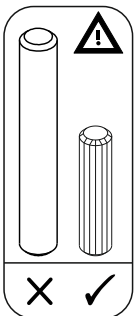
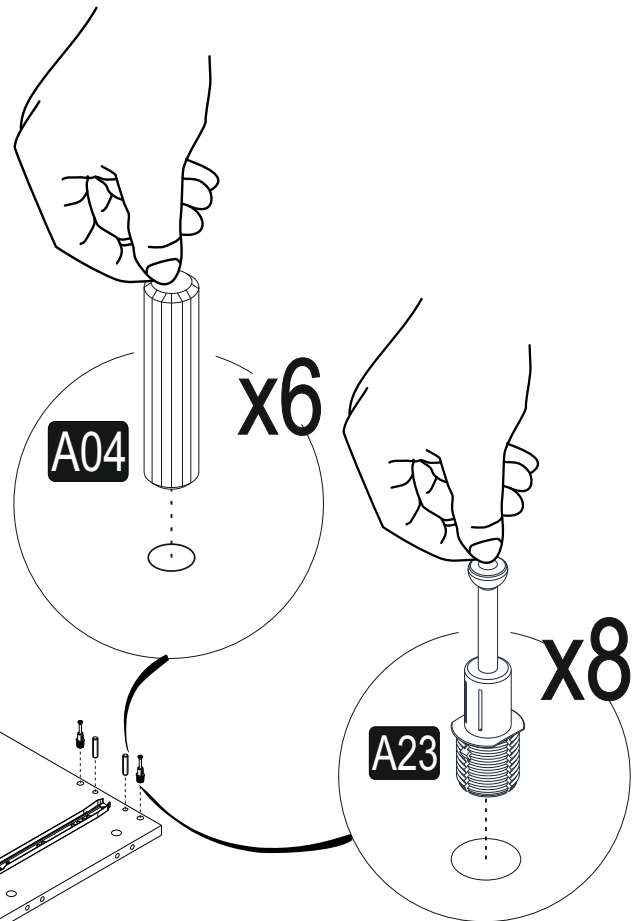
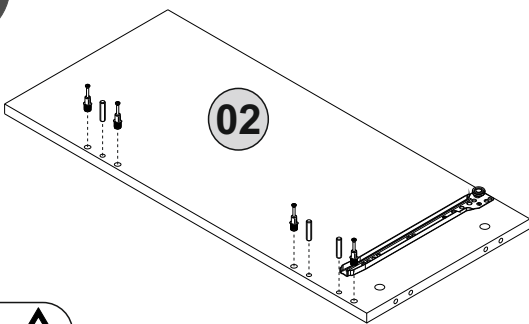

3

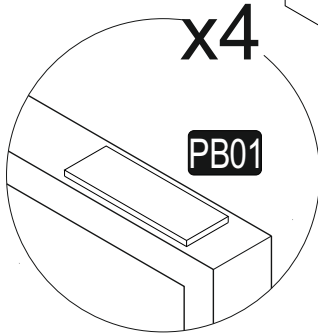
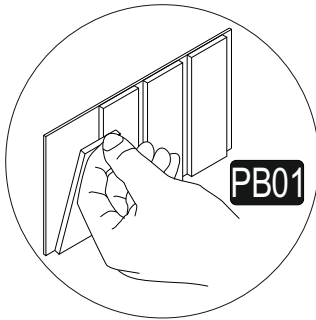
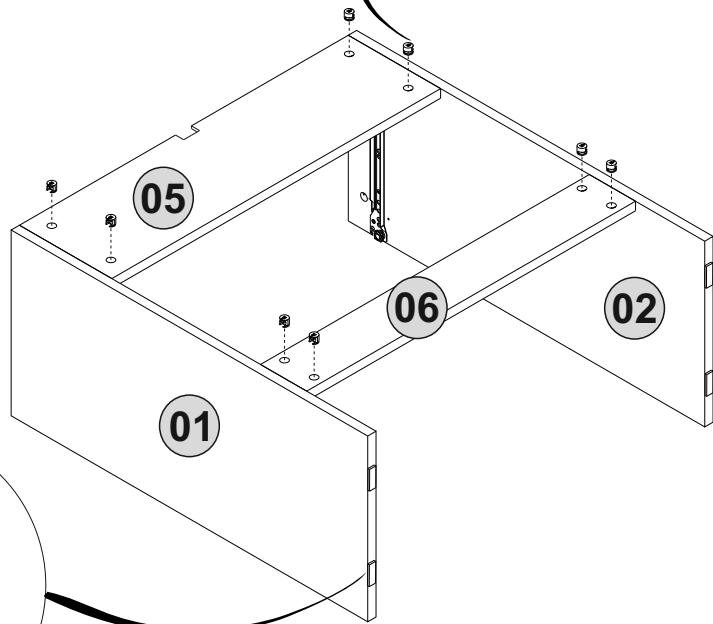
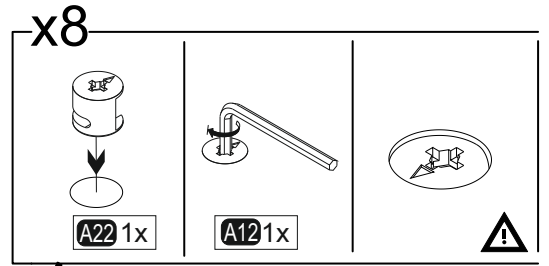
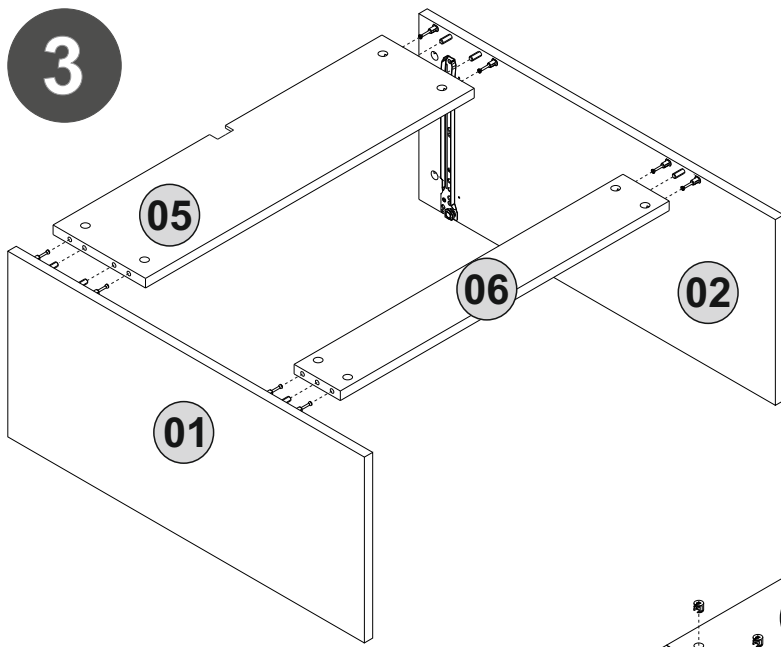

4

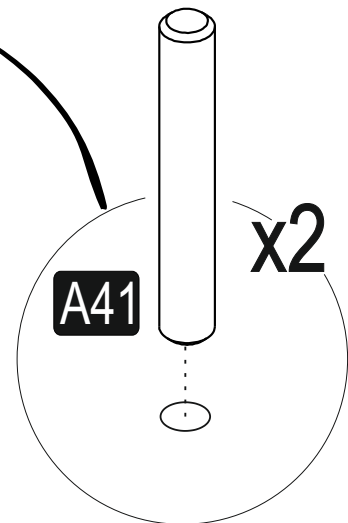
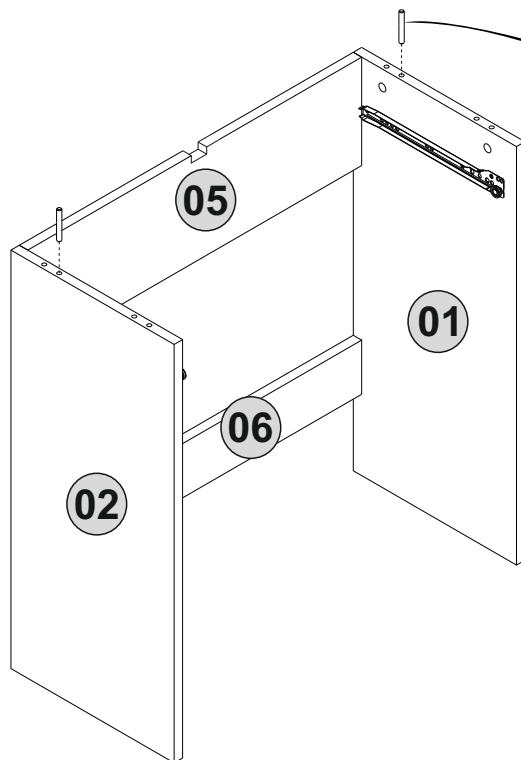
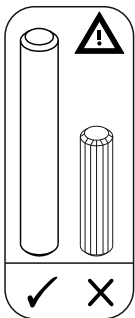



5

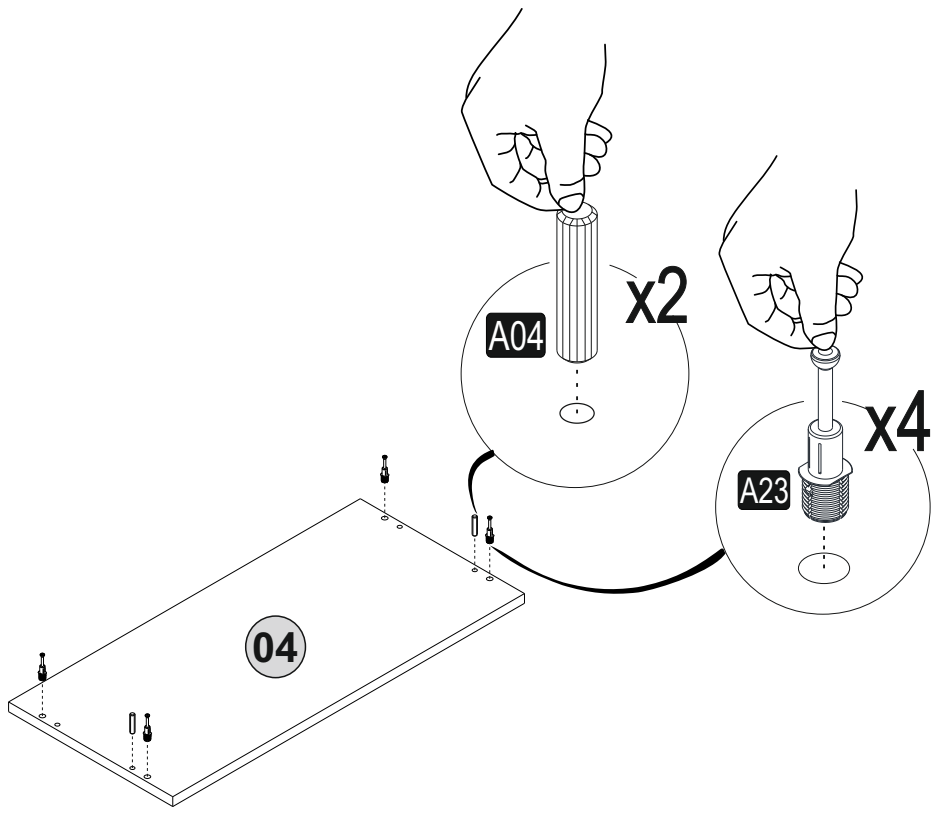

6

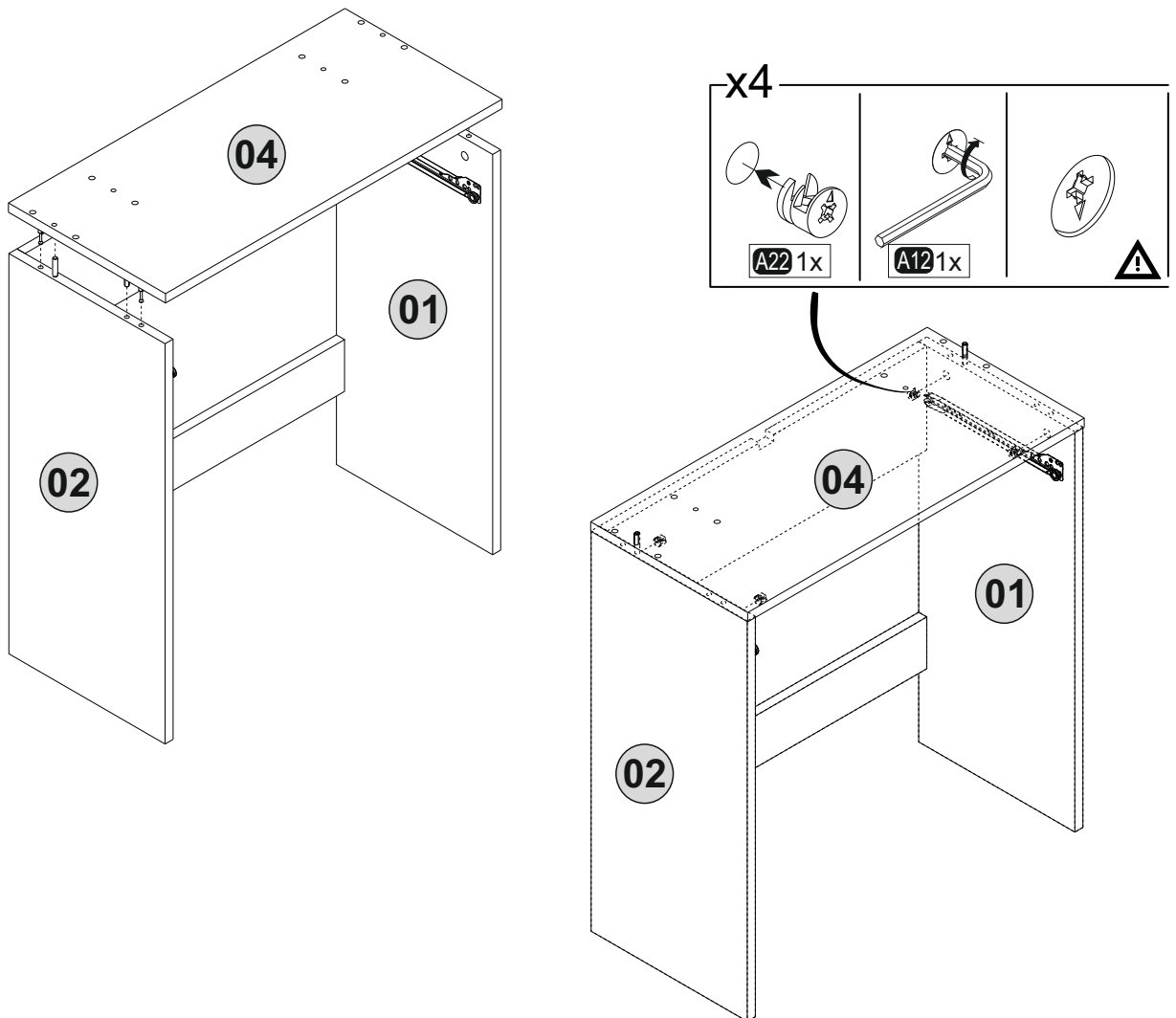

7

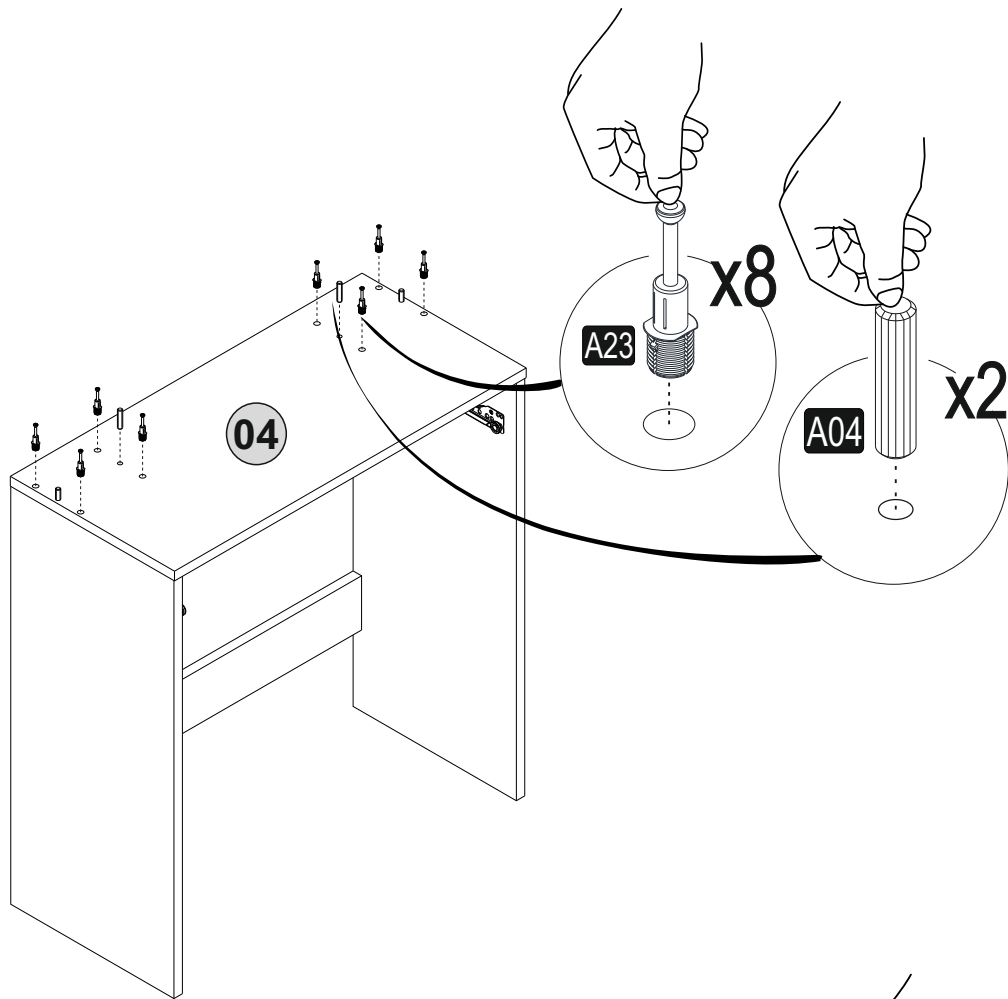

8

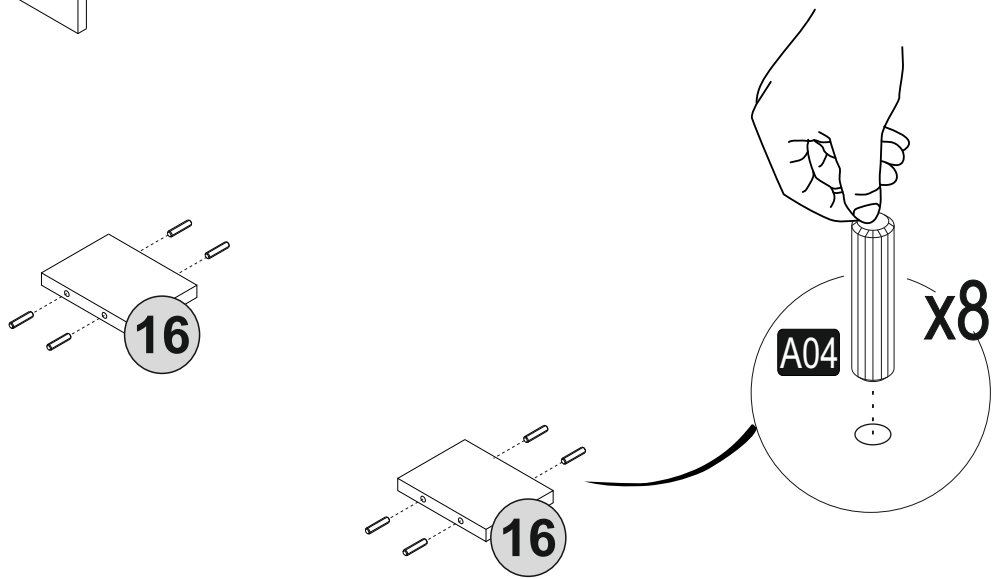

9



10

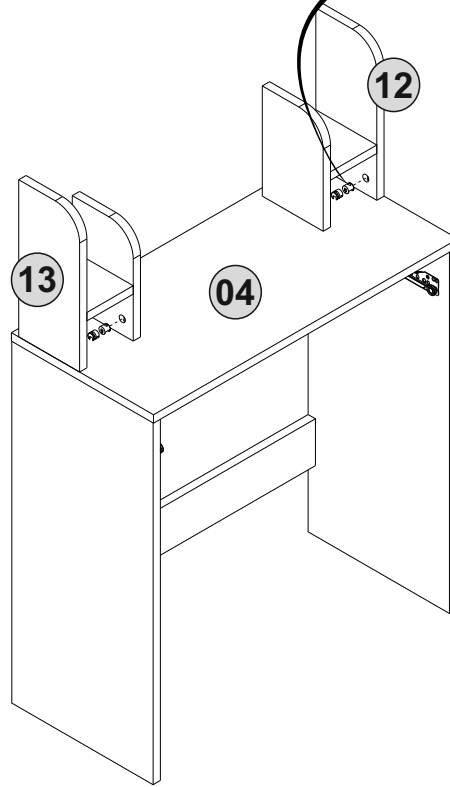
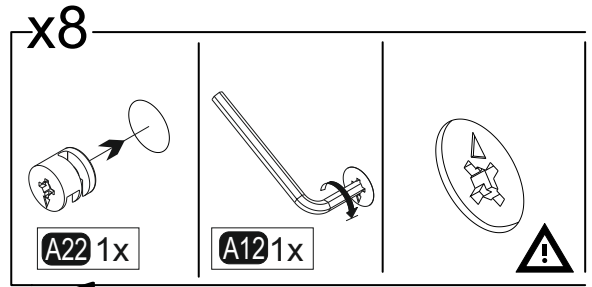
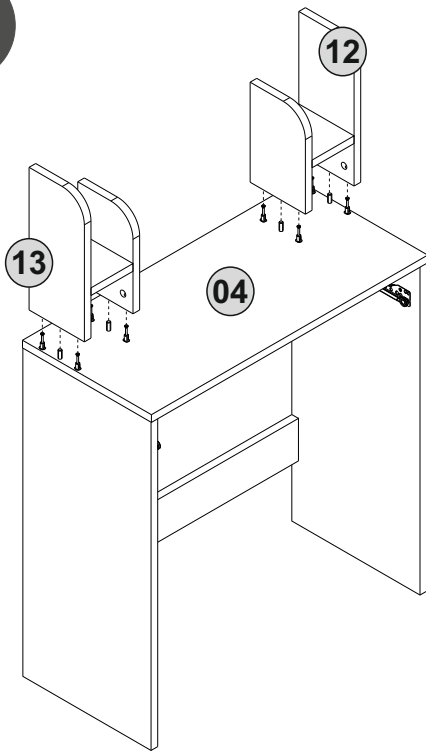

11

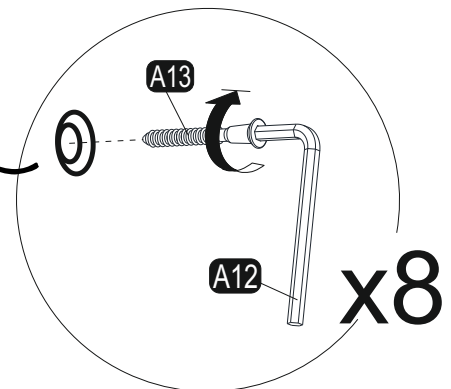
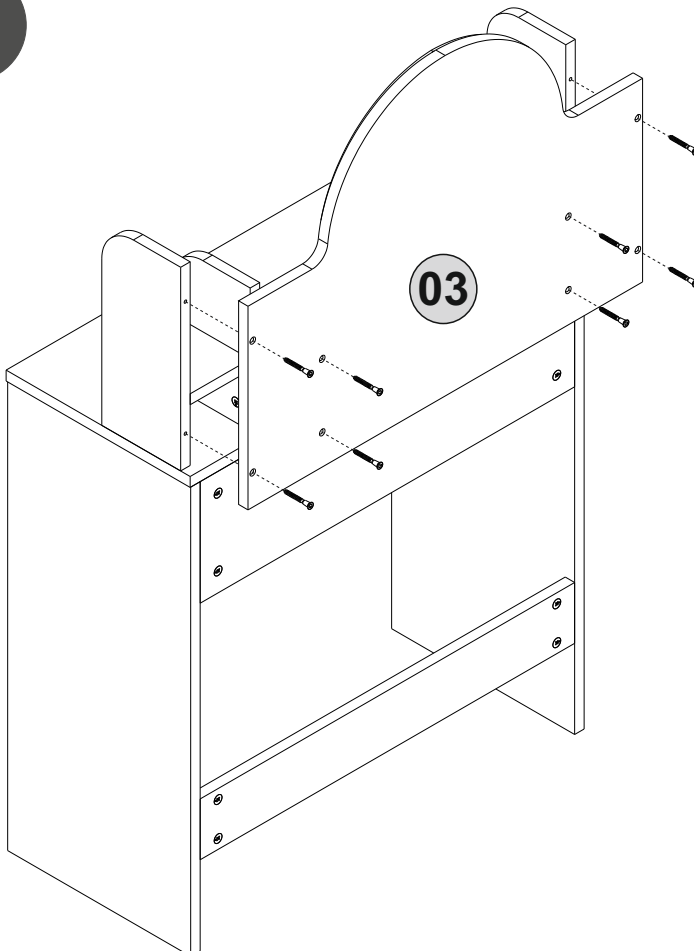

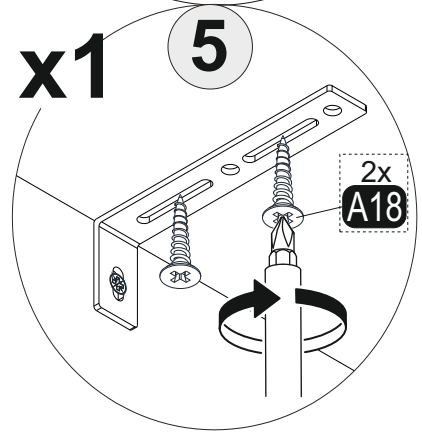
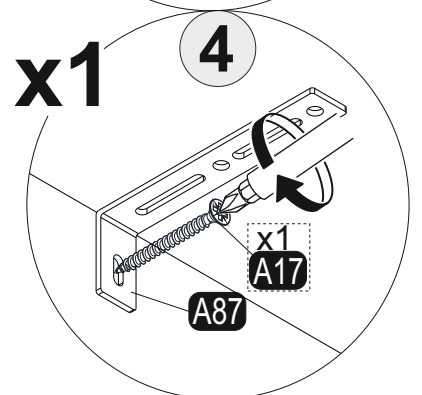
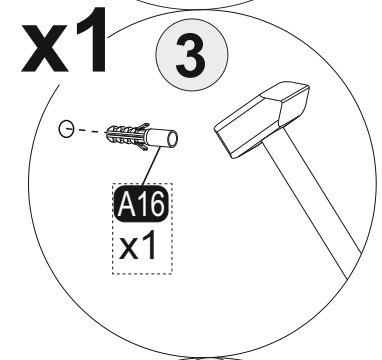
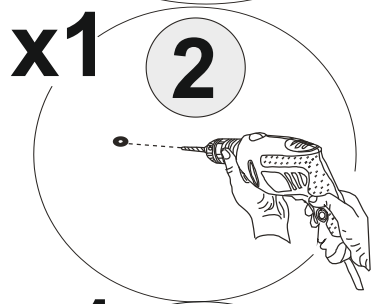
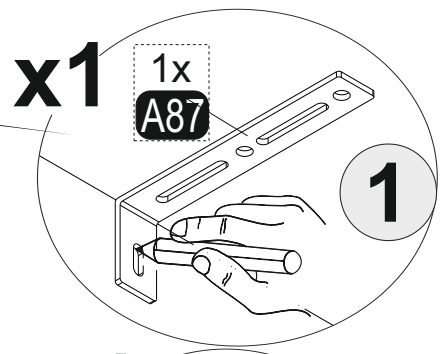
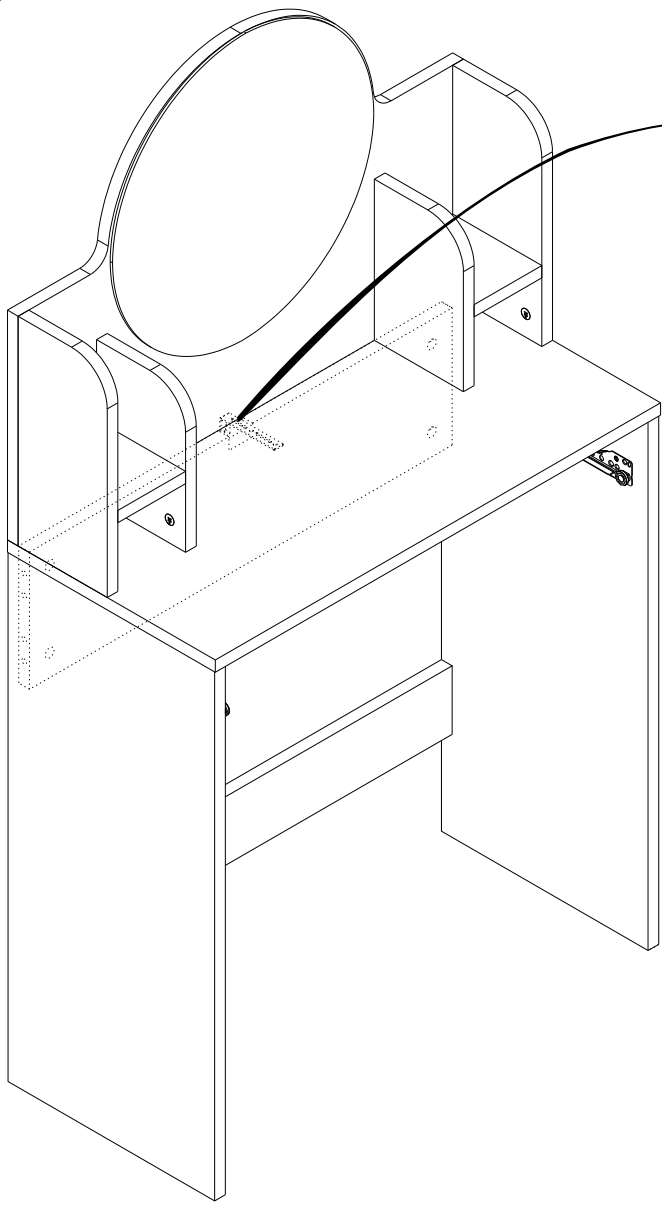

13

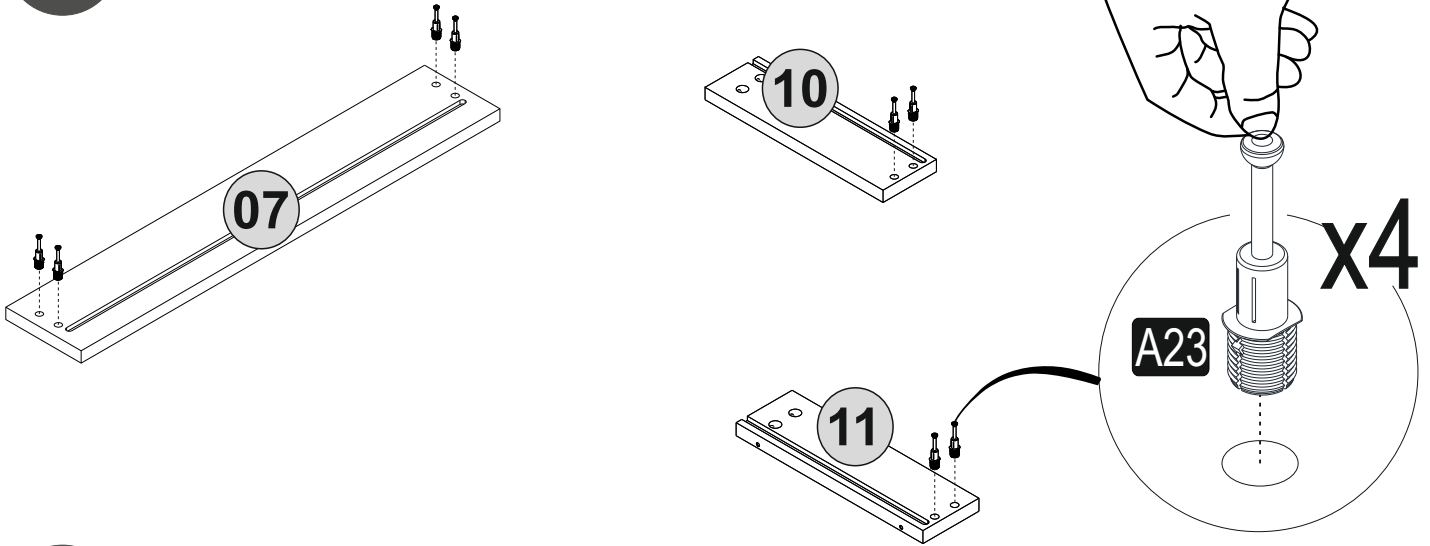

14

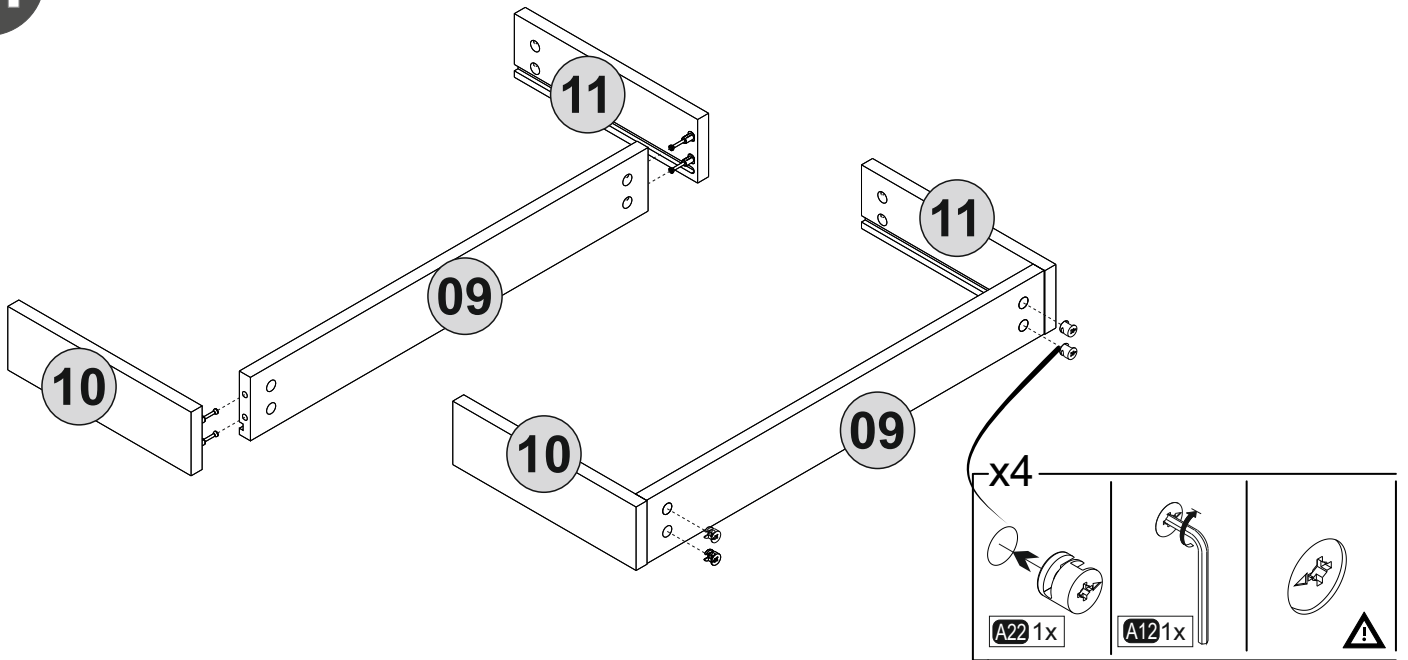

15

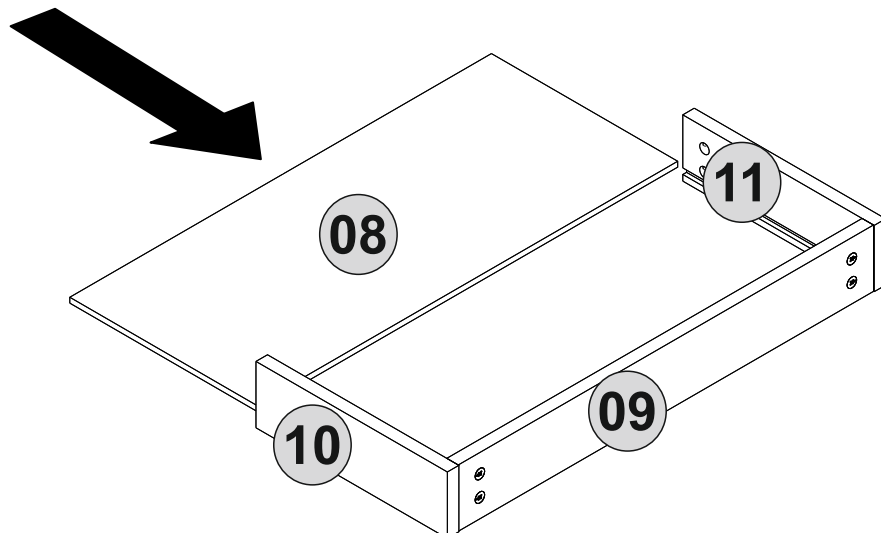

16

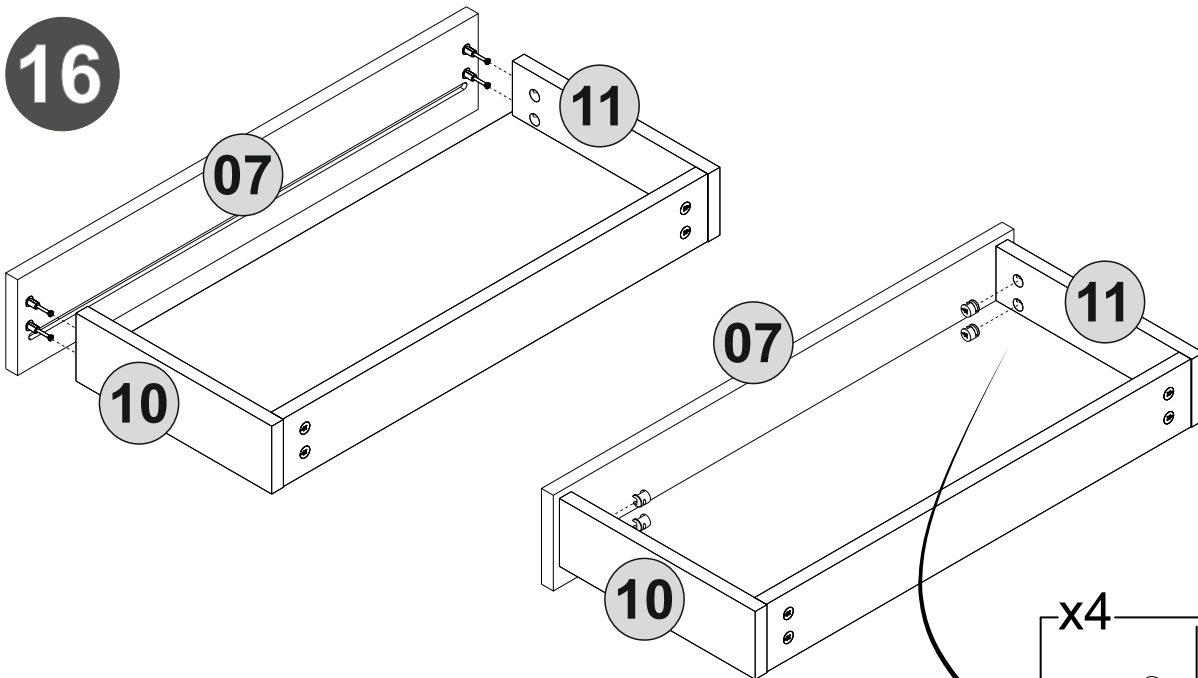

17

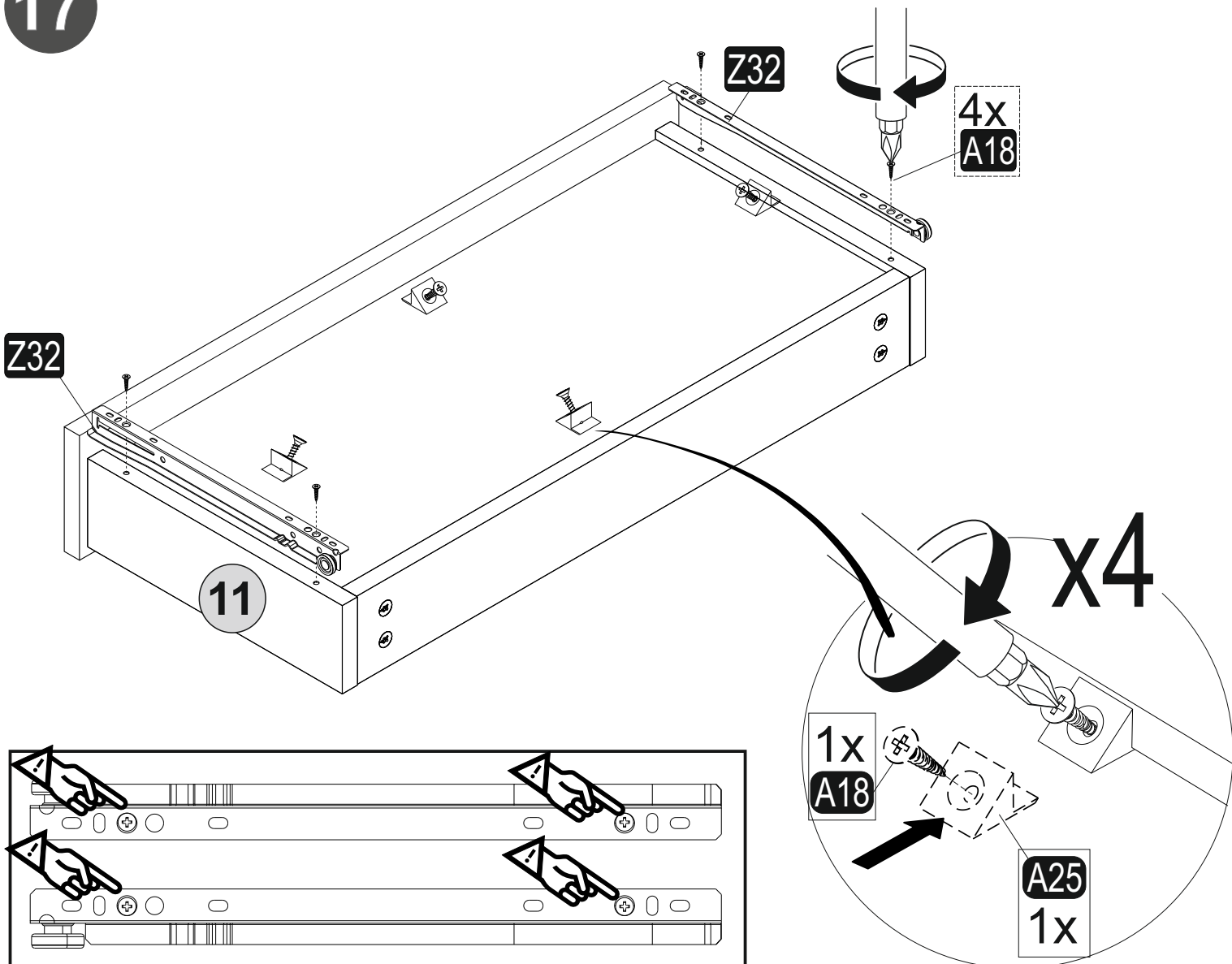

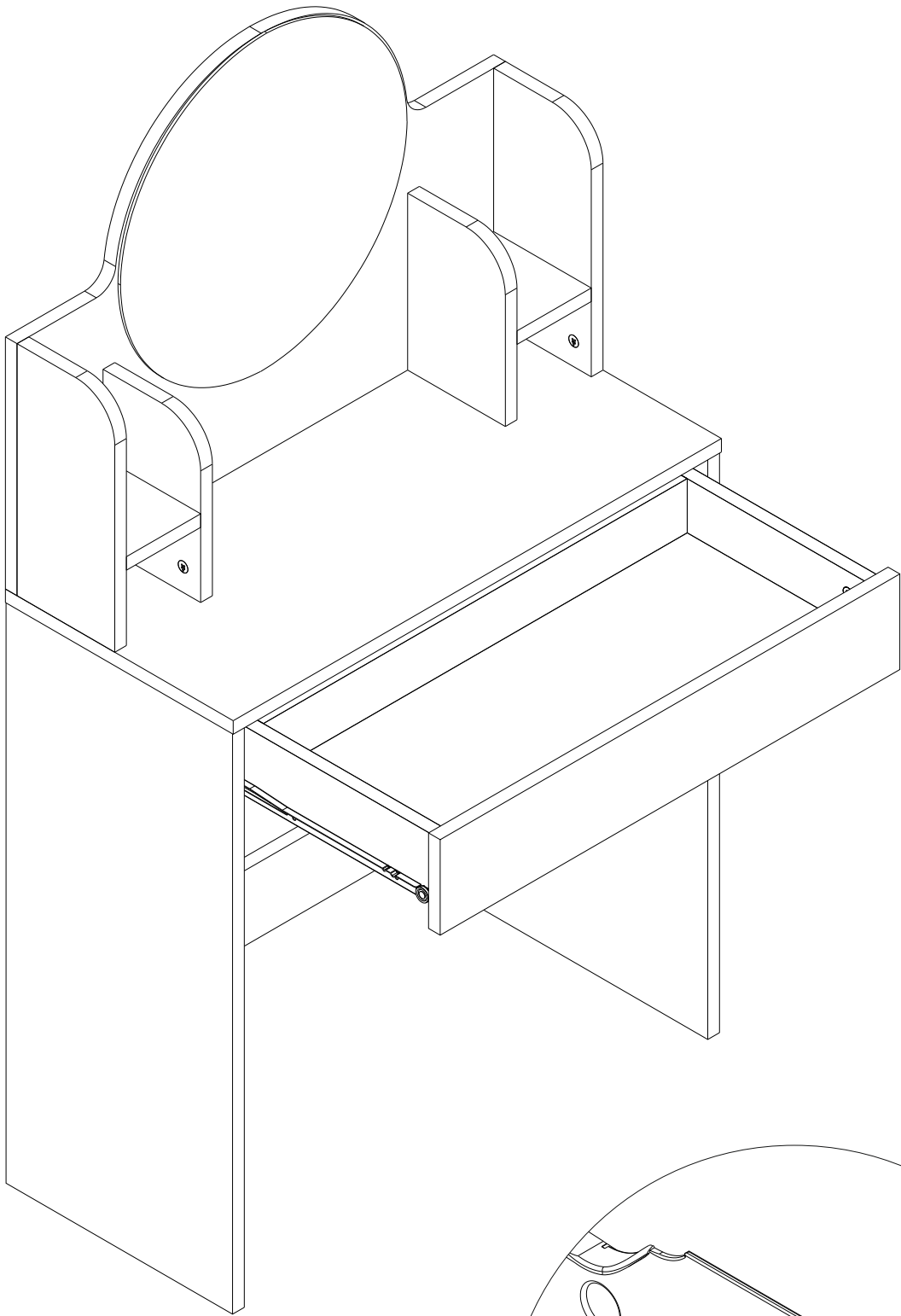

Place a round sticker A06 over each minifix and screw on the dressing table

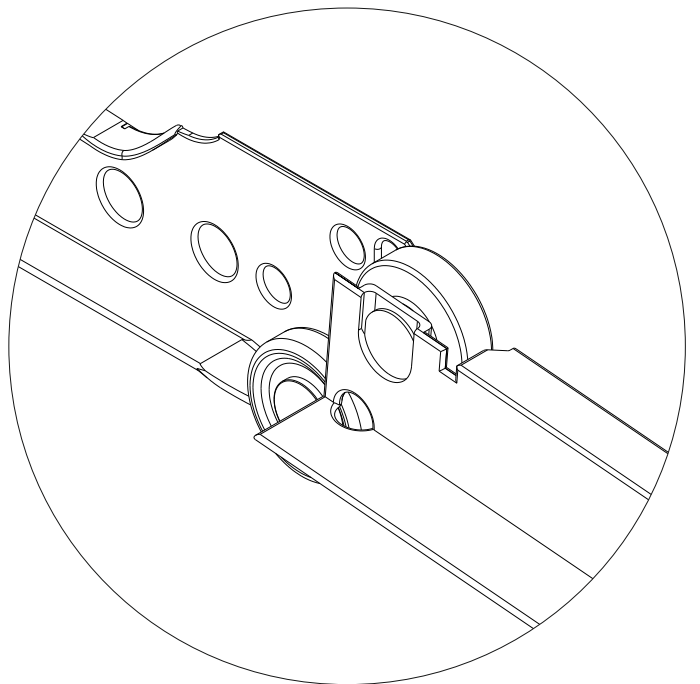
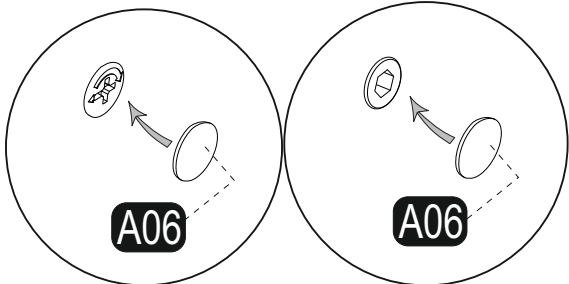

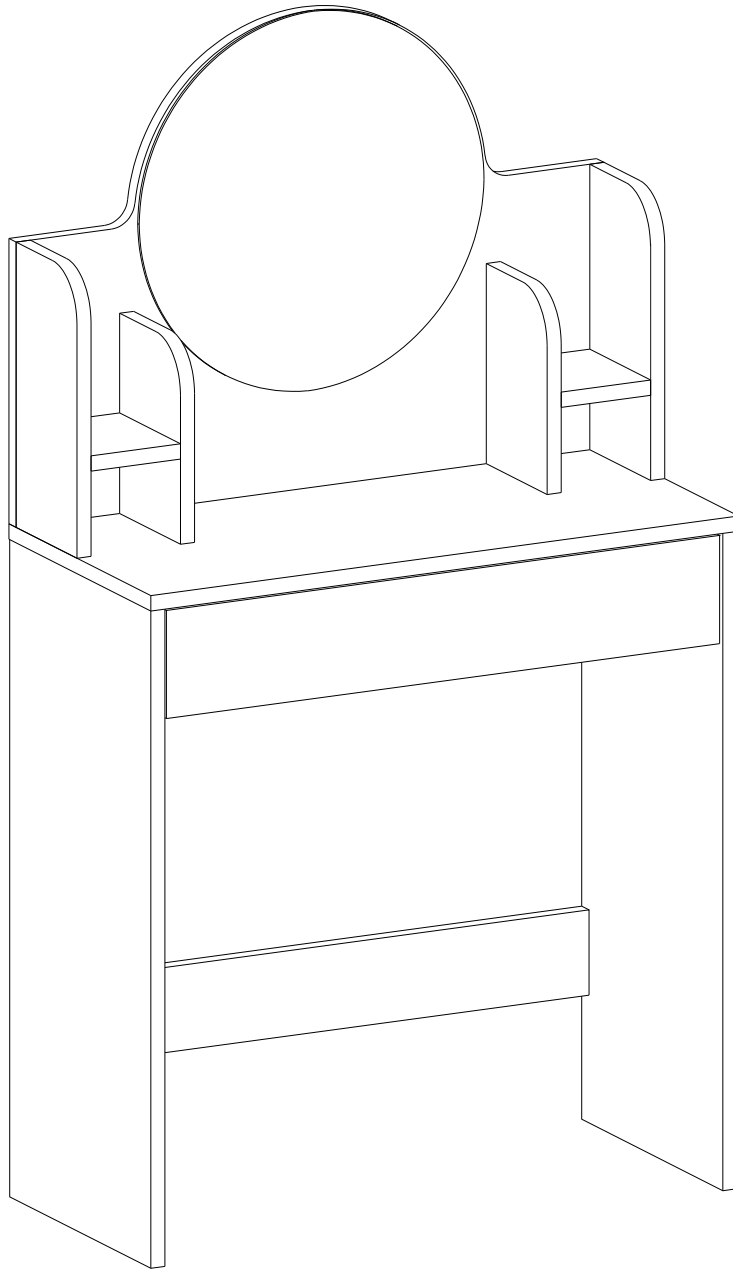

Supplied by:  
GFW THE FURNITURE WAREHOUSE.  
Waterside Distribution Centre.  
Waterside Business Park.  
Johnson Road.  
Lancashire.  
BB3 3RT