

# NORDIC WINE CABINET ASSEMBLY INSTRUCTIONS

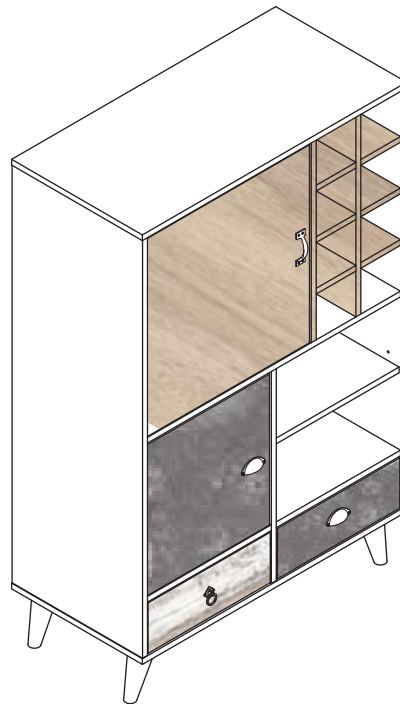

FOR DOMESTIC USE ONLY

IMPORTANT

PLEASE READ BEFORE YOU CONTINUE FURTHER

THE PRODUCT YOU HAVE PURCHASED WILL GIVE YOU MANY YEARS OF SERVICE IF YOU FOLLOW THE GUIDELINES FOR ITS SAFE ASSEMBLY AND PERIODIC MAINTENANCE AND CLEANING.

ASSEMBLE ON A SOFT CLEAN SURFACE.

DO NOT USE ANY TOOLS OTHER THAN THOSE SHOWN.

ANY SPANNERS OR ALLEN KEYS REQUIRED ARE INCLUDED WITH THE FITTING KIT.

DO NOT FOR ANY REASON USE A POWER TOOL TO ASSEMBLE THIS PRODUCT. ITS USE WILL INVALIDATE ANY CLAIM YOU MAY HAVE AND COULD MAKE THIS PRODUCT UNSAFE.

DEPENDING ON THE AMOUNT OF USE THIS PRODUCT RECEIVES, IT MAY BE NECESSARY TO TIGHTEN UP THE FIXINGS FROM TIME TO TIME. THIS IS COMPLETELY NORMAL FOR ANY FLAT PACK FURNITURE. DO NOT OVERTIGHTEN FIXINGS.

FOR CLEANING, YOU MAY USE A DAMP CLOTH (NOT WET). DO NOT USE POLISH, DETERGENT OR CHEMICAL CLEANERS.

THE SURFACE OF THIS ITEM IS NOT HEAT RESISTANT. ALWAYS USE A PLACE MAT UNDER HOT OR COLD ITEMS TO PREVENT MARKING.

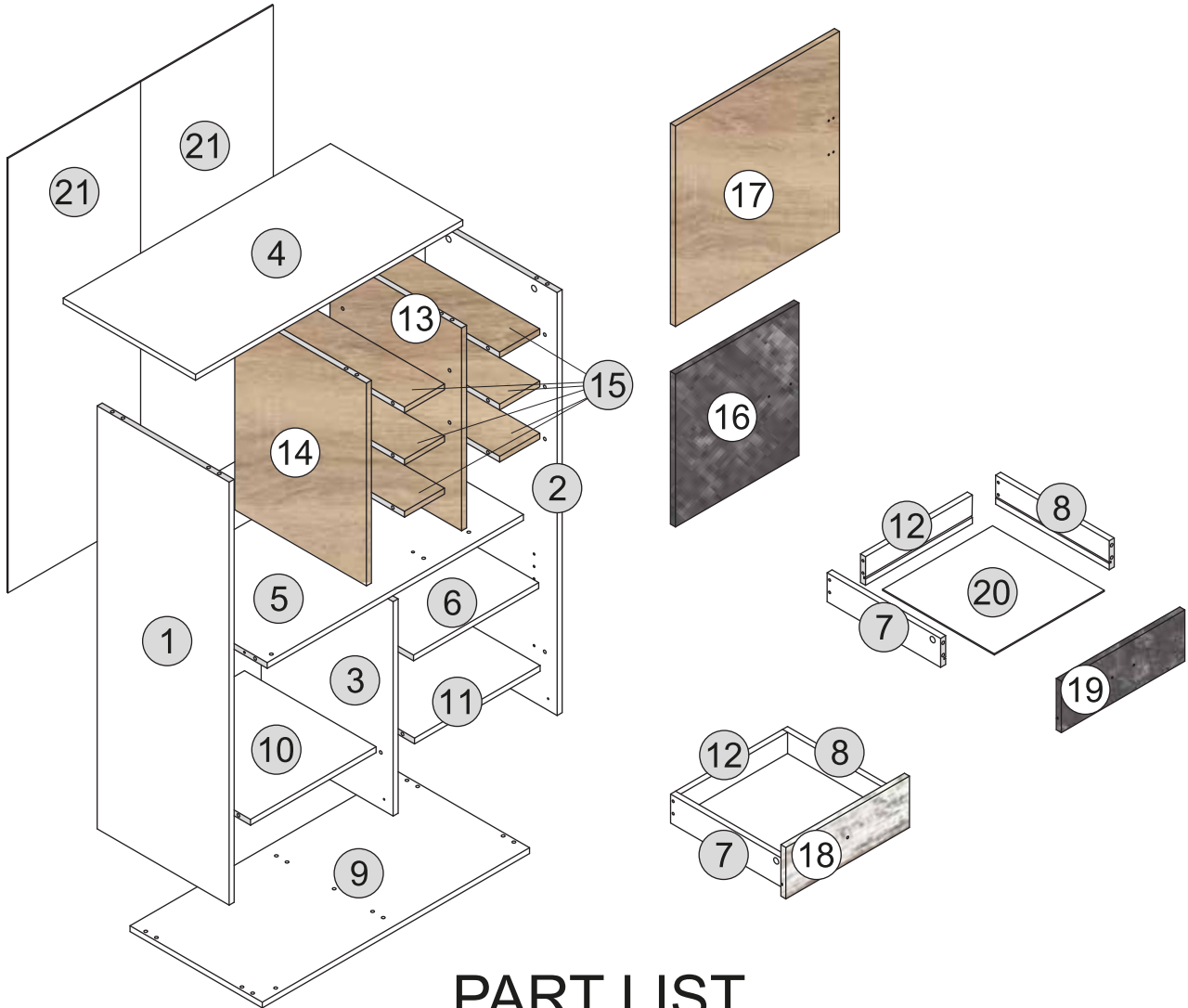

## PART LIST

Part Number	Part Code	Part Description	Quantity	Carton
1	S300-320-031-ZF1-01	Left Side Panel	1	1/2
2	S300-320-031-ZF1-02	Right Side Panel	1	1/2
3	S300-320-031-ZF1-03	Bottom Centre Panel	1	2/2
4	S300-320-031-ZF1-04	Top Panel	1	1/2
5	S300-320-031-ZF1-05	Centre Shelf Panel	1	1/2
6	S300-320-031-ZF1-06	Shelf Panel	1	2/2
7	S300-320-031-ZF1-07	Left Drawer Side Panel	2	2/2
8	S300-320-031-ZF1-08	Right Drawer Side Panel	2	2/2
9	S300-320-031-ZF1-09	Bottom Panel	1	1/2
10	S300-320-031-ZF1-10	Bottom Shelf Panel (L)	1	2/2
11	S300-320-031-ZF1-11	Bottom Shelf Panel (R)	1	2/2
12	S300-320-031-ZF1-12	Drawer Back Panel	2	2/2
13	S300-320-031-ZF1-13	Top Centre Panel (R)	1	2/2
14	S300-320-031-ZF1-14	Top Centre Panel (L)	1	2/2
15	S300-320-031-ZF1-15	Small Shelf Panel	6	1/2
16	S300-320-031-ZF1-16	Small Door	1	2/2
17	S300-320-031-ZF1-17	Large Door	1	2/2
18	S300-320-031-ZF1-18	Left Drawer Front Panel	1	2/2
19	S300-320-031-ZF1-19	Right Drawer Front Panel	1	2/2
20	S300-320-031-ZF1-20	Drawer Base	2	2/2
21	S300-320-031-ZF1-21	Back Panel	2	1/2

# HARDWARE LIST

No	Part Name		Qty	Carton	No	Part Name		Qty	Carton
A	M8x30mm Wooden Dowel		x60	2/2	L	Handle + Screw <small>(4x20mm=1pcs)</small>		x1	2/2
B	M4x45mm Screw		x8	2/2	M	Handle + Screw <small>Y-8238 (3x16mm=4pcs)</small>		x2	2/2
C	M4x38mm Screw		x8	2/2	N	Wall Fixings <small>(4x20mm=1pcs)</small>		x1	2/2
D	M3.5x14mm Screw		x38	2/2	O	Wood Leg + Plastic Foot		x4	2/2
E	Minifix Cam Bolt <small>(8032t)</small>		x20	2/2	P	Wood Leg 170mm + Plastic Foot		x1	2/2
F	Minifix Cam Nut <small>(1510)</small>		x24	2/2	Q	Magnetic Door Catch		x2	2/2
G	Double Cam Bolt <small>(M5.2 x 64mm)</small>		x2	2/2	R	Metal Plate		x2	2/2
H	Iron Shelf Support		x4	2/2	S	Glasses Holder		x2	2/2
I	14"Drawer Slide <small>(0.9 - W)</small>		x2 Set	1/2	T	Door Pin		x4	2/2
J	6/8" Nail		x50	2/2	U	M6x35mm JCBC Screw <small>(Z-Blue)</small>		x1	2/2
K	Handle + Screw <small>L-3510 (3x16mm=4pcs)</small>		x1	2/2	V	Allen Key <small>(M6)</small>		x1	2/2

## TIPS FOR FITTINGS CAM-LOCKS

WHEN FITTING CAM NUT. ENSURE STARTING POSITION IS CORRECT BEFORE YOU INSERT CONNECTING CAM BOLT TURN CLOCKWISE UNTIL SECURE

↑ CORRECT
 ↑ WRONG

**Cam bolt head needs to be in centre**

### **CAMBOLT**

**Tighten until shoulder in flush with panel. Do not overtighten or undertighten (see example below)**

Shoulder

Panel                      Panel

# STEP 1

## PARTS REQUIRED

1 - LEFT SIDE PANEL x1

2 - RIGHT SIDE PANEL x1

## HARDWARE REQUIRED

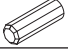
A  08

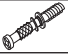
E  08

F  04

H  02

## TOOLS REQUIRED

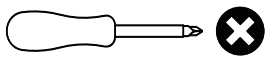

**WHEN FITTING CAM STUD**  
ENSURE THE CAM STUD IS FULLY TIGHTEN IN



✓

CORRECT

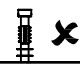

✗

WRONG

**WHEN FITTING CAMS**  
ENSURE STARTING POSITION IS CORRECT BEFORE YOU INSERT CONNECTING BOLT TURN CLOCKWISE UNTIL SECURE

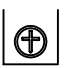

✓

CORRECT



✗

WRONG

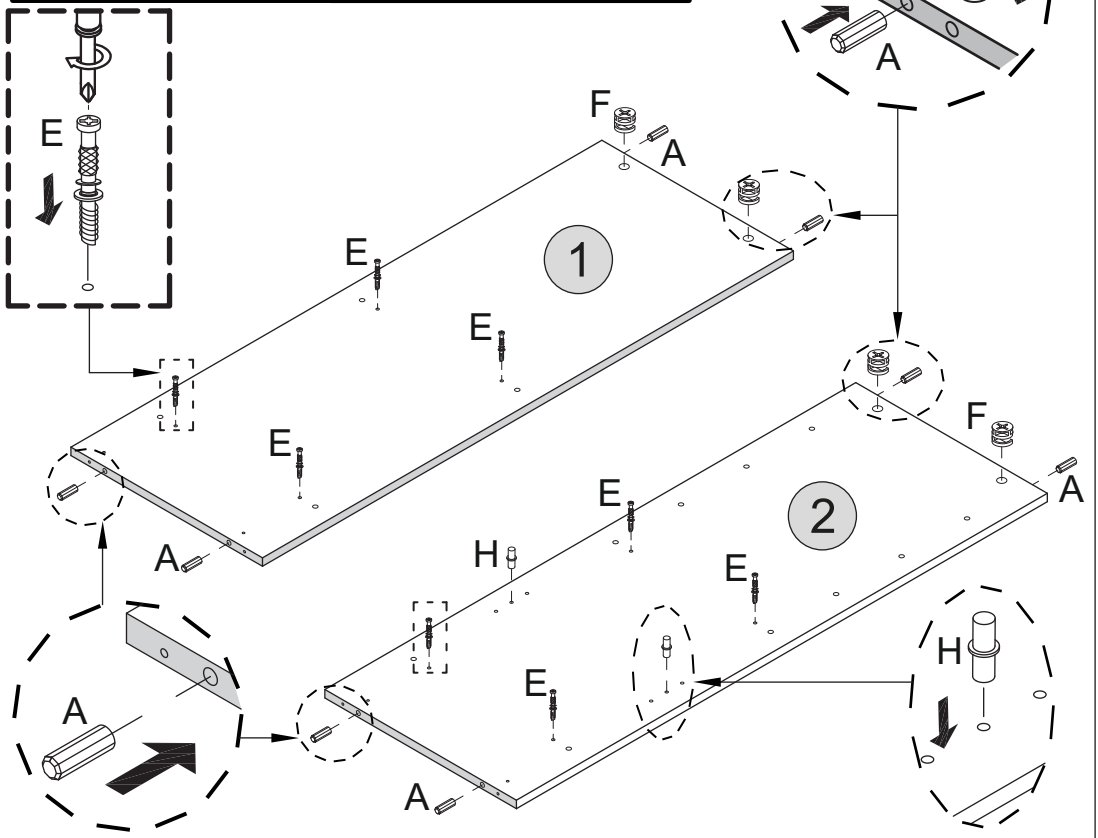

# STEP 2

## PARTS REQUIRED

1 - LEFT SIDE PANEL x1

2 - RIGHT SIDE PANEL x1

## HARDWARE REQUIRED

D  04

I  02

## TOOLS REQUIRED

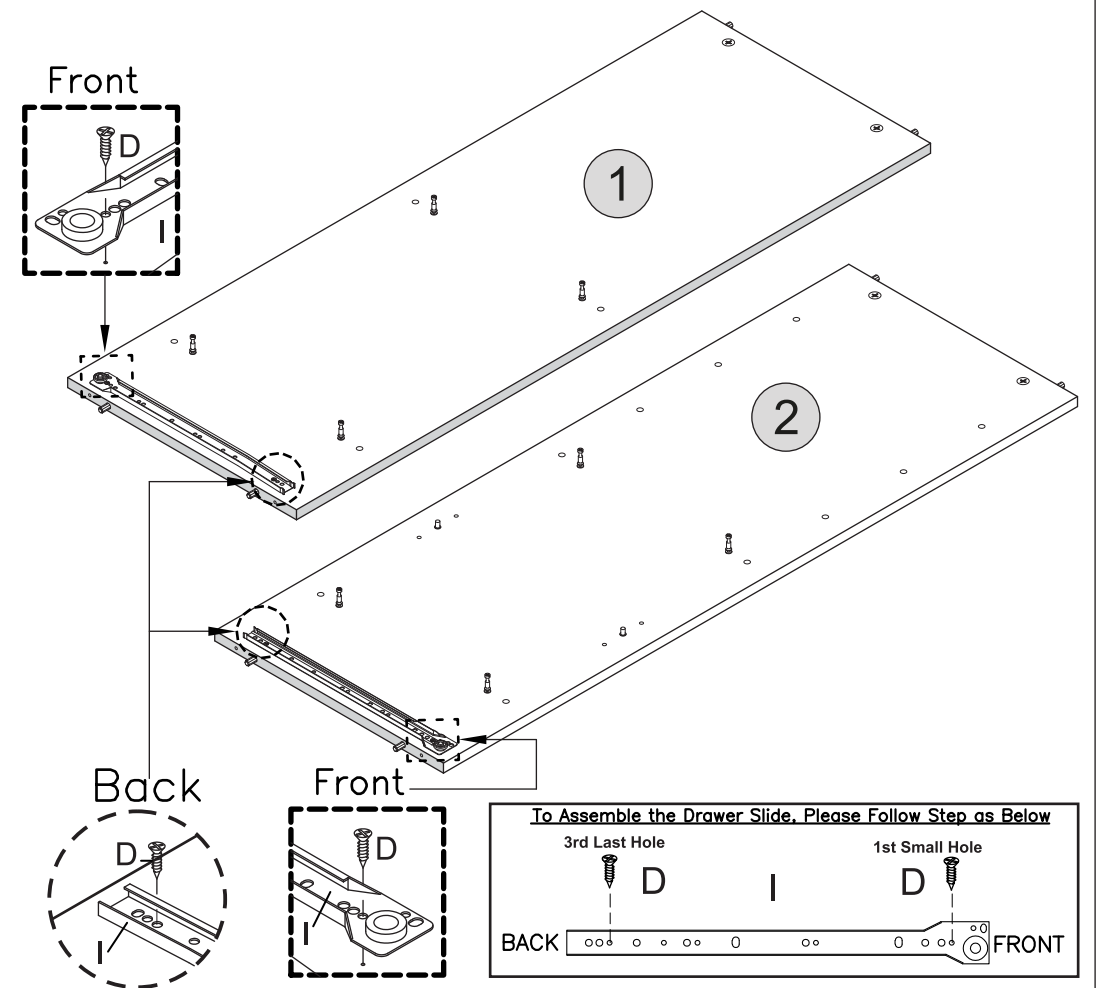
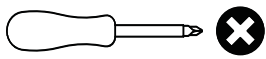

# STEP 3

## PARTS REQUIRED

13- TOP CENTRE PANEL (R) x1

14- TOP CENTRE PANEL (L) x1

## HARDWARE REQUIRED

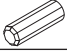
A  08

F  02

Q  01

## TOOLS REQUIRED

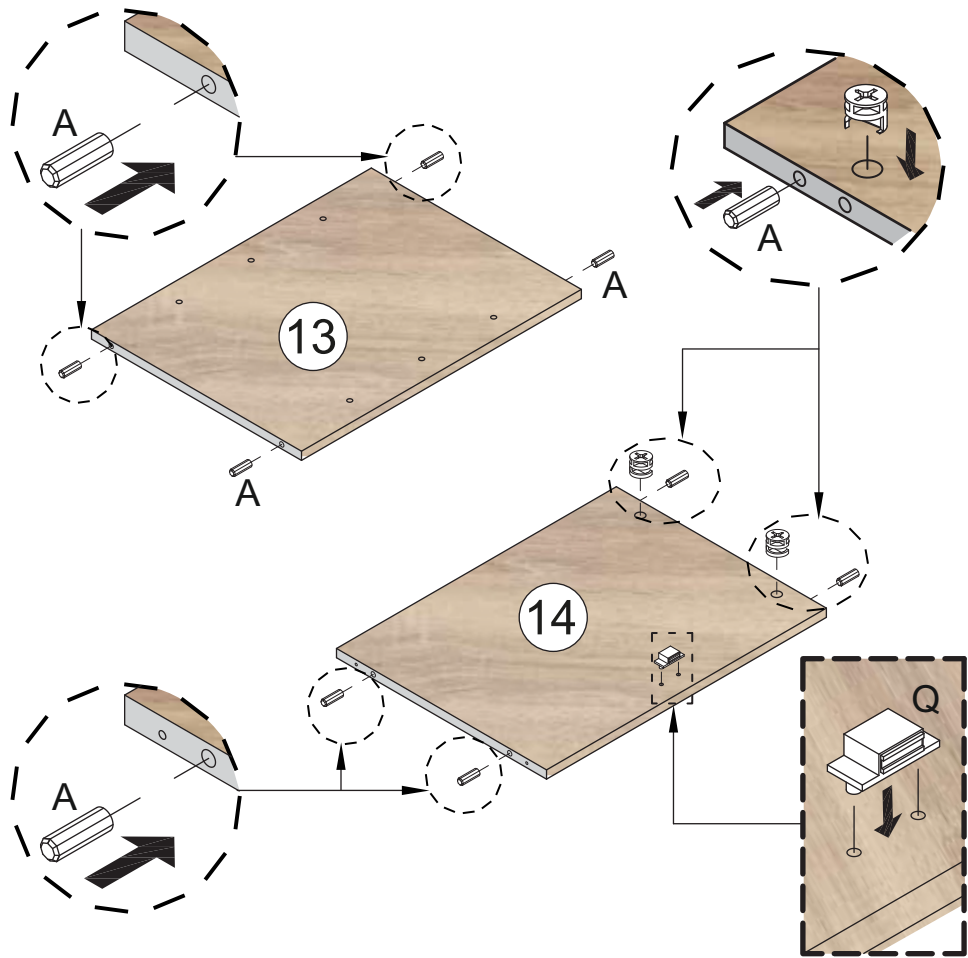

# STEP 4

## PARTS REQUIRED

10- BOTTOM SHELF PANEL (L) x1

11- BOTTOM SHELF PANEL (R) x1

15- SMALL SHELF PANEL x1

## HARDWARE REQUIRED

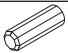
A  32

F  08

## TOOLS REQUIRED

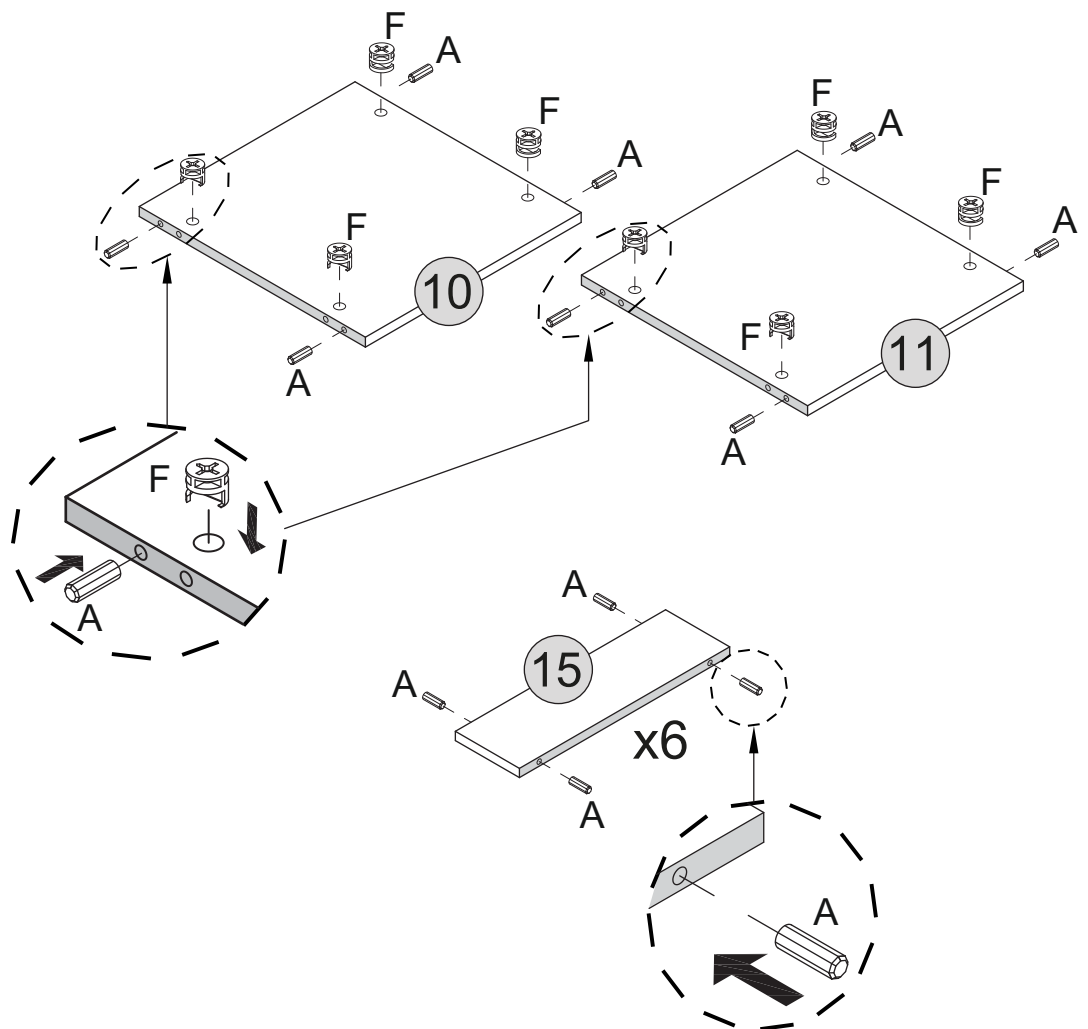

# STEP 5

## PARTS REQUIRED

5 - CENTRE SHELF PANEL x1

## HARDWARE REQUIRED

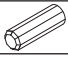

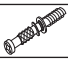

A  04

E  02

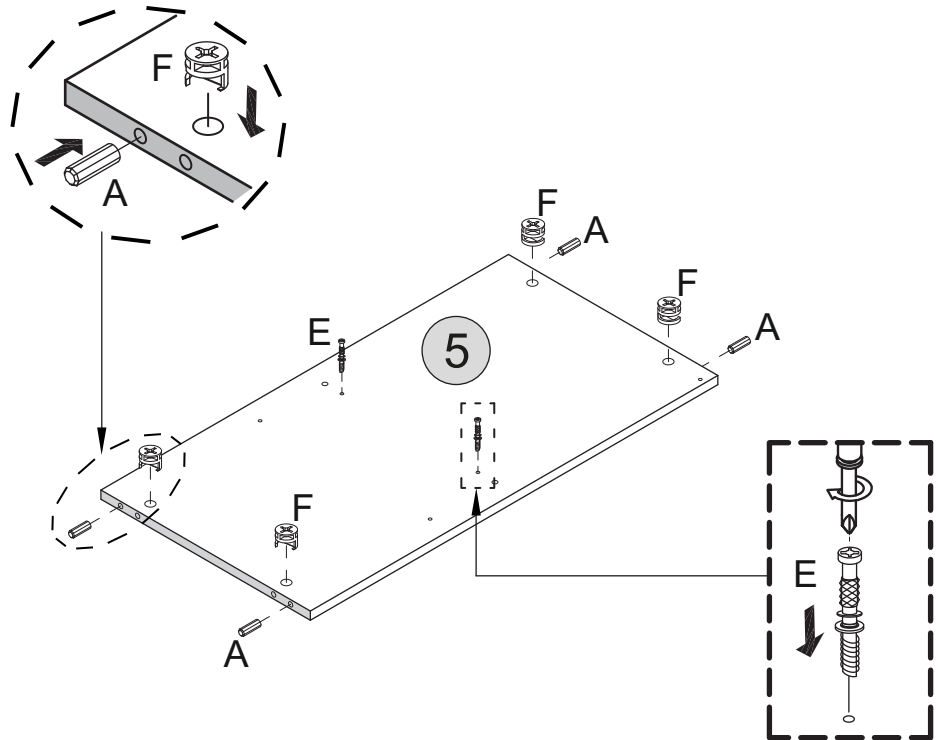
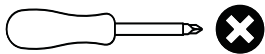
F  04

## TOOLS REQUIRED



<p><b>WHEN FITTING CAM STUD</b> ENSURE THE CAM STUD IS FULLY TIGHTEN IN</p> <p>✓   ✗</p> <p>CORRECT      WRONG</p>	<p><b>WHEN FITTING CAMS</b> ENSURE STARTING POSITION IS CORRECT BEFORE YOU INSERT CONNECTING BOLT TURN CLOCKWISE UNTIL SECURE</p> <p>✓  ✗  ✗  ✗</p> <p>CORRECT      WRONG</p>
--	---

# STEP 6

## PARTS REQUIRED

4 - TOP PANEL x1

## HARDWARE REQUIRED





D  04

E  06

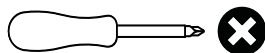
S  02

## TOOLS REQUIRED



<p><b>WHEN FITTING CAM STUD</b> ENSURE THE CAM STUD IS FULLY TIGHTEN IN</p> <p>✓   ✗</p> <p>CORRECT      WRONG</p>	<p><b>WHEN FITTING CAMS</b> ENSURE STARTING POSITION IS CORRECT BEFORE YOU INSERT CONNECTING BOLT TURN CLOCKWISE UNTIL SECURE</p> <p>✓  ✗  ✗  ✗</p> <p>CORRECT      WRONG</p>
--	--

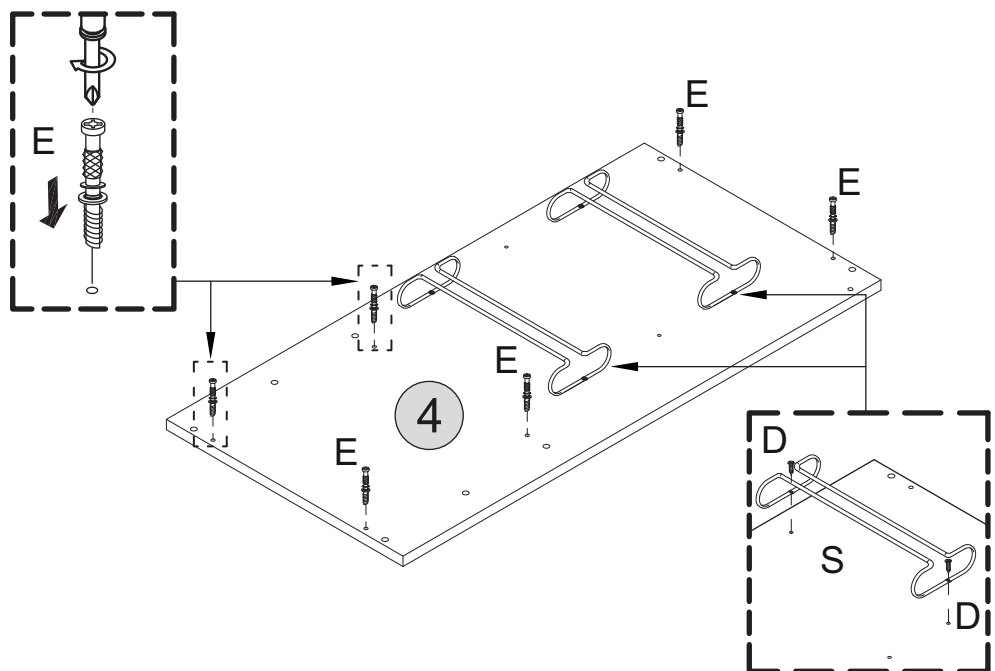



# STEP 9

## PARTS REQUIRED

16 - SMALL DOOR x1

17 - LARGE DOOR x1

## HARDWARE REQUIRED

D  02

K  01

M  01

R  02

T  04

## TOOLS REQUIRED

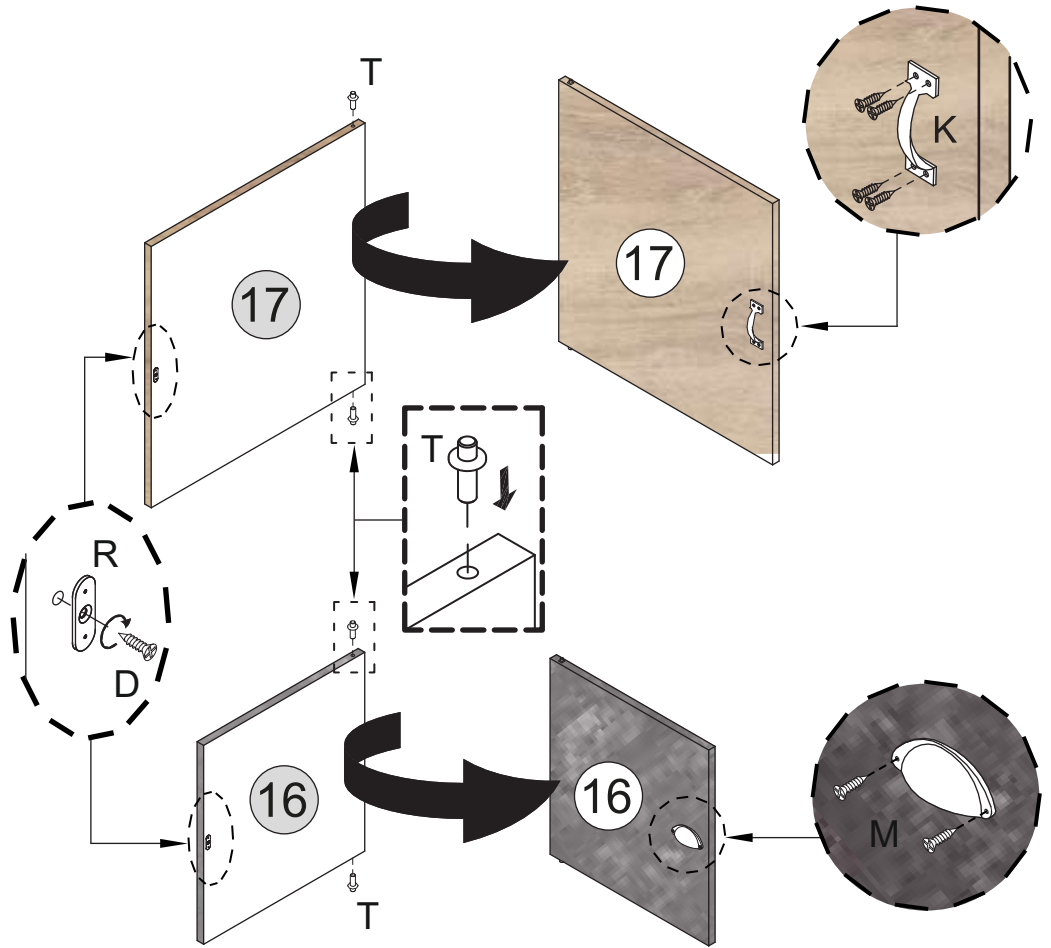
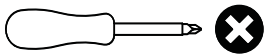

# STEP 10

## PARTS REQUIRED

13 - TOP CENTRE PANEL R x1

14 - TOP CENTRE PANEL L x1

15 - SMALL SHELF PANEL x6

## HARDWARE REQUIRED

## TOOLS REQUIRED

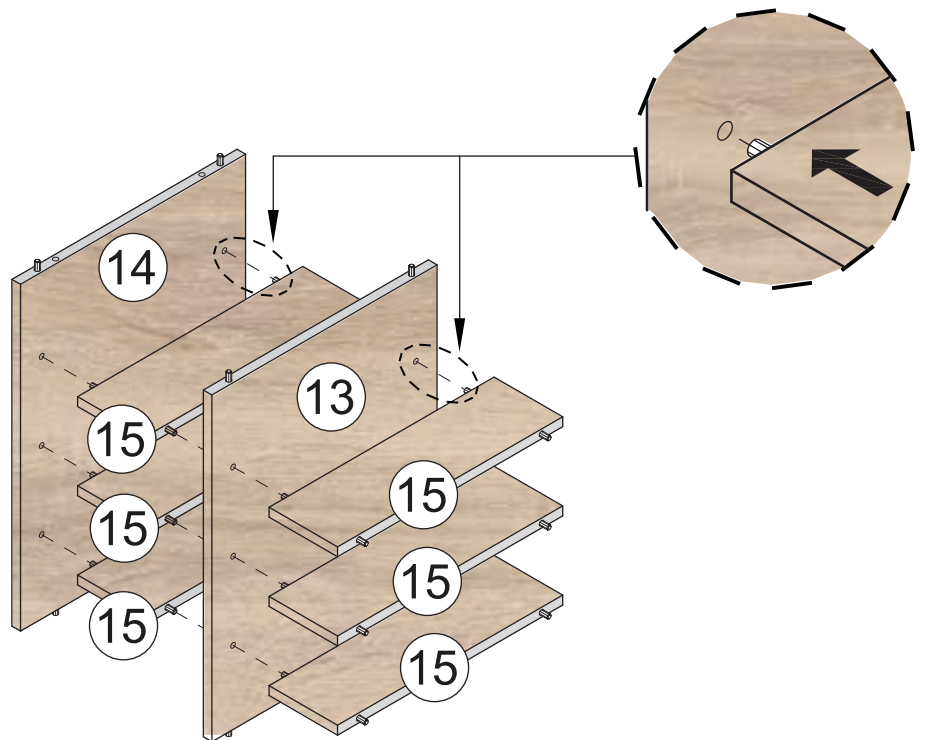



# STEP 11

## PARTS REQUIRED

5 - CENTRE SHELF PANEL x1

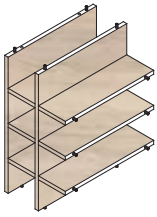

## HARDWARE REQUIRED

B  02

## TOOLS REQUIRED

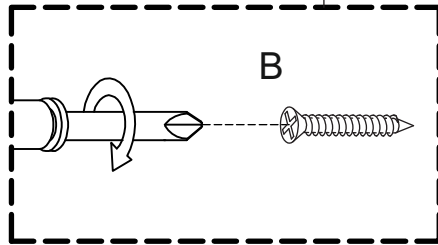
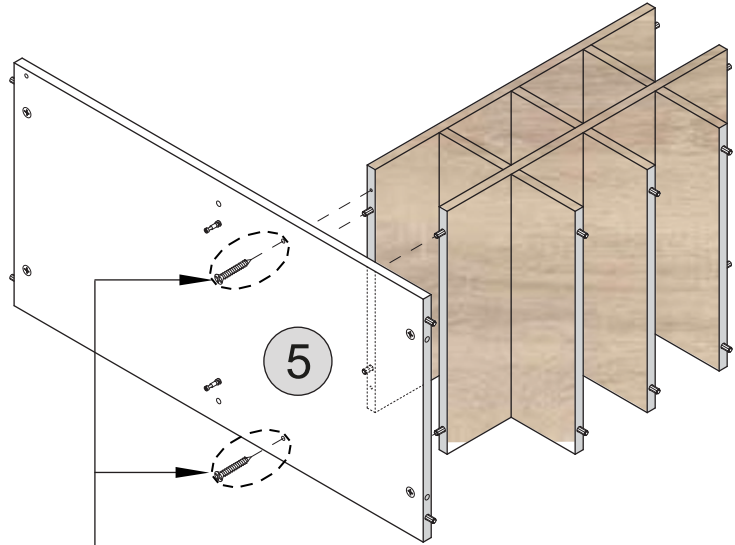
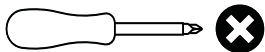

# STEP 12

## PARTS REQUIRED

3 - BOTTOM CENTRE PANEL x1

10 - BOTTOM SHELF PANEL (L) x1

11 - BOTTOM SHELF PANEL (R) x1

## HARDWARE REQUIRED

G  02

## TOOLS REQUIRED

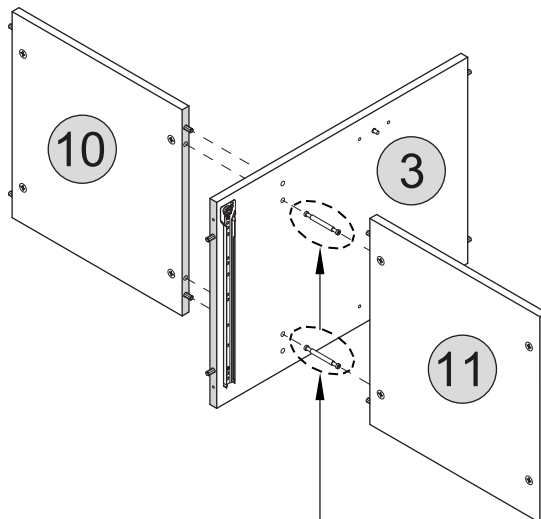
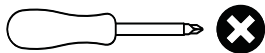

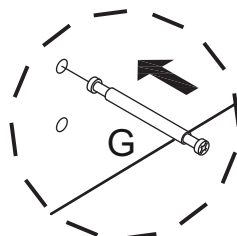

**1st STEP**

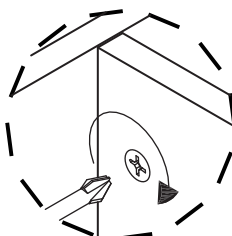

**2nd STEP**



**WHEN FITTING CAMS**  
ENSURE STARTING POSITION IS CORRECT  
BEFORE YOU INSERT CONNECTING BOLT  
TURN CLOCKWISE UNTIL SECURE

✓ 			✗
↑ CORRECT	↑ WRONG	↑ WRONG	

# STEP 13

## PARTS REQUIRED

16 - SMALL DOOR x1

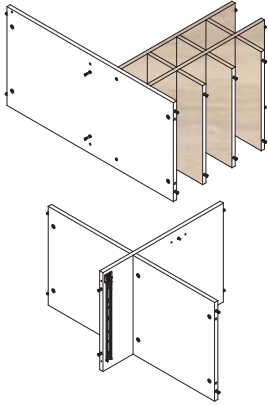

## HARDWARE REQUIRED

### TOOLS REQUIRED

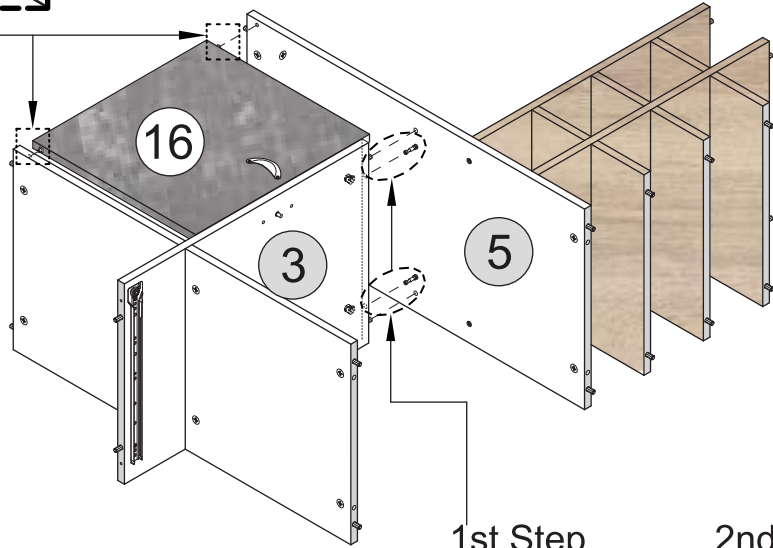
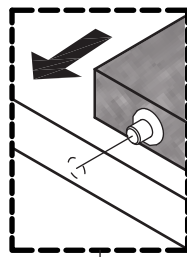
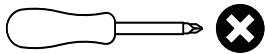

1st Step

2nd Step

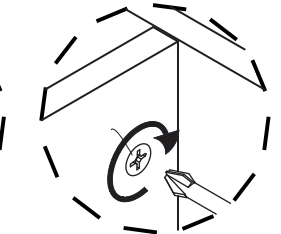
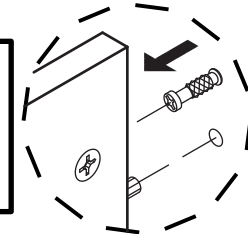
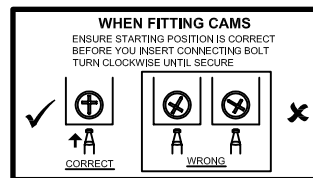

# STEP 14

## PARTS REQUIRED

1 - LEFT SIDE PANEL x1

2 - RIGHT SIDE PANEL x1

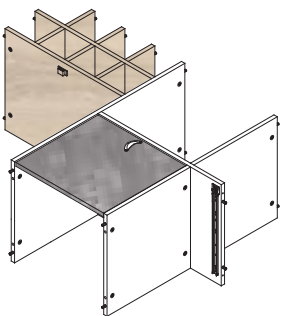

## TOOLS REQUIRED

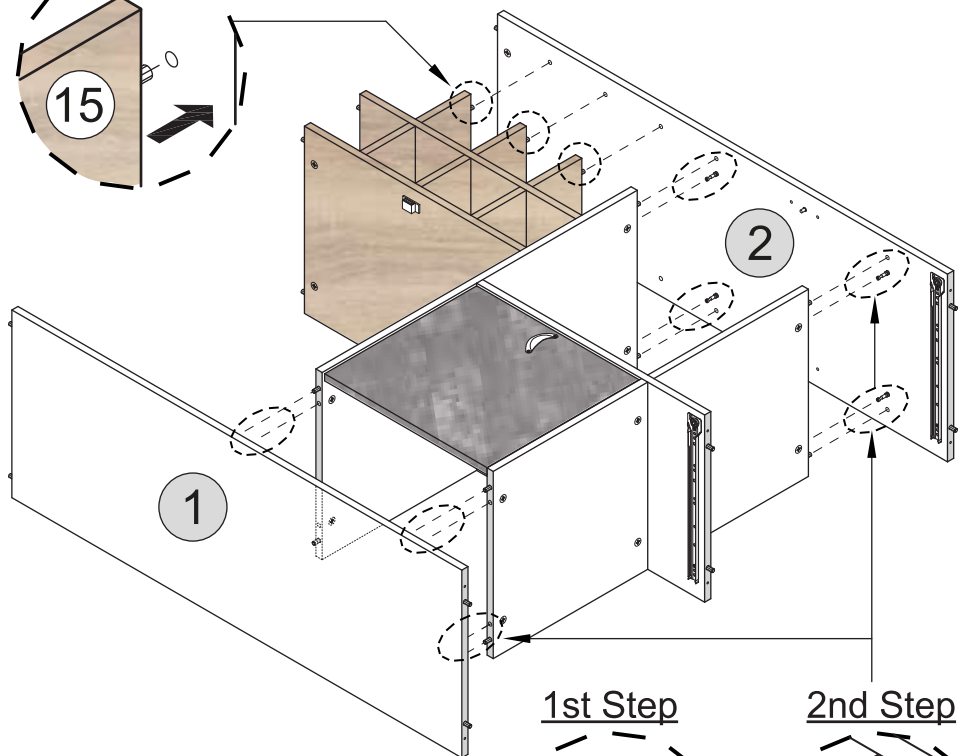
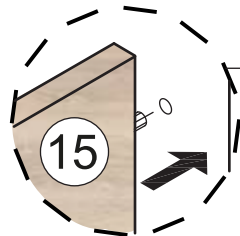
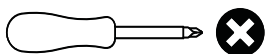

1st Step

2nd Step

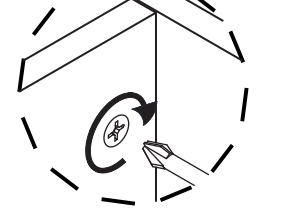
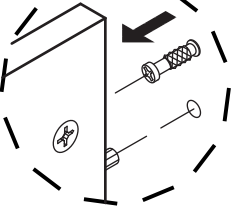
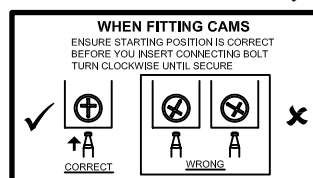

# STEP 15

PARTS REQUIRED

- 4 - TOP PANEL x1
- 17 - LARGE DOOR x1

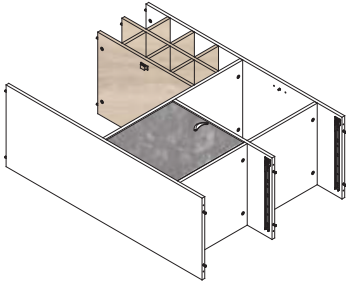

TOOLS REQUIRED

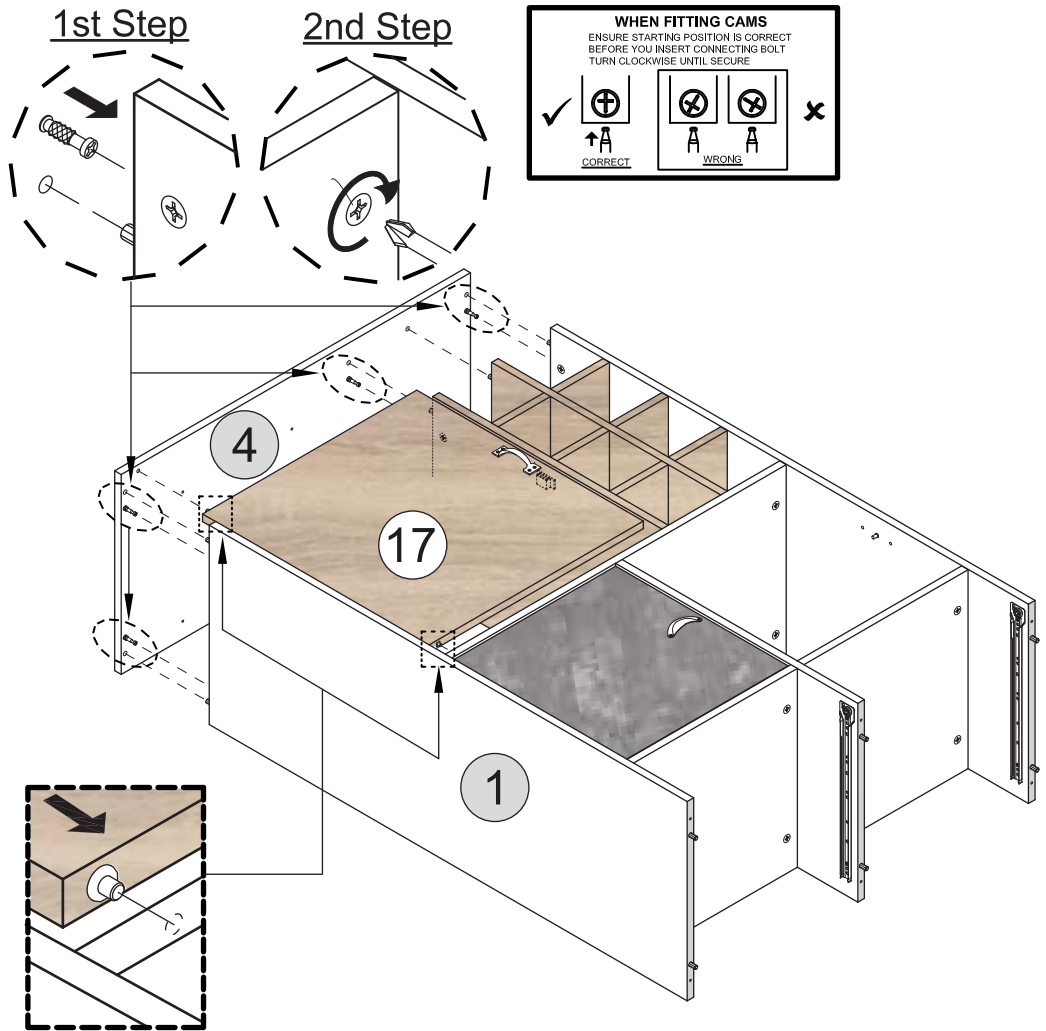
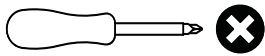



# STEP 16

PARTS REQUIRED

- 9 - BOTTOM PANEL x1

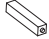
HARDWARE REQUIRED

- P  01
- U  01

TOOLS REQUIRED

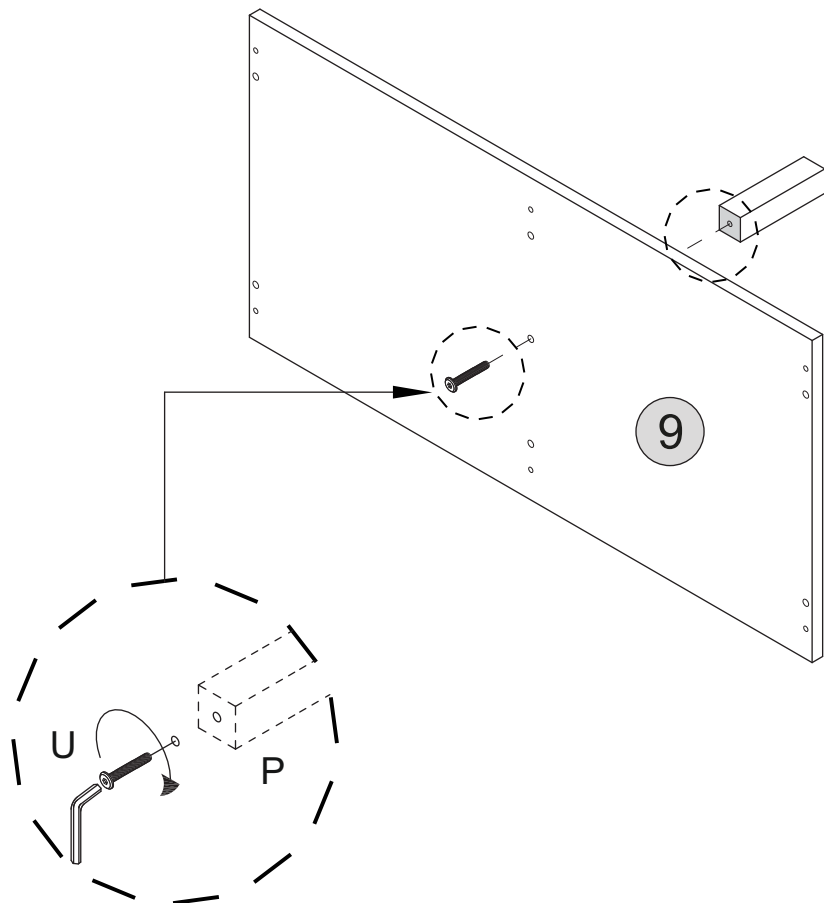

# STEP 17

PARTS REQUIRED

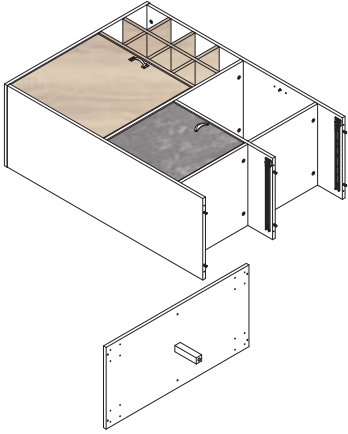

HARDWARE REQUIRED



TOOLS REQUIRED

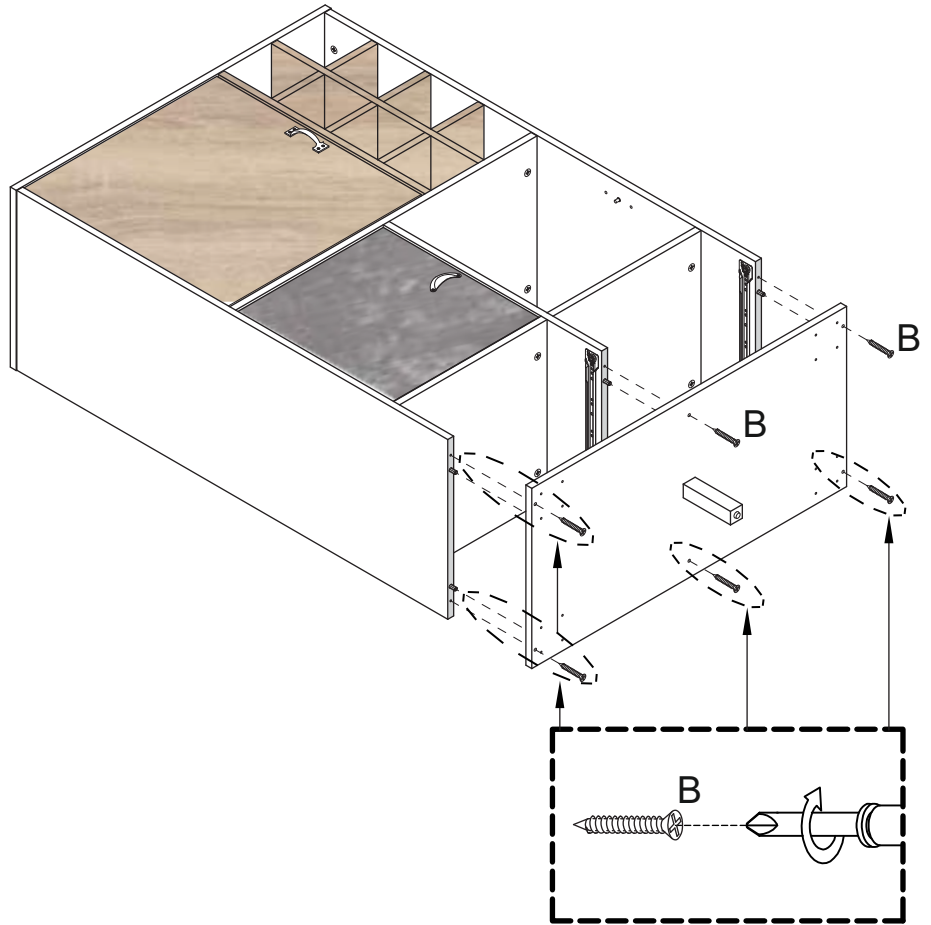
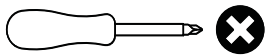

# STEP 18

PARTS REQUIRED

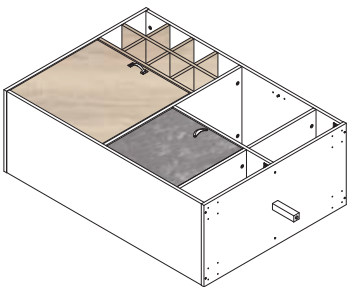

HARDWARE REQUIRED

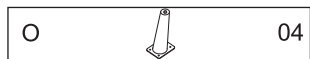

TOOLS REQUIRED

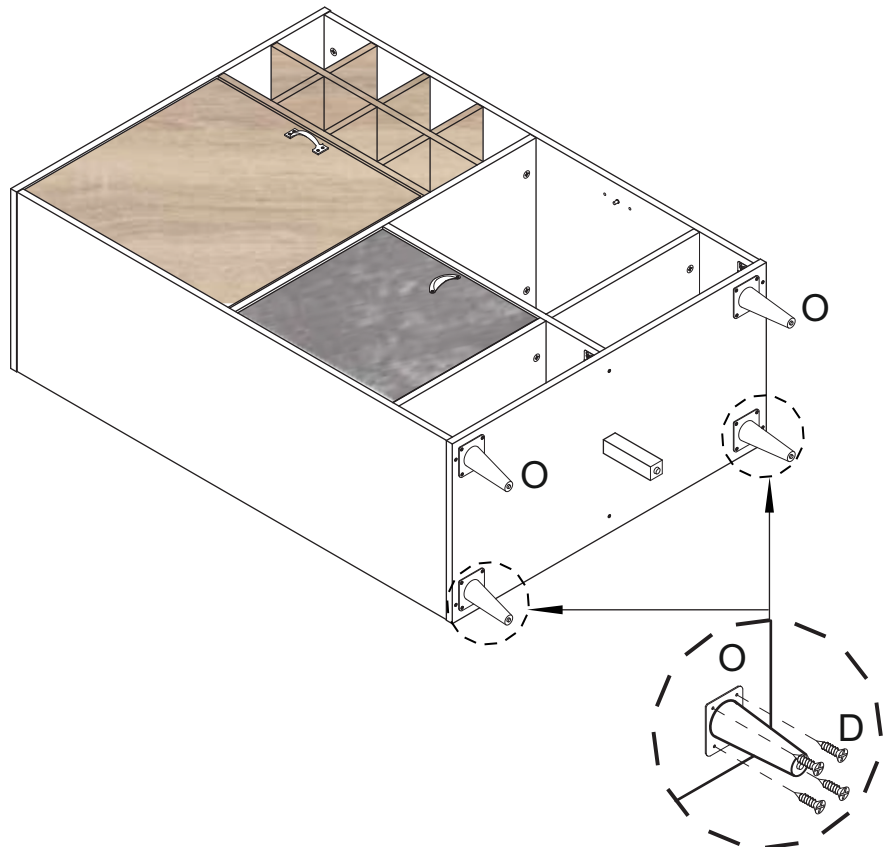
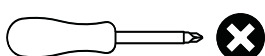

# STEP 19

## PARTS REQUIRED

21 - BACK PANEL x2

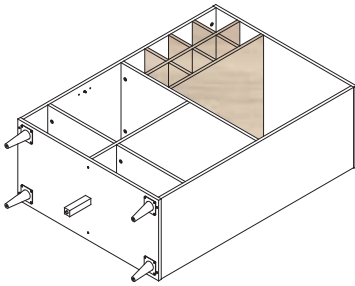

## HARDWARE REQUIRED

J  50

## TOOLS REQUIRED

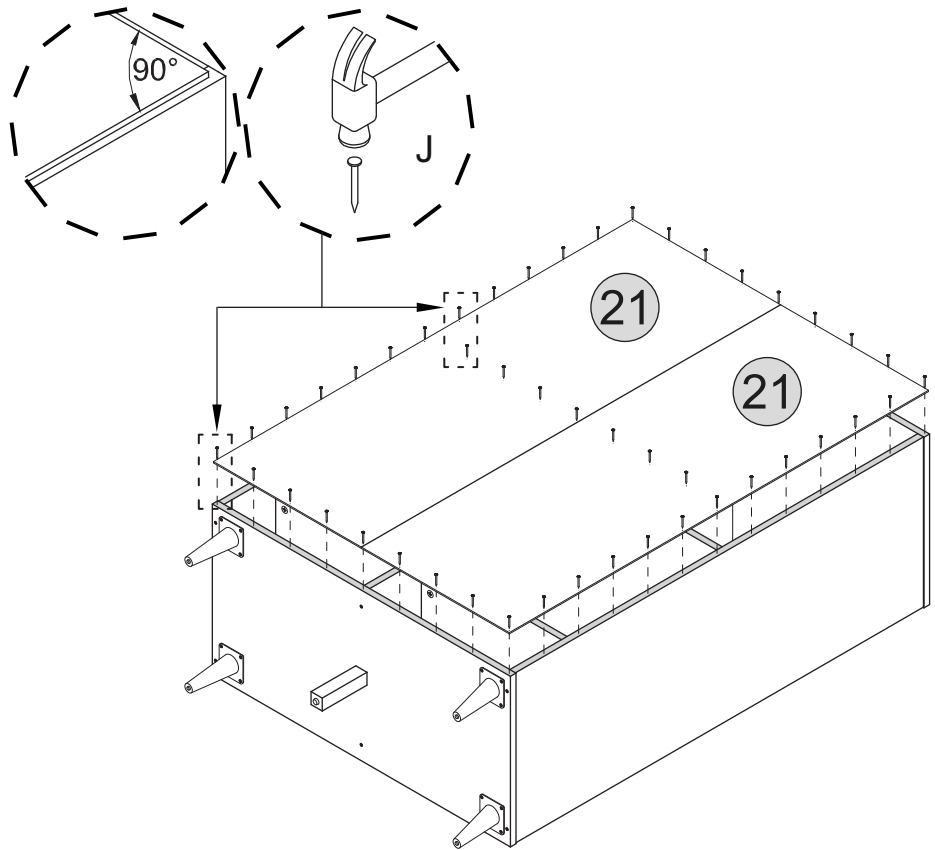
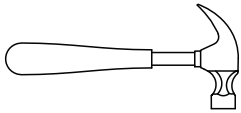

# STEP 20

## PARTS REQUIRED

7 - LEFT DRAWER SIDE x2

8 - RIGHT DRAWER SIDE x2

18 - LEFT DRAWER FRONT x1

19 - RIGHT DRAWER FRONT x1

## HARDWARE REQUIRED

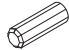
A  04

E  04

F  04

## TOOLS REQUIRED

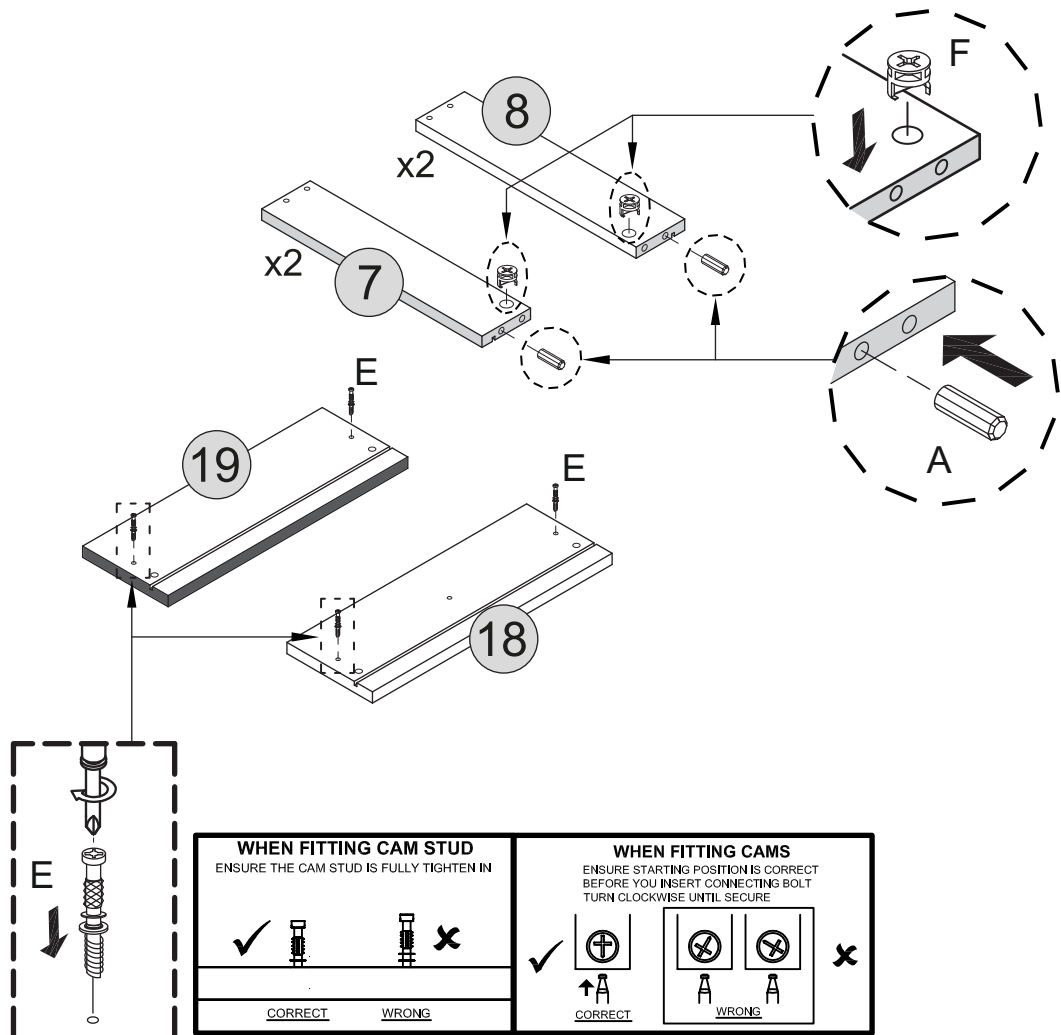
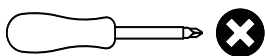

# STEP 21

## PARTS REQUIRED

- 7 - LEFT DRAWER SIDE x1
- 8 - RIGHT DRAWER SIDE x1
- 12 - DRAWER BACK x1
- 19 - RIGHT DRAWER FRONT x1
- 20 - DRAWER BASE x1

## HARDWARE REQUIRED

- C  04

## TOOLS REQUIRED

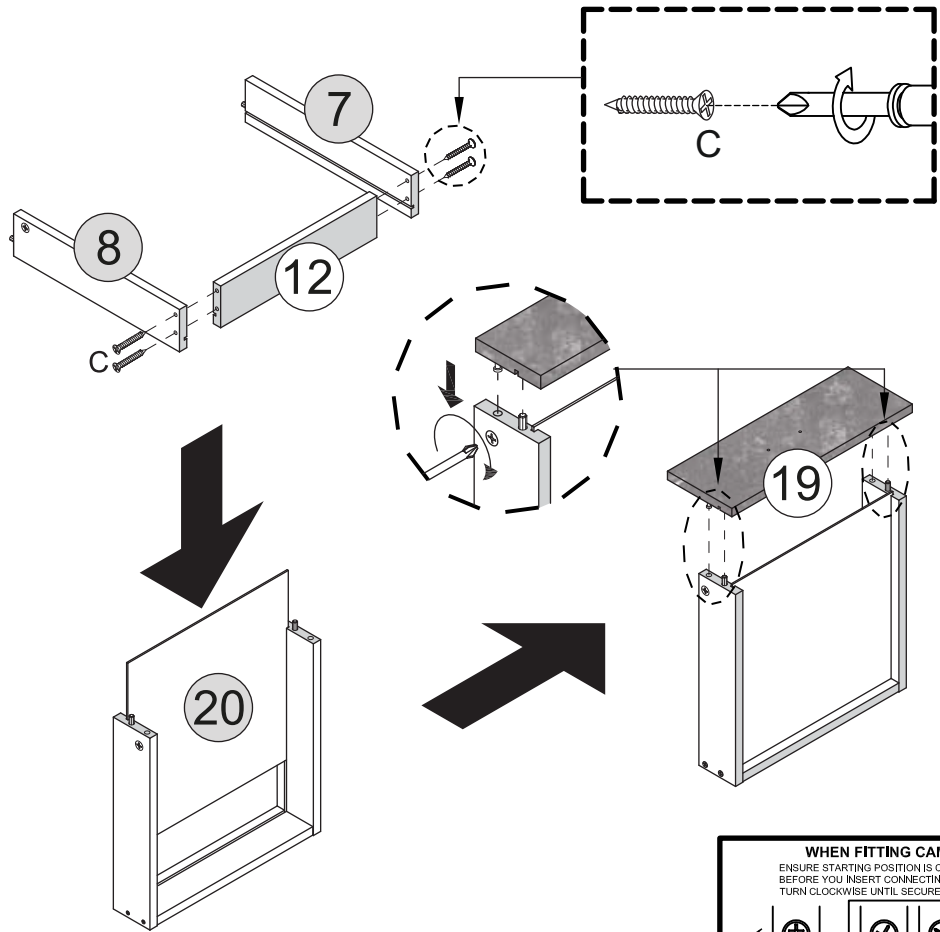
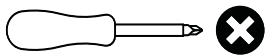

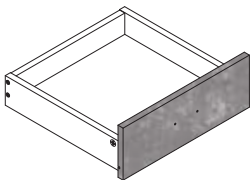

# STEP 22

## PARTS REQUIRED



## HARDWARE REQUIRED

- D  04
- I  01
- M  01

## TOOLS REQUIRED

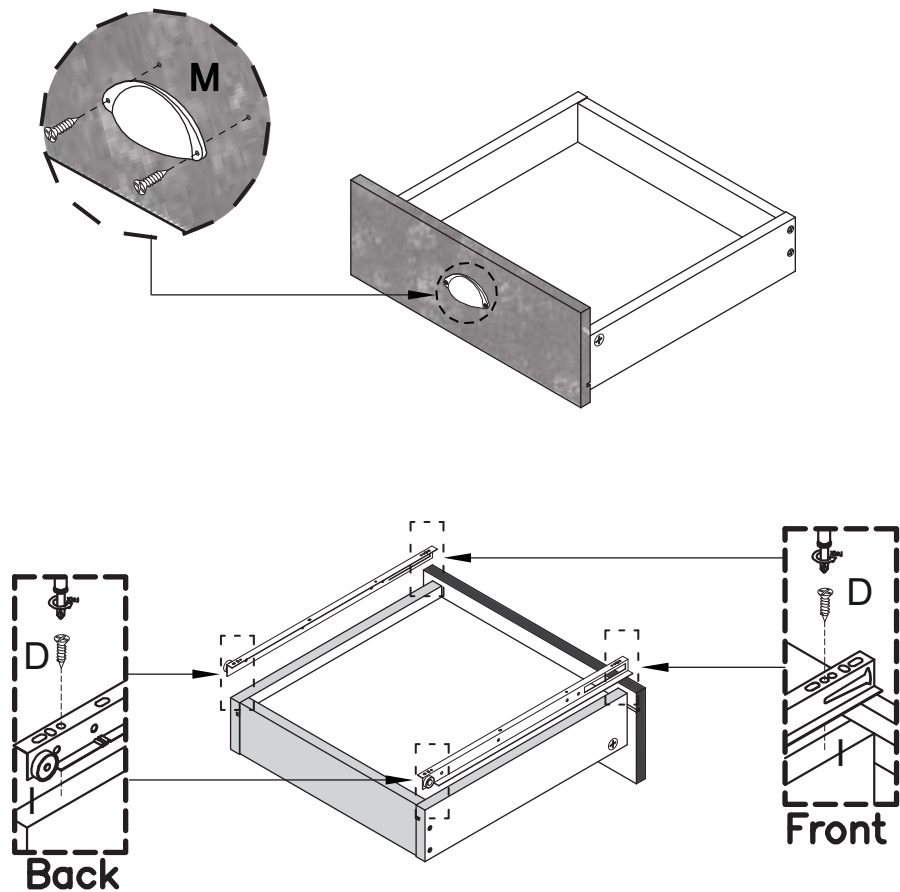
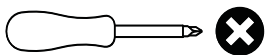

# STEP 23

## PARTS REQUIRED

7 - LEFT DRAWER SIDE x1

8 - RIGHT DRAWER SIDE x1

12 - DRAWER BACK x1

18 - LEFT DRAWER FRONT x1

20 - DRAWER BASE x1

## HARDWARE REQUIRED

C  04

## TOOLS REQUIRED

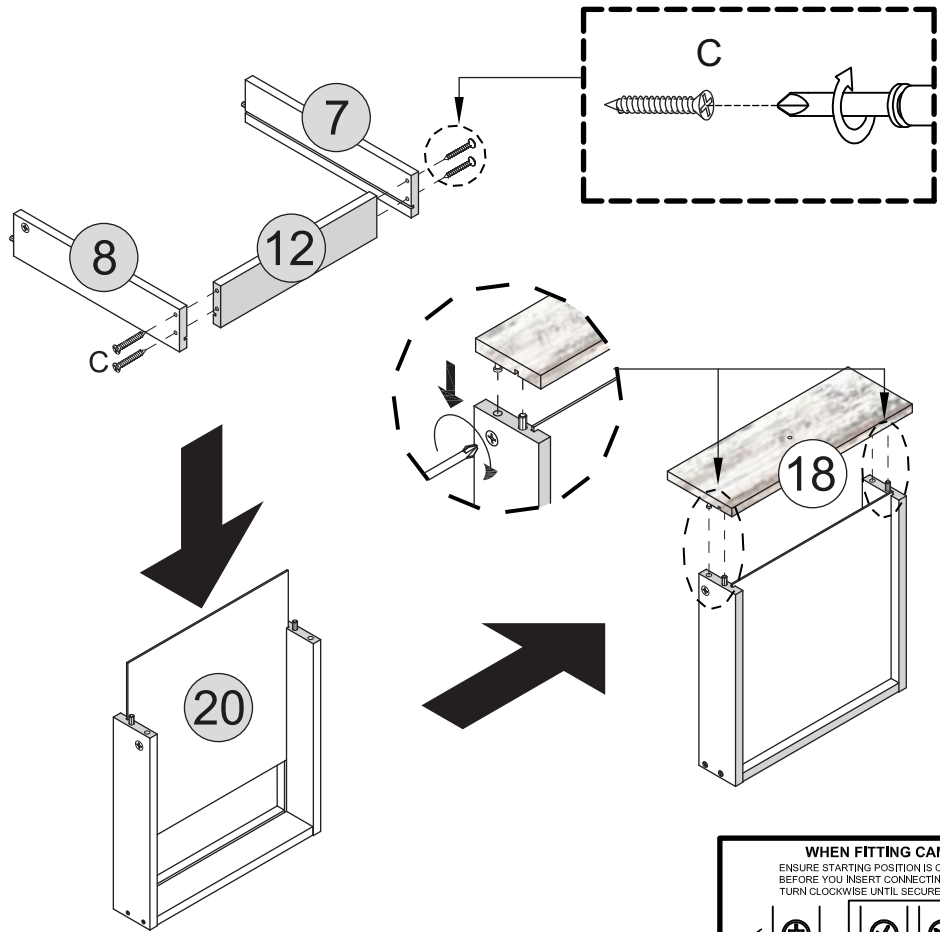
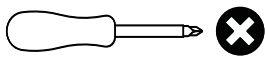

# STEP 24

## PARTS REQUIRED

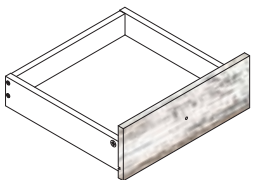

## HARDWARE REQUIRED

D  04

I  01

K  01

## TOOLS REQUIRED

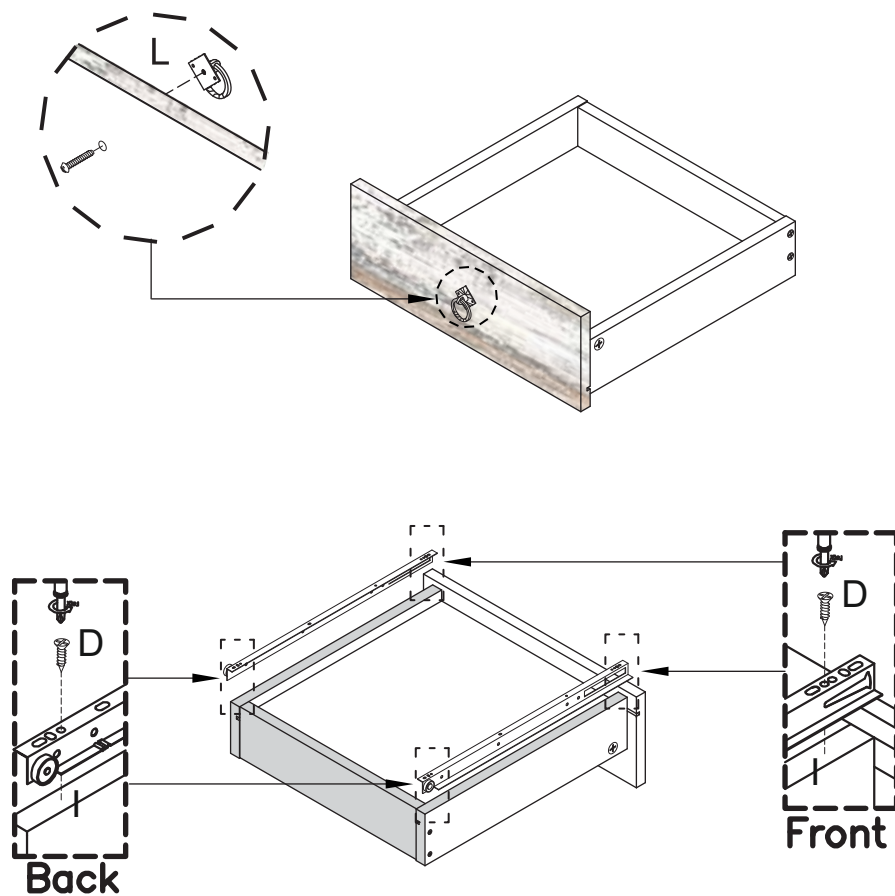
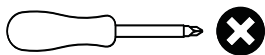

# STEP 25

PARTS REQUIRED

6 - SHELF PANEL x1

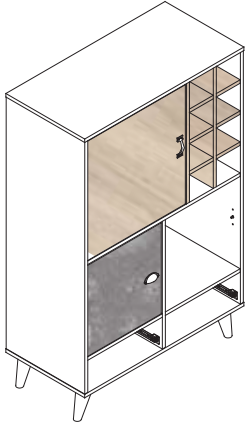

HARDWARE REQUIRED

TOOLS REQUIRED

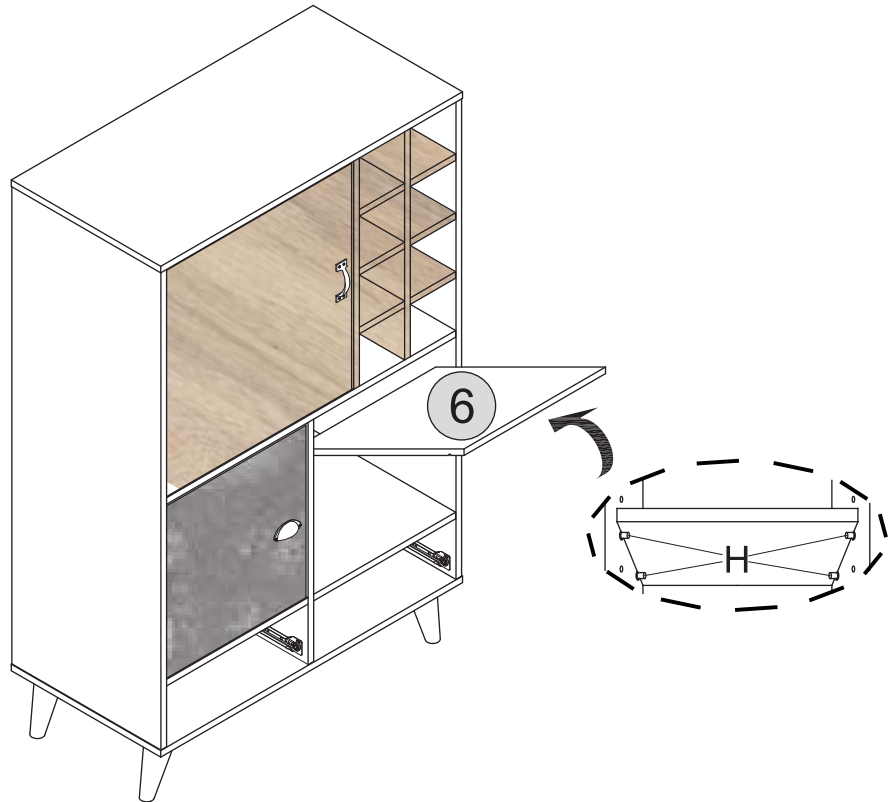

# STEP 26

PARTS REQUIRED



HARDWARE REQUIRED

TOOLS REQUIRED

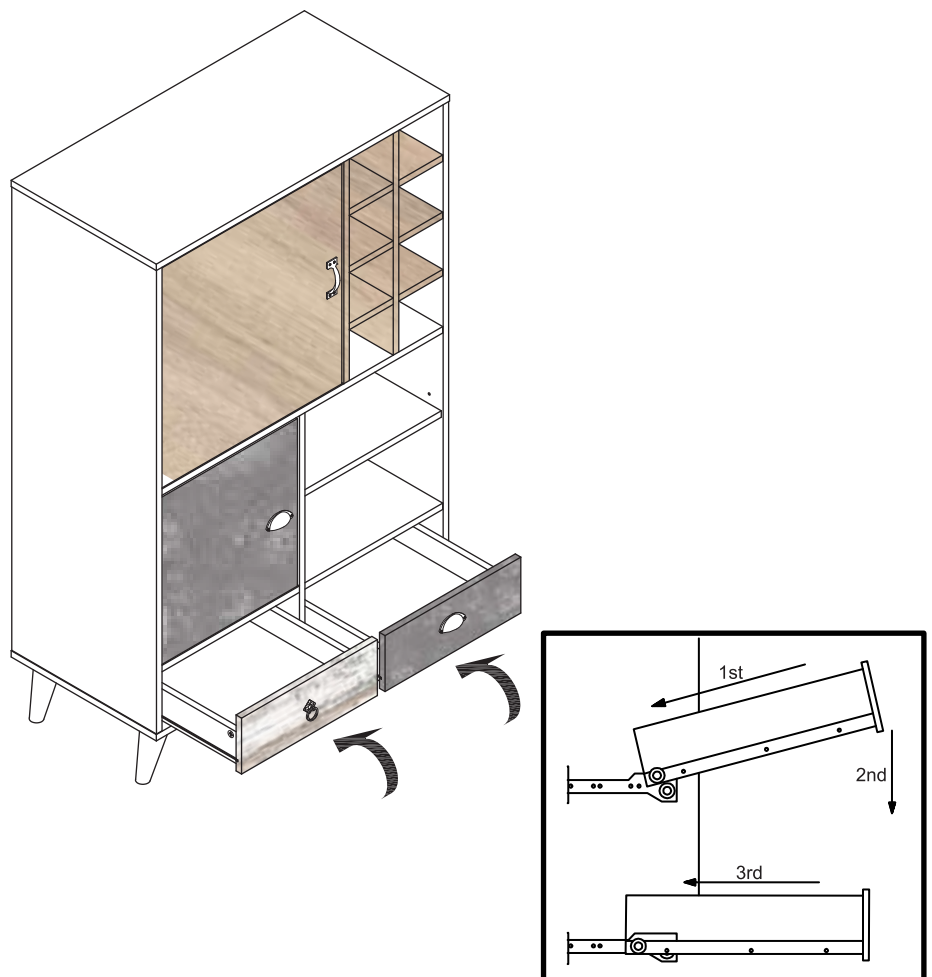



# STEP 27

## PARTS REQUIRED

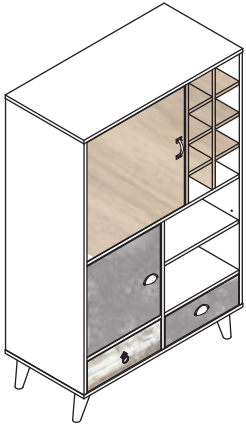

## HARDWARE REQUIRED



## TOOLS REQUIRED

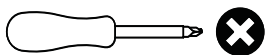

# WARNING

**Serious or fatal injuries can occur from furniture tipping over. To prevent the furniture from tipping over we recommend that it is permanently fixed to the wall.**

Wall fixings are not supplied with this product as different wall materials require different types of fixing devices. Please make sure you use fixings suitable for the walls in your home.

